

When recorded mail to:

City Clerk's Office  
City of Riverside  
City Hall, 3900 Main Street  
Riverside, California 92522

**DOC # 2000-448933**

11/09/2000 08:00A Fee:NC

Page 1 of 5

Recorded in Official Records

County of Riverside

Gary L. Orso

Assessor, County Clerk & Recorder



**FREE RECORDING**

This instrument is for the benefit of the City of Riverside and is entitled to be recorded without fee (Government Code §6103)

M	S	U	PAGE	SIZE	DA	PCOR	NOCOR	SMF	MISC.
	1		5						
								✓	LC
A	R	L			COPY	LONG	REFUND	NCHG	EXAM

FOR RECORDER'S OFFICE USE ONLY

Project: BP 11545 Doverwood Drive

D - 14620

C  
LC

**GRANT OF EASEMENT**

ANITA BACILIO, a married woman as her sole and separate property, as Grantor, FOR VALUABLE CONSIDERATION, receipt of which is hereby acknowledged, does hereby grant to the CITY OF RIVERSIDE, a municipal corporation of the State of California, as Grantee, its successors and assigns, an easement and right-of-way for public street and highway purposes, together with all rights to construct and maintain utilities, sewers, drains and other improvements consistent with the use as a public street and highway, in, under, upon, over and along that certain real property as described in EXHIBIT A attached hereto and incorporated herein by this reference, located in the City of Riverside, County of Riverside, State of California.

Dated Oct. 17, 2000

Anita Bacilio AKA  
ANITA BACILIO

Anita J. Henriquez-Gil  
ANITA J. HENRIQUEZ - GIL

APPROVED AS TO FORM  
[Signature]  
ASSISTANT ATTORNEY  
BP 11545DOVERWOOD.DOC

GENERAL ACKNOWLEDGEMENT

State of California }  
County of Riverside } ss

On Oct. 17, 2000, before me Lori Flores  
(date) (name)

a Notary Public in and for said State, personally appeared

Anita Bacilio  
Name(s) of Signer(s)

personally known to me - OR -  proved to me on the basis of satisfactory evidence to be the person(s) whose name(s) ~~is~~ are subscribed to the within instrument and acknowledged to me that ~~he~~ ~~she~~ they executed the same in ~~his~~ ~~her~~ their authorized capacity~~(ies)~~, and that by ~~his~~ ~~her~~ their signature~~(s)~~ on the instrument the person~~(s)~~, or the entity upon behalf of which the person~~(s)~~ acted, executed the instrument.



WITNESS my hand and official seal.

Lori Flores  
Signature

OPTIONAL SECTION

CAPACITY CLAIMED BY SIGNER

( ) Attorney-in-fact  
( ) Corporate Officer(s)  
Title \_\_\_\_\_  
Title \_\_\_\_\_

( ) Guardian/Conservator  
( ) Individual(s)  
( ) Trustee(s)  
( ) Other  
\_\_\_\_\_  
\_\_\_\_\_

( ) Partner(s)  
( ) General  
( ) Limited

The party(ies) executing this document is/are representing:  
\_\_\_\_\_  
\_\_\_\_\_  
\_\_\_\_\_

CERTIFICATE OF ACCEPTANCE  
(Government Code Section §27281)

THIS IS TO CERTIFY that the interest in real property conveyed by the within instrument to the City of Riverside, California, a municipal corporation, is hereby accepted by the undersigned officer on behalf of the City Council of said City pursuant to authority conferred by Resolution No. 18233 of said City Council adopted May 11, 1993, and the grantee consents to recordation thereof by its duly authorized officer.

Dated 10/18/00

CITY OF RIVERSIDE

[Signature]  
Real Property Services Manager  
of the City of Riverside



2000-448933  
11/03/2000 08:00A  
2 of 5

EXHIBIT A  
PUBLIC STREET AND HIGHWAY EASEMENT  
BP 11545 DOVERWOOD DRIVE

IN THE CITY OF RIVERSIDE, COUNTY OF RIVERSIDE, STATE OF CALIFORNIA DESCRIBED AS FOLLOWS:

THE SOUTHEASTERLY 10.00 FEET OF THE FOLLOWING DESCRIBED PARCEL OF LAND:

ALL THAT PORTION OF LOT 6, BLOCK 61, OF TRACT NO. 2 OF LA SIERRA HEIGHTS, AS SHOWN BY MAP ON FILE IN MAP BOOK 7 PAGE 66 THEREOF, RECORDS OF SAID COUNTY PARTICULARLY DESCRIBED AS:

BEGINNING AT A POINT ON THE NORTHWESTERLY LINE OF SAID LOT WHICH BEARS NORTH 62°42'45 EAST, 255 FEET FROM THE MOST WESTERLY CORNER OF SAID LOT;

THENCE SOUTH 24°30'15" EAST, PARALLEL WITH THE SOUTHWESTERLY LINE OF SAID LOT, 160.30 FEET TO THE NORTHWESTERLY LINE OF THAT CERTAIN PARCEL OF LAND GRANTED TO THE COUNTY OF RIVERSIDE BY DEED RECORDED DECEMBER 9, 1947, IN BOOK 876, PAGE 405 OF OFFICIAL RECORDS OF SAID COUNTY;

THENCE NORTH 62°42'45' EAST ALONG THE NORTHWESTERLY LINE OF SAID PARCEL OF LAND GRANTED TO THE COUNTY OF RIVERSIDE AND PARALLEL WITH THE NORTHWESTERLY LINE OF SAID LOT, 100 FEET TO A POINT ON THE SOUTHWESTERLY LINE OF THAT CERTAIN PARCEL OF LAND GRANTED TO RANSOME J. BROWN AND JOSEPHINE BROWN, HIS WIFE, BY DEED RECORDED JUNE 10, 1947 IN BOOK 838 PAGE 303 OF OFFICIAL RECORDS OF SAID COUNTY;

THENCE NORTH 24°30'15" WEST ALONG SAID SOUTHWESTERLY LINE, 160.3 FEET TO A POINT ON THE NORTHWESTERLY LINE OF SAID LOT;

THENCE SOUTH 62°42'45" WEST , ALONG SAID NORTHWESTERLY LINE, 100 FEET TO THE POINT OF BEGINNING

CONTAINING 1,000 SQUARE FEET, MORE OR LESS.

This description was prepared by me or under my direction in conformance with the requirements of the Land Surveyors Act.

  
Mark S. Brown, L.S. 5655      8/15/00      Date      Prep.      *MSB*  
License Expires 9/30/03



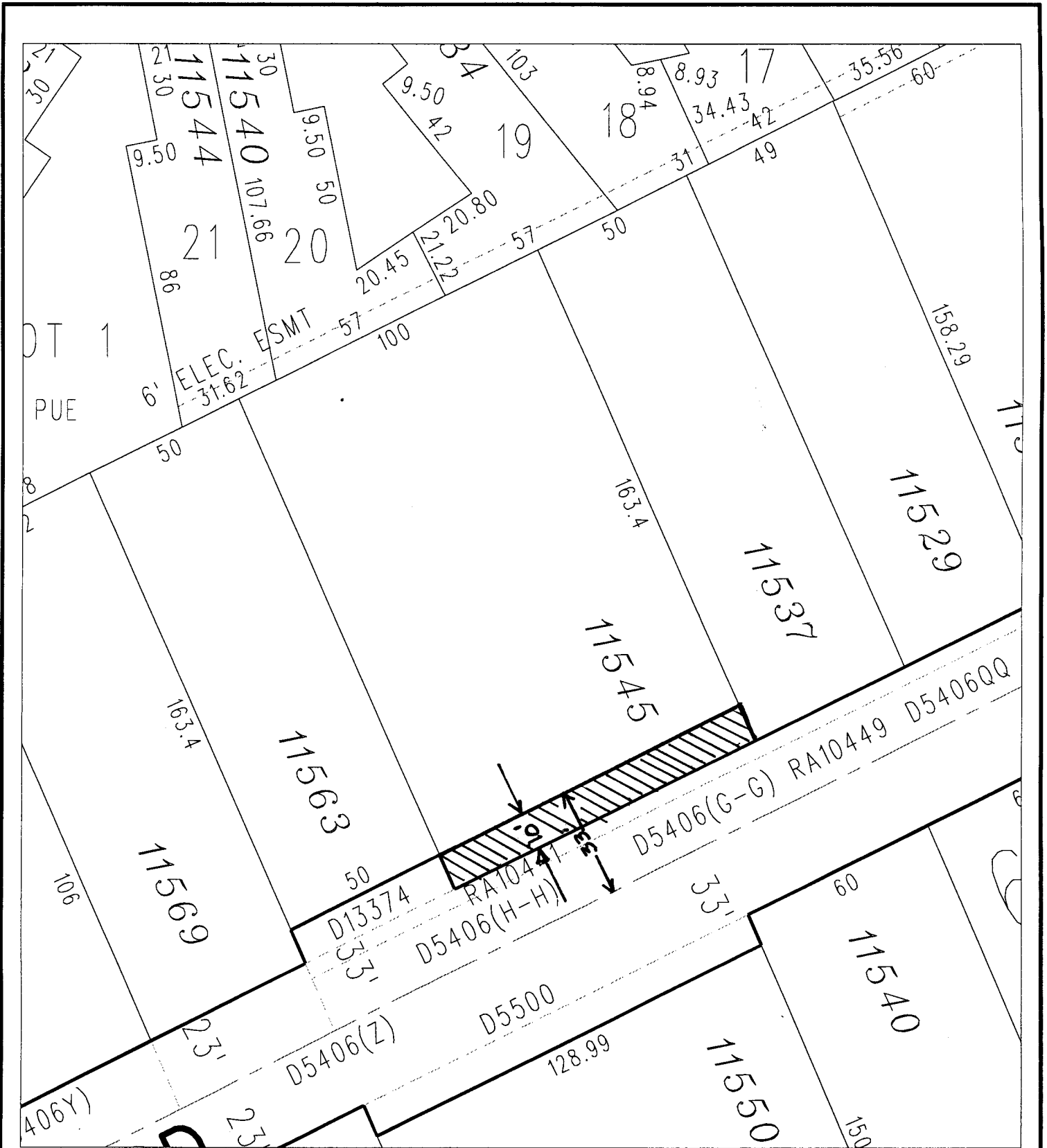

◆ CITY OF RIVERSIDE, CALIFORNIA ◆

THIS PLAT IS SOLELY AN AID IN LOCATING THE PARCEL(S) DESCRIBED IN THE ATTACHED DOCUMENT. IT IS NOT A PART OF THE WRITTEN DESCRIPTION THEREIN.

Sheet 1 of 1 

Scale: 1" = 40'	Drawn by: bmark	Date: 08/11/00	Subject: BP 11545 Doverwood	63.7
-----------------	-----------------	----------------	-----------------------------	------