

When recorded mail to:

City Clerk's Office  
City of Riverside  
City Hall, 3900 Main Street  
Riverside, California 92522

DOC # 2001-186719

05/01/2001 08:00A Fee:NC

Page 1 of 5

Recorded in Official Records

County of Riverside

Gary L. Orso

Assessor, County Clerk & Recorder

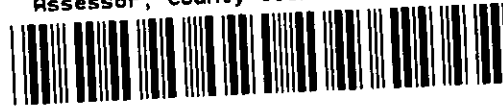

FREE RECORDING

This instrument is for the benefit of the City of Riverside and is entitled to be recorded without fee (Government Code §6103)

M	S	U	PAGE	SIZE	DA	PCOR	NOCOR	SMF	MISC.	
			5							
								✓	AS	
A	R	L				COPY	LONG	REFUND	NCHG	EXAM

Ø

Project: 7634 Freda Street  
Building Permit  
A.P.N. 230-283-022



D - 14702

GRANT OF EASEMENT

ROMAN YANEZ, a single man, as to an undivided one half interest, and JOSEFINA MENDEZ, a single woman, as to an undivided one half interest, as tenants in common, do hereby grant to the City of Riverside, a municipal corporation of the State of California, as Grantee, its successors and assigns, an easement and right-of-way for **public street and highway purposes**, together with all rights to construct and maintain utilities, sewers, drains and other improvements consistent with the use as **a public street and highway**, in, under, upon, over and along that certain real property as described in **Exhibit "A"** attached hereto and incorporated herein by this reference, located in the City of Riverside, County of Riverside, State of California.

Dated February 26, 2001

Roman Yanez  
ROMAN YANEZ

Josefina Mendez  
JOSEFINA MENDEZ

**GENERAL ACKNOWLEDGEMENT**

State of California  
County of Los Angeles }<sup>ss</sup>

On February 26, 2001 before me Celia Fernandez, Notary Public  
(date) (name)

a Notary Public in and for said State, personally appeared

\* Roman Yanez Josefina Mendez  
Name(s) of Signer(s)

personally known to me - OR -  proved to me on the basis of satisfactory evidence to be the person(s) whose name(s) is/are subscribed to the within instrument and acknowledged to me that he/she/they executed the same in his/her/their authorized capacity(ies), and that by his/her/their signature(s) on the instrument the person(s), or the entity upon behalf of which the person(s) acted, executed the instrument.

WITNESS my hand and official seal.

Celia Fernandez  
Signature

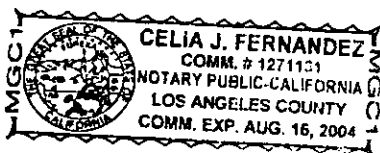

**OPTIONAL SECTION**

**CAPACITY CLAIMED BY SIGNER**

( ) Attorney-in-fact  
( ) Corporate Officer(s)  
Title \_\_\_\_\_  
Title \_\_\_\_\_

( ) Guardian/Conservator  
( ) Individual(s)  
( ) Trustee(s)  
( ) Other

( ) Partner(s)  
( ) General  
( ) Limited

The party(ies) executing this document is/are representing:



2001-186719  
05/01/2001 08:08A  
2 of 5

**CERTIFICATE OF ACCEPTANCE  
(Government Code Section 27281)**

THIS IS TO CERTIFY that the interest in real property conveyed by the within instrument to the City of Riverside, California, a municipal corporation, is hereby accepted by the undersigned officer on behalf of the City Council of said City pursuant to authority conferred by Resolution No. 18233 of said City Council adopted May 11, 1993, and the grantee consents to recordation thereof by its duly authorized officer.

Dated 4/16/01

**APPROVED AS TO FORM**  
  
DEPUTY CITY CLERK

  
Real Property Services Manager  
Of the City of Riverside



2001-186719  
05/01/2001 08:00A  
3 of 5

EXHIBIT "A"

The northwesterly 8.00 feet of Lot 22 of Monterey Subdivision as shown by map recorded in Book 12, page 24 of Maps, records of Riverside County, California.

This description was prepared by me or under my direction in conformance with the requirements of the Land Surveyors Act.

 2/14/01 Prep. WF  
Mark S. Brown, L.S. 5655      Date  
License Expires 9/30/03

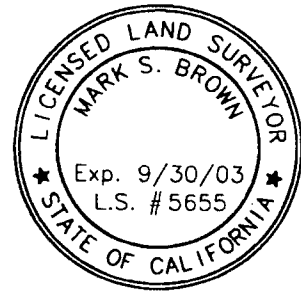

7634freda



2001-186719  
05/01/2001 08:00A  
4 of 5

-4  
14702

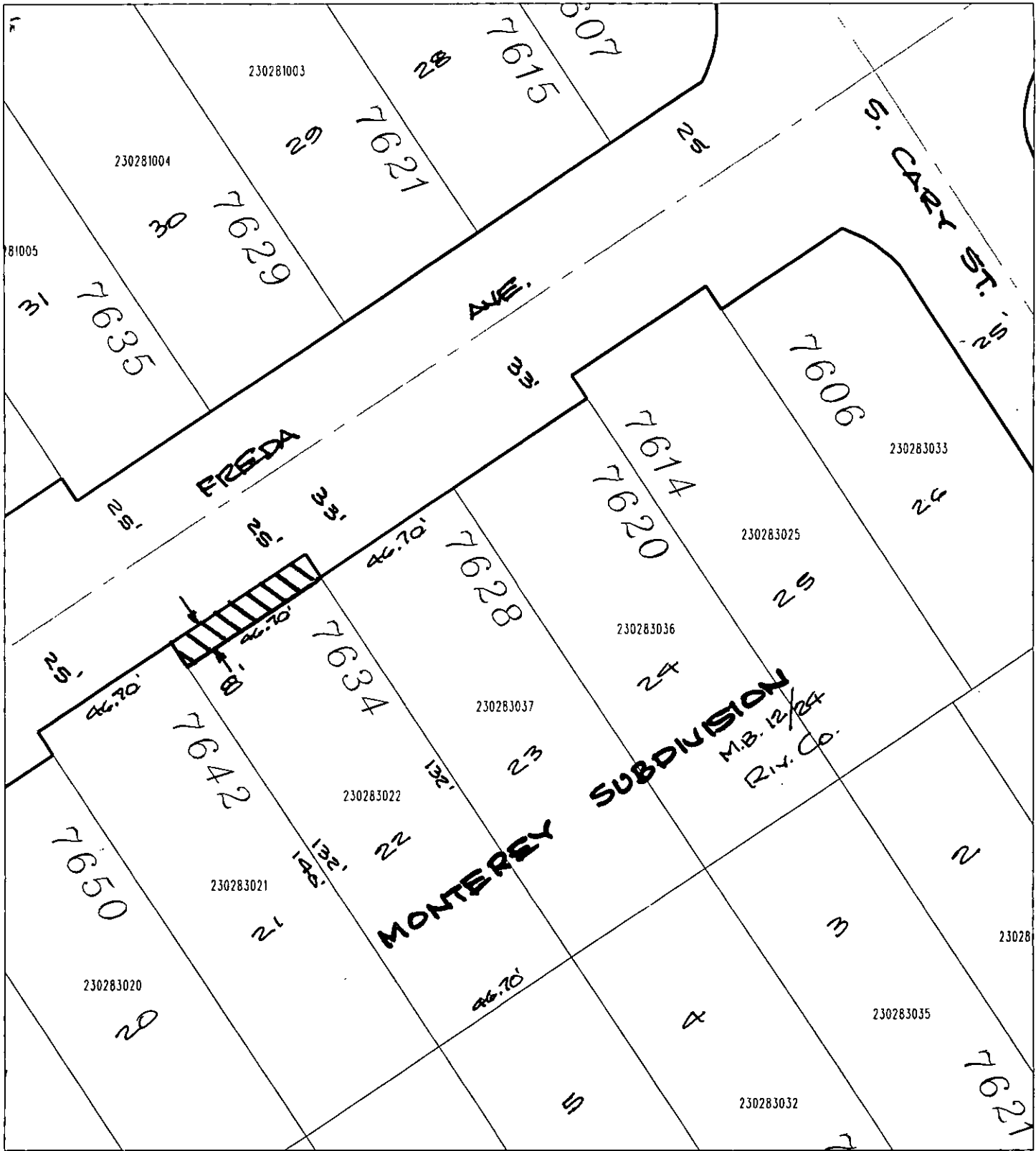

◆ CITY OF RIVERSIDE, CALIFORNIA ◆

68.3

THIS PLAT IS SOLELY AN AID IN LOCATING THE PARCEL(S) DESCRIBED IN THE ATTACHED DOCUMENT. IT IS NOT A PART OF THE WRITTEN DESCRIPTION THEREIN.

Sheet 1 of 1



Scale: 1" = 40'

Drawn by: fwally

Date: 02/13/01

Subject: 7634 Freda Ave. Building Permit



2881-186719

14702