

COMMONWEALTH LAND TITLE CO.

When recorded mail to:

City Clerk's Office
 City of Riverside
 City Hall, 3900 Main Street
 Riverside, California 92522

DOC # 2003-361743

05/20/2003 08:00A Fee:NC

Page 1 of 5

Recorded in Official Records

County of Riverside

Gary L. Orso

Assessor, County Clerk & Recorder



FREE RECORDING

This instrument is for the benefit of the City of Riverside and is entitled to be recorded without fee (Government Code §6103)

M	S	U	PAGE	SIZE	DA	PCOR	NOCOR	SMF	MISC.
	1		5						
								✓	VG
A	R	L			COPY	LONG	REFUND	NCHG	EXAM

FOR RECORDER'S OFFICE USE ONLY

T
VG

Project: *Downtown 12 KV Conversion*
 APN 217-070-023

Parcel 25

TWA 009-041
 6025932-11

D -

D.T.T. \$0

EASEMENT

15146

FOR VALUABLE CONSIDERATION, receipt of which is hereby acknowledged, *DE ANZA II*, a *California general partnership*, as Grantor, grants to the CITY OF RIVERSIDE, a municipal corporation of the State of California, as Grantee, its successors and assigns, an easement and right-of-way for the construction, reconstruction, maintenance, operation, inspection, repair, replacement removal of, relocation, renewal and **electrical energy distribution facilities**, together with all necessary appurtenances, in, under, upon, over and along that certain real property as described in **Exhibit "A"** attached hereto and incorporated herein by this reference, located in the City of Riverside, County of Riverside, State of California.

TOGETHER WITH the right to clear and keep clear said easement and right-of-way from any structures or trees, to enter upon and to pass and repass over and along said real

property, and to deposit tools, implements and other material thereon by Grantee, its officers, agents and employees and by persons under contract with said Grantee and their officers, agents and employees, whenever and wherever necessary for the purpose of constructing, reconstructing, maintaining, operating, inspecting, repairing, replacing, relocating, renewing and removing said **electrical energy distribution facilities**.

Dated December 2, 2002

John W. Minde
DE ANZA II, a California General Partnership

By: *John W. Minde*

Title: Partner

By: *John W. Minde*

Title: Partner



2003-361743
05/26/2003 08:00A
2 of 5

GENERAL ACKNOWLEDGEMENT

State of California
County of Riverside } ss

On Dec. 2, 2002 before me Frances M. Mansfield
(date) (name)

a Notary Public in and for said State, personally appeared
Thomas M. Mirich and Jerome F. Wall
Name(s) of Signer(s)

[X] personally known to me - OR - [] proved to me on the basis of satisfactory
evidence to be the person(s) whose name(s)
is/are subscribed to the within instrument and
acknowledged to me that he/she/they executed
the same in his/her/their authorized
capacity(ies), and that by his/her/their
signature(s) on the instrument the person(s), or
the entity upon behalf of which the person(s)
acted, executed the instrument.

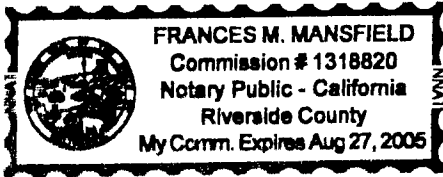

WITNESS my hand and official seal.

Signature of Frances M. Mansfield

OPTIONAL SECTION

CAPACITY CLAIMED BY SIGNER

- () Attorney-in-fact
() Corporate Officer(s)
Title
Title
() Guardian/Conservator
() Individual(s)
() Trustee(s)
() Other
() Partner(s)
() General
() Limited

The party(ies) executing this
document is/are representing:

CERTIFICATE OF ACCEPTANCE
(Government Code Section 27281)

THIS IS TO CERTIFY that the interest in real property conveyed by the
within instrument to the City of Riverside, California, a municipal corporation, is hereby
accepted by the undersigned officer on behalf of the City Council of said City pursuant to
authority conferred by Resolution No. 18233 of said City Council adopted May 11, 1993,
and the grantee consents to recordation thereof by its duly authorized officer.

Dated 4-1-03

Signature of Real Property Services Manager of the
City of Riverside

APPROVED AS TO FORM
CITY ATTORNEYS OFFICE

Signature of Deputy City Attorney



EXHIBIT "A"

Parcel 25

That portion of Lot 154 of the Lands of the Southern California Colony Association, as per map recorded in Book 7, page 3 of Maps, records of San Bernardino County, California, described as follows:

COMMENCING at the northerly terminus of that certain course described as North 42° 20'40" East, 50.34 feet, of Parcel 3 of those certain parcels of land described in Instrument No. 42163, recorded February 29, 1984 of Official Records of Riverside County, California;

Thence South 42°20'40" West, along said course, 29.00 feet to the TRUE POINT OF BEGINNING;

Thence continuing South 42°20'40" West, along said course, 7.00 feet;

Thence South 47°39'20" East, 6.00 feet;

Thence North 42°20'40" East, 7.00 feet;

Thence North 47°39'20" West, 6.00 feet to said TRUE POINT OF BEGINNING.

Area: 42 square feet

This description was prepared by me or under my direction in conformance with the requirements of the Land Surveyors Act.

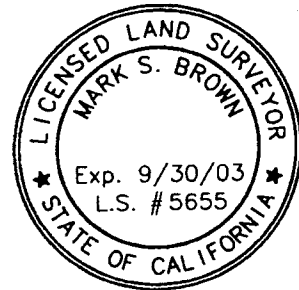

Mark S. Brown 9/18/01 Prep. *WF*
Mark S. Brown, L.S. 5655 Date
License Expires 9/30/03



2003-361743
05/28/2003 08:00A
4 of 5



MAGNOLIA AV.

FIFTEENTH ST.

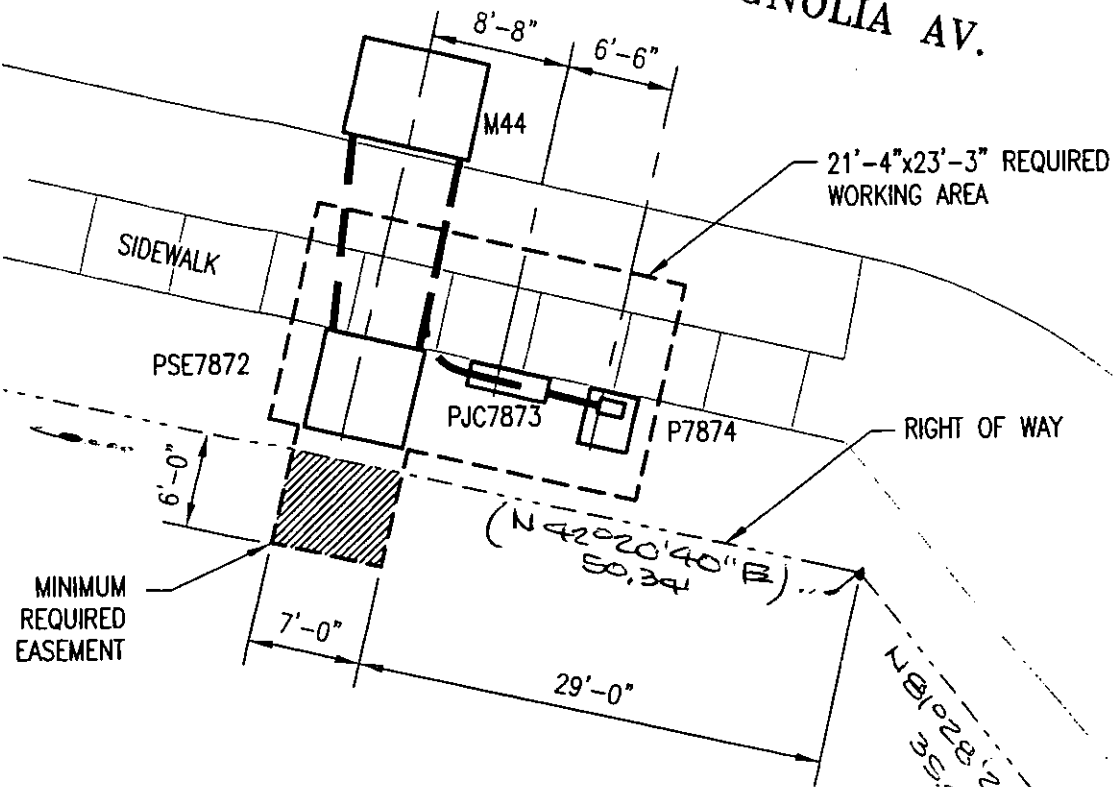

3
 PAR. ~~X~~ P.M.W. 23-823
 ASSESSOR PARCEL NO.
 217 070 023
 PAR 25

PARCEL 3
 INST. No. 42163
 REC. FEB. 29, 1984, O.R., R.V. CO

05/26/2003 08:00A
 5 of 5



NO.	REVISION	DATE

RIVERSIDE PUBLIC UTILITIES
 4kV TO 12kV CONVERSION

EASEMENT REQUIREMENTS
 MAGNOLIA AV. AND
 FIFTEENTH ST. 39-1



Intermountain Consulting
 Professional Engineers, Inc.
 CONSULTING ENGINEERS
 1145 E. NORTH TEXAS AVE.
 MOYALE UTAH 84047
 UTAH (801) 586-1111 FAX 800-0086

SCALE: 1"=12'-0"	DATE PLOTTED: 03/06/2001	DRAWN BY: NM
---------------------	-----------------------------	-----------------

ACCT. NO. 6130003600-47064407-674115

15146