



When recorded mail to:

City Clerk's Office
City of Riverside
City Hall, 3900 Main Street
Riverside, California 92522

FREE RECORDING

This instrument is for the benefit of the City of Riverside and is entitled to be recorded without fee (Government Code §6103)

M	S	U	PAGE	SIZE	DA	PCOR	NOCOR	SMF	MISC.
1			5						
								✓	MD
A	R	L			COPY	LONG	REFUND	NCHG	EXAM

FOR RECORDER'S OFFICE USE ONLY

Project: P03-1123
APN 142-180-007, -008, -009, &-018
3847 Pierce Street

D- 15317



EASEMENT

FOR VALUABLE CONSIDERATION, receipt of which is hereby acknowledged, WILTON K. NEWBY, Successor Trustee of the Newby Family Trust dated March 10, 1982 as Grantor(s), grant(s) to the CITY OF RIVERSIDE, a municipal corporation of the State of California, as Grantee, its successors and assigns, an easement and right-of-way for the construction, reconstruction, maintenance, operation, inspection, repair, replacement, relocation, renewal and removal of WATER DISTRIBUTION FACILITIES, together with all necessary appurtenances, in, under, upon, over and along that certain real property described in **EXHIBIT A** attached hereto and incorporated herein by this reference, located in the City of Riverside, County of Riverside, State of California.

TOGETHER WITH the right to clear and keep clear said easement and right-of-way from any structures or trees, to enter upon and to pass and repass over and along said real property, and to deposit tools, implements and other material thereon by Grantee, its officers, agents and employees and by persons under contract with said Grantee and their officers, agents and employees, whenever and wherever necessary for the purpose of constructing, reconstructing,



maintaining, operating, inspecting, repairing, replacing, relocating, renewing and removing said
WATER DISTRIBUTION FACILITIES

Date: 3/22/04

WILTON K. NEWBY, Successor Trustee of
the Newby Family

Wilton K Newby
WILTON K. NEWBY, Successor Trustee

GENERAL ACKNOWLEDGEMENT

OPTIONAL SECTION

State of California }
County of Riverside } ss
On 3-22-04, before me Carol Smith
(date) (name)

CAPACITY CLAIMED BY SIGNER

a Notary Public in and for said State, personally appeared
Wilton K. Newby
Name(s) of Signer(s)

- () Attorney-in-fact
- () Corporate Officer(s)
- Title _____
- Title _____
- () Guardian/Conservator
- () Individual(s)
- () Trustee(s)
- () Other

personally known to me - OR - proved to me on the basis of satisfactory evidence to be
the person(s) whose name(s) is are subscribed to
the within instrument and acknowledged to me that
he/she/they executed the same in his/her/their
authorized capacity(ies), and that by his/her/their
signature(s) on the instrument the person(s), or the
entity upon behalf of which the person(s) acted,
executed the instrument.

- () Partner(s)
- () General
- () Limited

The party(ies) executing this
document is/are representing:



WITNESS my hand and official seal.
Carol Smith
Signature



**CERTIFICATE OF ACCEPTANCE
(Government Code Section §27281)**

THIS IS TO CERTIFY that the interest in real property conveyed by the within instrument to the City of Riverside, California, a municipal corporation, is hereby accepted by the undersigned officer on behalf of the City Council of said City pursuant to authority conferred by Resolution No. 20534 of said City Council adopted September 23, 2003 and the grantee consents to recordation thereof by its duly authorized officer.

DATED 4/6/04

CITY OF RIVERSIDE

By: *Mel Greaney*

Administrative Services Manager

**APPROVED AS TO FORM
CITY ATTORNEYS OFFICE**

BY: *West Smith*
Deputy City Attorney



EXHIBIT A

Project: P03-1123
LLA - 3847 Pierce Street

THAT CERTAIN REAL PROPERTY IN THE CITY OF RIVERSIDE, COUNTY OF RIVERSIDE, STATE OF CALIFORNIA BEING A PORTION OF HALLADAY AVENUE (VACATED) AND NOW BEING A PORTION LOTS 4 AND 10 IN BLOCK 9 OF LA SIERRA GARDENS AS SHOWN BY MAP ON FILE IN MAP BOOK 11, PAGES 42-50 THEREOF RECORDS OF RIVERSIDE COUNTY CALIFORNIA AND DESCRIBED AS FOLLOWS:

THE EASTERLY 10.00 FEET OF THE SOUTHERLY 25.00 FEET OF LOT 10, BLOCK 9 TOGETHER WITH THE WESTERLY 30.00 FEET OF THE SOUTHERLY 25.00 FEET OF LOT 4, AS BOTH LOTS ARE NOW EXTENDED TO THE CENTERLINE OF HALLADAY AVENUE AS VACATED.

This description was prepared by me or under my direction in conformance with the requirements of the Land Surveyors Act.

 3/1/04 Date Prep. 
Mark S. Brown, L.S. 5655
License Expires 9/30/05

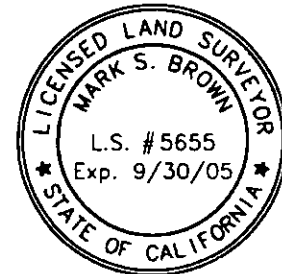

2004-0264667
04/13/2004 08:00A
4 of 5

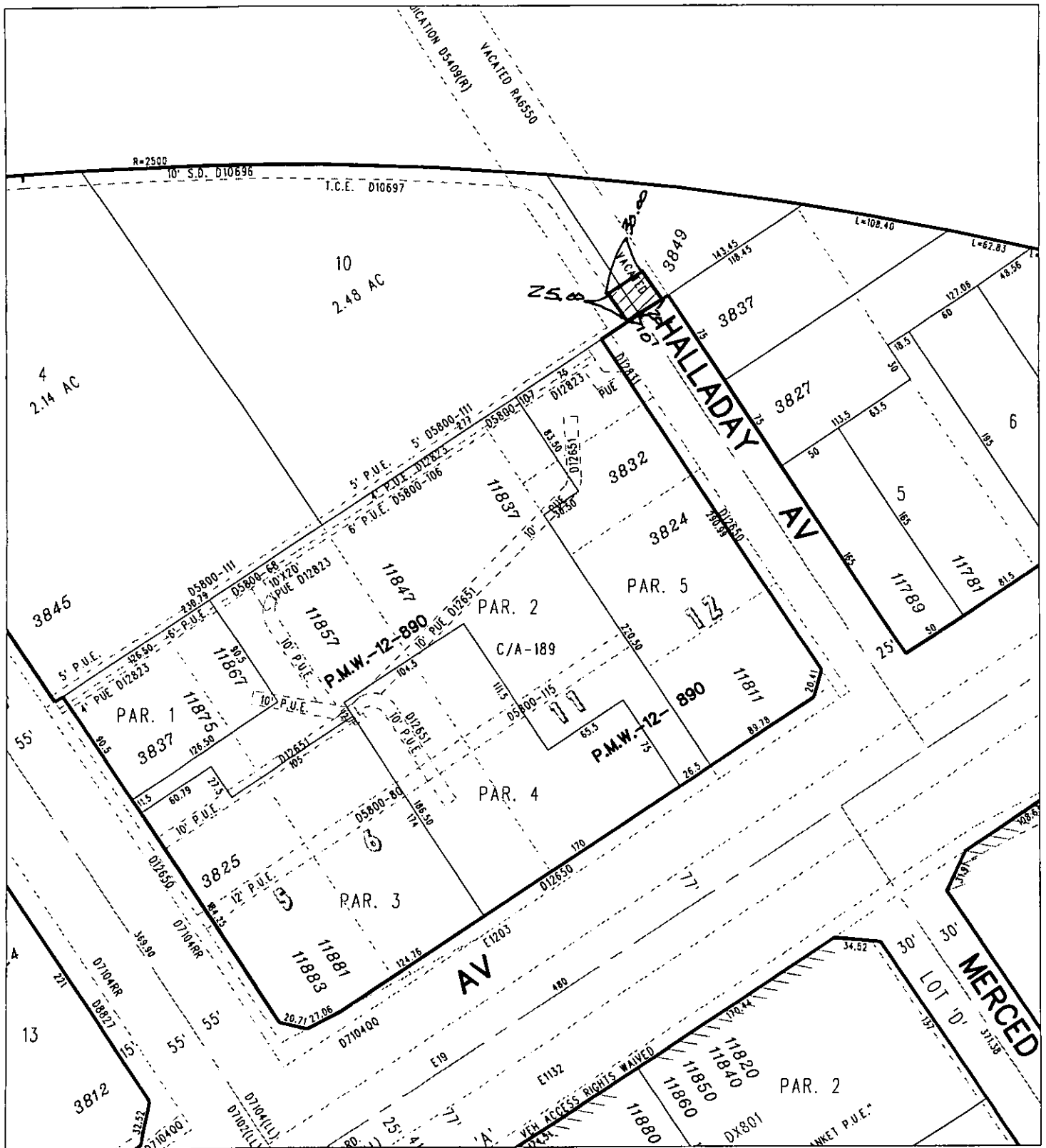

◆ CITY OF RIVERSIDE, CALIFORNIA ◆

786

THIS PLAT IS SOLELY AN AID IN LOCATING THE PARCEL(S) DESCRIBED IN THE ATTACHED DOCUMENT. IT IS NOT A PART OF THE WRITTEN DESCRIPTION THEREIN.

Sheet 1 of 1



Scale: 1" = 100'

Drawn by: bmark

Date: 03/01/04

Subject: Water Esmt