



When recorded mail to:

City Clerk's Office
City of Riverside
City Hall, 3900 Main Street
Riverside, California 92522

FREE RECORDING

This instrument is for the benefit of the City of Riverside and is entitled to be recorded without fee (Government Code §6103)

2135482-7

Project: Rancho La Sierra
APN: 154-200-059

M	S	U	PAGE	SIZE	DA	PCOR	NOCOR	SMF	MISC.
	1		11						
A	R	L			COPY	LONG	REFUND	NCHG	EXAM

FOR RECORDER'S OFFICE USE ONLY

D - 15782

T
CM

EASEMENT

FOR VALUABLE CONSIDERATION, receipt of which is hereby acknowledged, EDDIE R. FISCHER, as Trustee of the Fischer Family Trust established January 24, 1975, as amended and restated January 14, 1988, and JOHN L. WEST and BEVERLY J. WEST, Husband and Wife as Community Property, and HENRY C. COX II and JACQUELINE N. COX, Husband and Wife as Community Property, and JURUPA WESTERN, INC., A California Corporation, and THE TYLER STREET GROUP, A California Limited Partnership, all as their interests appear of record, as Grantors, grant to the CITY OF RIVERSIDE, a municipal corporation of the State of California, as Grantee, its successors and assigns, an easement and right-of-way for the construction, reconstruction, maintenance, operation, inspection, repair, replacement, relocation, renewal and removal of a **RECREATIONAL TRAIL**, together with all necessary appurtenances, in, under, upon, over and along that certain real property described in **EXHIBIT A** attached hereto and

incorporated herein by this reference, located in the City of Riverside, County of Riverside, State of California.

TOGETHER WITH the right to clear and keep clear said easement and right-of-way from any structures or trees, to enter upon and to pass and repass over and along said real property, and to deposit tools, implements and other material thereon by Grantee, its officers, agents and employees and by persons under contract with said Grantee and their officers, agents and employees, whenever and wherever necessary for the purpose of constructing, reconstructing, maintaining, operating, inspecting, repairing, replacing, relocating, renewing and removing said **RECREATIONAL TRAIL**.

Dated 4-14-06

EDDIE R. FISCHER,
Trustee of the Fischer Family Trust
established January 24, 1975, as amended
and restated January 14, 1988



EDDIE R. FISCHER, Trustee

Dated 4-13-06

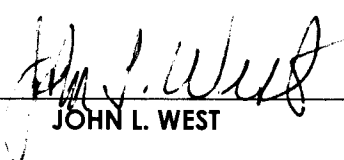

JOHN L. WEST



BEVERLY J. WEST

Dated 4/12/2006



HENRY C. COX II



JACQUELINE N. COX

Dated 4/12/06

JURUPA WESTERN, INC,
A California Corporation

By: _____

By:  _____

Print Name: _____

Print Name: HENRY C. COX, II

Title: _____

Title: VICE-PRESIDENT

Dated 4.12.06

THE TYLER STREET GROUP,
A California LIMITED PARTNERSHIP

By: _____

By:  _____

Print Name: _____

Print Name: HENRY C. COX, II

Title: _____

Title: GENERAL PARTNER

GENERAL ACKNOWLEDGEMENT

State of California }
County of RIVERSIDE } ss

On 4-13-06, before me ELOUISE A. AGNES
(date) (name)

a Notary Public in and for said State, personally appeared

HENRY O. COX II & JACQUELINE W. COX
Name(s) of Signer(s)

personally known to me - OR - proved to me on the basis of satisfactory evidence to be the person(s) whose name(s) is/are subscribed to the within instrument and acknowledged to me that he/she/they executed the same in his/her/their authorized capacity(ies), and that by his/her/their signature(s) on the instrument the person(s), or the entity upon behalf of which the person(s) acted, executed the instrument.

WITNESS my hand and official seal.

Elouise A. Agnes
Signature

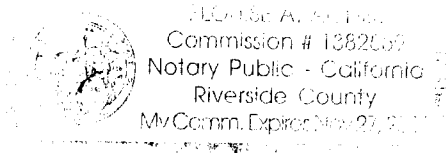

OPTIONAL SECTION

CAPACITY CLAIMED BY SIGNER

() Attorney-in-fact
() Corporate Officer(s)
Title _____
Title _____

() Guardian/Conservator
() Individual(s)
() Trustee(s)

() Other

() Partner(s)
() General
() Limited

The party(ies) executing this document is/are representing:

GENERAL ACKNOWLEDGEMENT

State of California }
County of RIVERSIDE } ss

On 4-13-06, before me ELOUISE A. AGNES
(date) (name)

a Notary Public in and for said State, personally appeared

JOHN L. WEST & BEVERLY J. WEST
Name(s) of Signer(s)

personally known to me - OR - proved to me on the basis of satisfactory evidence to be the person(s) whose name(s) is/are subscribed to the within instrument and acknowledged to me that he/she/they executed the same in his/her/their authorized capacity(ies), and that by his/her/their signature(s) on the instrument the person(s), or the entity upon behalf of which the person(s) acted, executed the instrument.

WITNESS my hand and official seal.

Eloise A. Agnes
Signature

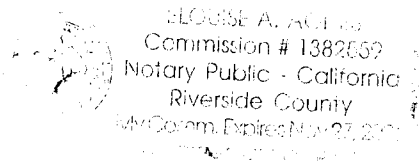

OPTIONAL SECTION

CAPACITY CLAIMED BY SIGNER

() Attorney-in-fact
() Corporate Officer(s)
Title _____
Title _____

() Guardian/Conservator
() Individual(s)
() Trustee(s)
() Other

() Partner(s)
() General
() Limited

The party(ies) executing this document is/are representing:

GENERAL ACKNOWLEDGEMENT

State of California }
County of RIVERSIDE } ss

On 4-13-06, before me ELUISE A AGNES
(date) (name)

a Notary Public in and for said State, personally appeared

HENRY C. COY II
Name(s) of Signer(s)

personally known to me - OR - proved to me on the basis of satisfactory evidence to be the person(s) whose name(s) is/are subscribed to the within instrument and acknowledged to me that he/she/they executed the same in his/her/their authorized capacity(ies), and that by his/her/their signature(s) on the instrument the person(s), or the entity upon behalf of which the person(s) acted, executed the instrument.

WITNESS my hand and official seal.

Eluise A Agnes
Signature

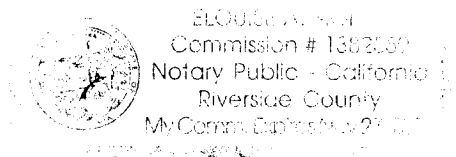

OPTIONAL SECTION

CAPACITY CLAIMED BY SIGNER

() Attorney-in-fact
() Corporate Officer(s)
Title _____
Title _____

() Guardian/Conservator
() Individual(s)
() Trustee(s)
() Other

() Partner(s)
() General
() Limited

The party(ies) executing this document is/are representing:

GENERAL ACKNOWLEDGEMENT

State of California }
County of RIVERSIDE } ss

On 4.13.06, before me ELOUISE A. AGNES
(date) (name)

a Notary Public in and for said State, personally appeared

HENRY C. COX II
Name(s) of Signer(s)

personally known to me - OR - proved to me on the basis of satisfactory evidence to be the person(s) whose name(s) is/are subscribed to the within instrument and acknowledged to me that he/she/they executed the same in his/her/their authorized capacity(ies), and that by his/her/their signature(s) on the instrument the person(s), or the entity upon behalf of which the person(s) acted, executed the instrument.

WITNESS my hand and official seal.

Eloise A. Agnes
Signature

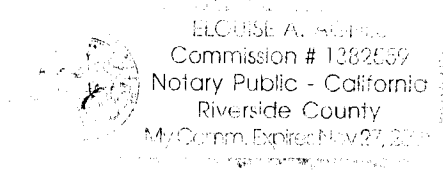

OPTIONAL SECTION

CAPACITY CLAIMED BY SIGNER

() Attorney-in-fact
() Corporate Officer(s)
Title _____
Title _____

() Guardian/Conservator
() Individual(s)
() Trustee(s)

() Other

() Partner(s)
() General
() Limited

The party(ies) executing this document is/are representing:

GENERAL ACKNOWLEDGEMENT

State of California

County of Orange

} ss

On Apr. 14, 2006 before me

(date)

Patricia Sue Hoag
(name)

a Notary Public in and for said State, personally appeared

Eddie R. Fischer

Name(s) of Signer(s)

personally known to me - OR - proved to me on the basis of satisfactory evidence to be the person(s) whose name(s) is/~~are~~ subscribed to the within instrument and acknowledged to me that he/~~she/they~~ executed the same in his/~~her/their~~ authorized capacity(ies), and that by his/~~her/their~~ signature(s) on the instrument the person(s), or the entity upon behalf of which the person(s) acted, executed the instrument.



WITNESS my hand and official seal.

Patricia Sue Hoag
Signature

OPTIONAL SECTION

CAPACITY CLAIMED BY SIGNER

() Attorney-in-fact
() Corporate Officer(s)
Title _____
Title _____

() Guardian/Conservator
() Individual(s)
 Trustee(s)

() Other

() Partner(s)
() General
() Limited

The party(ies) executing this document is/are representing:

Fischer Family Trust

**CERTIFICATE OF ACCEPTANCE
(Government Code Section §27281)**

THIS IS TO CERTIFY that the interest in real property conveyed by the within instrument to the City of Riverside, California, a municipal corporation, is hereby accepted by the undersigned officer on behalf of the City Council of said City pursuant to authority conferred by Resolution No. 21027 of said City Council adopted September 06, 2005 and the grantee consents to recordation thereof by its duly authorized officer.

Dated 5/24/06

CITY OF RIVERSIDE

By: Annelia M. Valenti

Title: Real Property Mgr

APPROVED AS TO FORM
[Signature]
SUPERVISING DEPUTY CITY ATTORNEY

EXHIBIT "A"
MULTI-PURPOSE RECREATIONAL TRAILS
FOR NON-MOTORIZED USE DEDICATION
TO THE CITY OF RIVERSIDE
PORTION OF PARCEL 12 OF LLA 015-989

Being a portion of the North half of fractional Section 35, T. 2 S., R. 6 W., San Bernardino Base and Meridian, as shown by Sectionalized Survey of Rancho La Sierra, of file in Book 6, Page 70 of Maps, Records of Riverside County, California;

Multi-Purpose Recreational Trail dedication being a 5.00 feet wide strip of land lying south of a line more particularly described as follows:

Trail No. 1

BEGINNING at the Northeasterly corner of Parcel 12, as shown by Lot Line Adjustment LL-015-989 recorded February 19, 1999 as Instrument No. 67028 of Official Records of Riverside County, California., also being the beginning of a non-tangent curve, concave southerly, having a radius of 1055.00 feet, and having at said point a radial line which bears N 03°33'33" E;

THENCE, Westerly along the arc of said curve to the left, with a central angle of 1°12'17", a distance of 22.18;

THENCE, N 87°38'45" W, a distance of 78.00 feet to the end of this strip of land.

The sidelines of said strip shall be prolonged or shortened to intersect with the easterly line of Parcel 12 and a line common to said Parcel 11 and 12.

DESCRIPTION APPROVAL:

BY: *Mark S. Brown* 03.30.06
DATE
FOR: MARK S. BROWN
CITY SURVEYOR

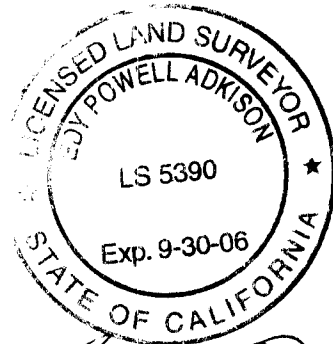

Edy Powell Adkison
3-29-2006

EXHIBIT "B"

TRAIL NO.1 (PARCEL 12 WEST)

SHEET 1 OF 1
M.P.R.T. #17



10'
MULTI-PURPOSE
RECREATIONAL
TRAIL FOR
NON-MOTORIZED
USE.
TRAIL NO. 1

POINT OF TERMINATION
OF THIS SEGMENT

PARCEL 11
RECORDED 2/19/99 AS
INST. NO. 067028

LLA-015-989

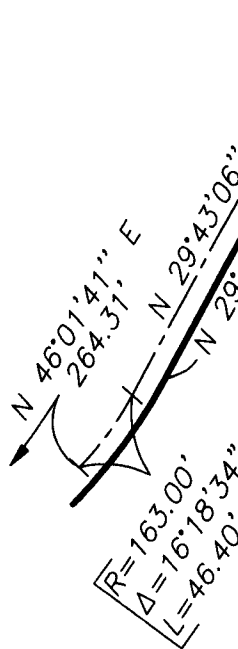

PARCEL 12
RECORDED 2/19/99 AS
INSTR. NO. 067030

CURVE TABLE				
CURVE	DELTA	RADIUS	LENGHT	TANGENT
C1	1°12'17"	1055.00'	22.18'	11.09'

LINE TABLE

NUMBER	DIRECTION	DISTANCE
L1	N 87°38'45" W	78.00'

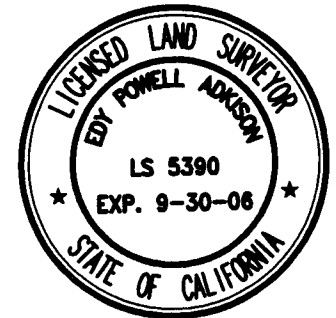

34-7

<p>PLAT PREPARED BY:</p> <h3 style="margin: 0;">adkan ENGINEERS</h3> <p style="font-size: small; margin: 0;">Civil Engineering · Surveying · Planning 6820 Airport Drive, Riverside, CA 92504 Tel: (951) 688-0241 · Fax: (951) 688-0599</p>	SCALE: 1"=100'	JOB NO. 4725	DATE: 5/27	CLIENT: RANCHO / COX
	<p>APPROVED BY: 3-29-2006</p> <p style="text-align: center;">EDY P. ADKISON L.S. 5390</p>		<p>MULTI-PURPOSE RECREATIONAL TRAIL FOR NON-MOTORIZED USE EASEMENT LL-015-989 RANCHO LA SIERRA</p>	