

UNIVERSITY COMPANY

DOC # 2007-0058416

01/25/2007 08:00A Fee:NC

Page 1 of 4

Recorded in Official Records

County of Riverside

Larry W. Ward

Assessor, County Clerk & Recorder



When recorded mail to:

City Clerk's Office
City of Riverside
City Hall, 3900 Main Street
Riverside, California 92522

FREE RECORDING

This instrument is for the benefit of the City of Riverside and is entitled to be recorded without fee (Government Code §6103)

S	R	U	PAGE	SIZE	DA	MISC	LONG	RFD	COPY
			4						
M	A	L	465	426	PCOR	NCOR	SMF	NCHG	EXAM

Project:Reeves
APN: 213-172-008 & 213-122-007
Address: 3308 Mulberry St. & 3343 Fourth St

D - 007-0

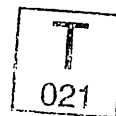

TRA 009-04/
PTT - exempt

GRANT DEED

EUGENE ALMON FARLEY, Successor Trustee of that certain Revocable Declaration of Trust known as THE EDNA MAE FARLEY REEVES INTER-VIVOS TRUST dated October 21, 1994, as Grantor(s), FOR VALUABLE CONSIDERATION, receipt of which is hereby acknowledged, do(es) hereby grant to THE REDEVELOPMENT AGENCY OF THE CITY OF RIVERSIDE, CALIFORNIA, a public body corporate and politic, as Grantee, its successors and assigns, the real property as described in Exhibit "A" attached hereto and incorporated herein by this reference, located in the City of Riverside, County of Riverside, State of California.

THE EDNA MAE FARLEY REEVES
INTER-VIVOS TRUST dated October 21,
1994

Dated 1-16-07

Eugene Almon Farley
EUGENE ALMON FARLEY,
Successor Trustee

GENERAL ACKNOWLEDGEMENT

State of ~~California~~ ^{Alabama} }
County of Madison } ss

On 1-11-07, before me [Signature]
(date) (name)

a Notary Public in and for said State, personally appeared

[Signature]
Name(s) of Signer(s)

personally known to me - OR - proved to me on the basis of satisfactory evidence to be the person(s) whose name(s) is/are subscribed to the within instrument and acknowledged to me that he/she/they executed the same in his/her/their authorized capacity(ies), and that by his/her/their signature(s) on the instrument the person(s), or the entity upon behalf of which the person(s) acted, executed the instrument.

WITNESS my hand and official seal.
[Signature]
Signature

OPTIONAL SECTION

CAPACITY CLAIMED BY SIGNER

- () Attorney-in-fact
- () Corporate Officer(s)
- Title _____
- Title _____
- () Guardian/Conservator
- () Individual(s)
- Trustee(s)
- () Other
- _____
- _____
- () Partner(s)
- () General
- () Limited

The party(ies) executing this document is/are representing:

CERTIFICATE OF ACCEPTANCE
(Government Code Section §27281)

THIS IS TO CERTIFY that the interest in real property conveyed by the within instrument to The Redevelopment Agency of the City of Riverside, California, a public body, corporate and politic, is hereby accepted by the undersigned officer on behalf said Agency pursuant to authority conferred by Resolution No. 775 of said Agency adopted September 6, 2005, and the grantee consents to recordation thereof by its duly authorized officer.

Dated 1/11/07

REDEVELOPMENT AGENCY OF THE CITY OF RIVERSIDE

APPROVED AS TO FORM:

By: [Signature]

[Signature]
AGENCY GENERAL COUNSEL

Print Name: [Signature]

EXHIBIT A

PARCEL 1

APN 213-172-008

FEE SIMPLE INTEREST

THAT CERTAIN REAL PROPERTY IN THE CITY OF RIVERSIDE, COUNTY OF RIVERSIDE, STATE OF CALIFORNIA BEING THAT PORTION OF BLOCK 4, RANGE 3, OF THE TOWN OF RIVERSIDE AS SHOWN BY MAP ON FILE IN MAP BOOK 7, PAGE 17 THEREOF, RECORDS OF SAN BERNARDINO COUNTY CALIFORNIA DESCRIBED AS FOLLOWS:

BEGINNING AT THE NORTHWESTERLY CORNER OF SAID BLOCK 4, RANGE 3;

THENCE SOUTHERLY ON THE WESTERLY LINE OF MULBERRY STREET, A DISTANCE OF 100.00 FEET;

THENCE AT RIGHT ANGLES WESTERLY, A DISTANCE OF 159.00 FEET TO AN ALLEY;

THENCE AT A RIGHT ANGLES NORTHERLY ON THE EASTERLY LINE OF SAID ALLEY, A DISTANCE OF 100 FEET TO THE SOUTHERLY LINE OF FOURTH STREET;

THENCE AT RIGHT ANGLES EASTERLY ON THE SOUTHERLY LINE OF FOURTH STREET A DISTANCE OF 159.00 FEET TO THE POINT OF BEGINNING.

PARCEL 2

APN 213-122-007

FEE SIMPLE INTEREST

THAT CERTAIN REAL PROPERTY IN THE CITY OF RIVERSIDE, COUNTY OF RIVERSIDE, STATE OF CALIFORNIA DESCRIBED AS FOLLOWS:

LOT 13 OF THE RE-SUBDIVISION OF BLOCK 3, RANGE 3, OF THE CITY OF RIVERSIDE AS SHOWN BY MAP ON FILE IN MAP BOOK 4, PAGE 89 THEREOF, RECORDS OF RIVERSIDE COUNTY CALIFORNIA.

This description was prepared by me or under my direction in conformance with the requirements of the Land Surveyors Act.

 12/8/06 Prep. _____
Mark S. Brown, L.S. 5655 Date
License Expires 9/30/07



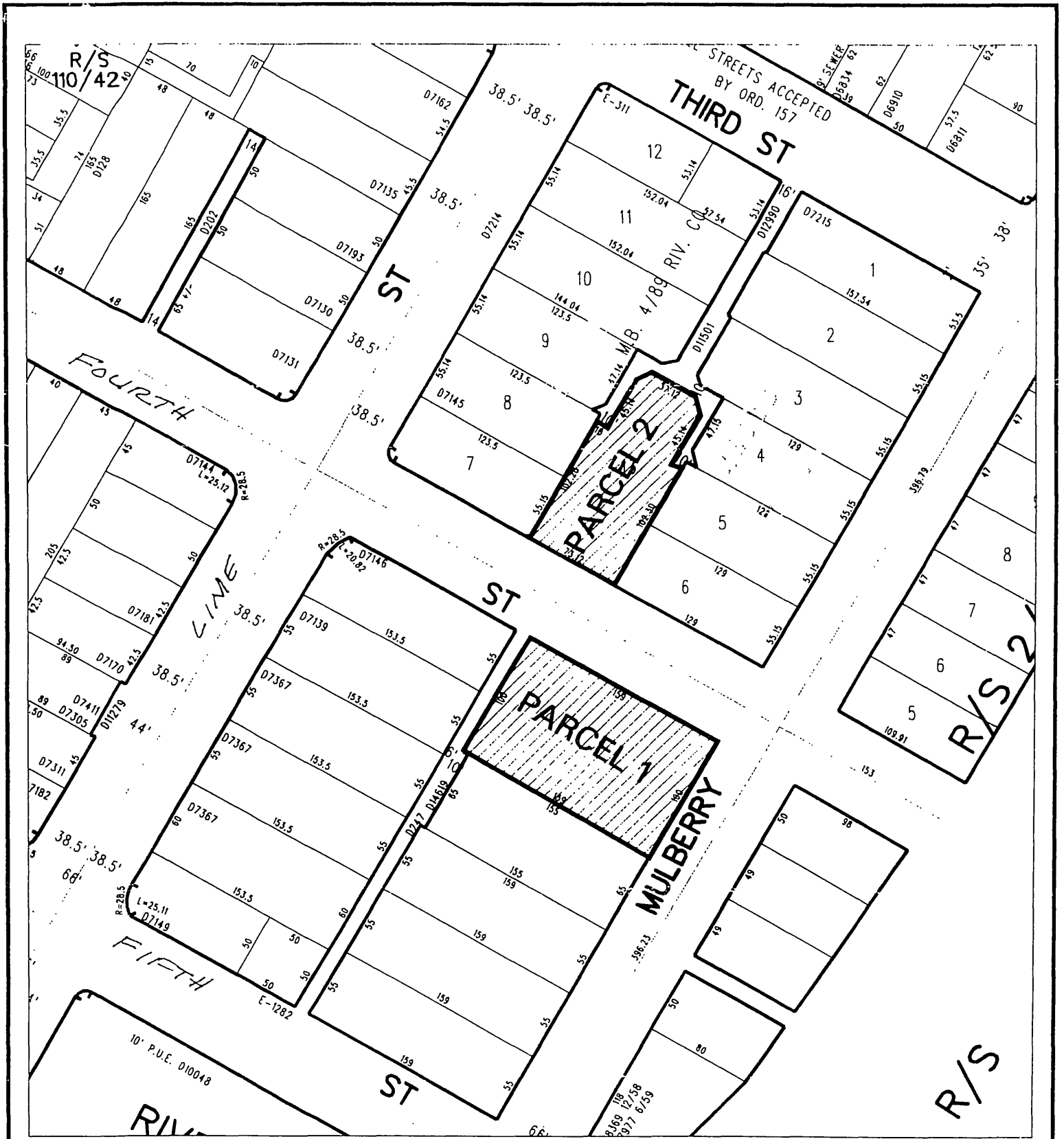

◆ CITY OF RIVERSIDE, CALIFORNIA ◆

THIS PLAT IS SOLELY AN AID IN LOCATING THE PARCEL(S) DESCRIBED IN THE ATTACHED DOCUMENT. IT IS NOT A PART OF THE WRITTEN DESCRIPTION THEREIN.

Sheet 1 of 1

25-7



Scale: 1" = 100'

Drawn by: bmark

Date: 12/08/06

Subject: REEVES

15929