

Unrecorded Title

When recorded mail to:

City Clerk's Office  
City of Riverside  
City Hall, 3900 Main Street  
Riverside, California 92522

DOC # 2008-0385679

07/15/2008 08:00A Fee:NC

Page 1 of 5

Recorded in Official Records  
County of Riverside

Larry W. Ward

Assessor, County Clerk & Recorder

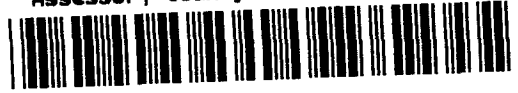

FREE RECORDING

This instrument is for the benefit of the City of Riverside and is entitled to be recorded without fee (Government Code §6103)

S	R	U	PAGE	SIZE	DA	MISC	LONG	RFD	COPY
1			5						
M	A	L	465	426	PCOR	NCOR	SMF	NCHG	EXAM
							T	CTY	UNI
									040

Project: Discount Liquor  
APN: 211-131-018 TRK-009-063  
Address: 2619 University Avenue

D-0

16246

T  
043

GRANT DEED

HASSAN TAHERI, Grantor, FOR VALUABLE CONSIDERATION, receipt of which is hereby acknowledged, does hereby grant to the CITY OF RIVERSIDE, a municipal corporation of the State of California, as Grantee, its successors and assigns, the real property as described in Exhibit "A" attached hereto and incorporated herein by this reference, located in the City of Riverside, County of Riverside, State of California.

Dated: 6-24-08

By: Hassan Taheri

16246

**ACKNOWLEDGEMENT**

State of California  
County of San Bernardino ss

On 6-24-08, before me Sandra L. Olson, Notary Public  
personally appeared HASSAN TAHERI  
who proved to me on the basis of satisfactory evidence to be the person(s) whose name(s)  
is/are subscribed to the within instrument and acknowledged to me that he/she/they executed  
the same in his/her/their authorized capacity(ies), and that by his/her/their signature(s) on the  
instrument the person(s), or the entity upon behalf of which the person(s) acted, executed the  
instrument.

I certify under PENALTY OF PERJURY under the laws of the State of California that the  
foregoing paragraph is true and correct

WITNESS my hand and official seal.

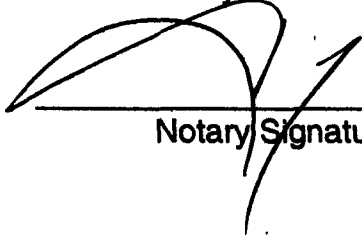
  
\_\_\_\_\_  
Notary Signature

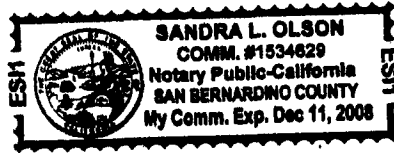

**CERTIFICATE OF ACCEPTANCE**  
**(Government Code Section §27281)**

THIS IS TO CERTIFY that the interest in real property conveyed by the within instrument to the  
City of Riverside, California, a municipal corporation, is hereby accepted by the undersigned  
officer on behalf of the City Council of said City pursuant to authority conferred by Resolution  
No. 21027 of said City Council adopted September 06, 2005 and the grantee consents to  
recordation thereof by its duly authorized officer.

Dated: 7/2/08

**CITY OF RIVERSIDE**

By: Richard J. Graham  
Real Property Manager

  
APPROVED AS TO FORM  
SUPERVISING DEPUTY CITY ATTORNEY

SPOUSAL RELEASE  
Fee

I am the spouse of Hassan Taheri and I hereby remise, release and forever quitclaim to the City of Riverside, a municipal corporation of the State of California, any rights, title or interest in the above described property I may have, including any and all community property interest therein.

Maryam Farzin  
Maryam Farzin

ACKNOWLEDGEMENT

State of California  
County of San Bernardino

Sandra L. Olson (SLO)

On 6-24-08, before me, Sandra L. Olson Notary Public, personally appeared Maryam Farzin who proved to me on the basis of satisfactory evidence to be the person(s) whose name(s) is/are subscribed to the within instrument and acknowledged to me that he/she/they executed the same in his/her/their authorized capacity(ies), and that by his/her/their signature(s) on the instrument the person(s), or the entity upon behalf of which the person(s) acted, executed the instrument.

I certify under PENALTY OF PERJURY under the laws of the State of California that the foregoing paragraph is true and correct

WITNESS my hand and official seal.

[Signature]  
Notary Signature

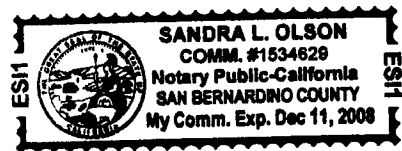

EXHIBIT "A"

A.P.N. 211-131-018  
FEE SIMPLE INTEREST

That certain real property located in the City of Riverside, County of Riverside,  
State of California, described as follows:

Lot 19 in Block 11 of White's Addition, as shown by map on file in Book 6, Page  
48 of Maps, records of San Bernardino County, California.

DESCRIPTION APPROVAL:

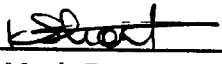
By:       02/07/2006  
For Mark Brown                      Date  
City Surveyor

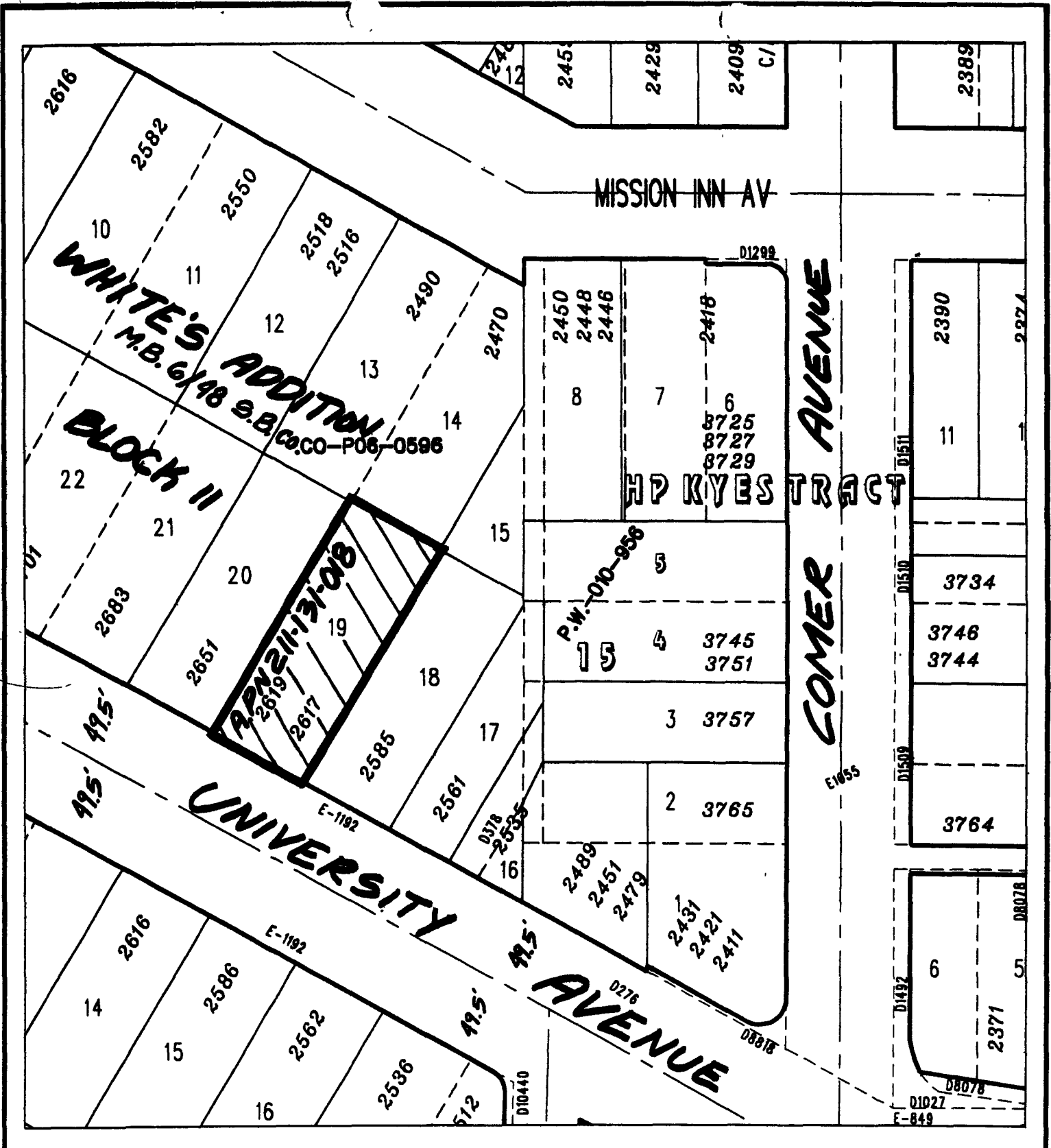

◆ CITY OF RIVERSIDE, CALIFORNIA ◆

40-1

THIS PLAT IS SOLELY AN AID IN LOCATING THE PARCEL(S) DESCRIBED IN THE ATTACHED DOCUMENT. IT IS NOT A PART OF THE WRITTEN DESCRIPTION THEREIN.

Sheet 1 of 1



Scale: 1" = 80'

Drawn by: ev

Date: 05/08/08

Subject: LEGALS AND PLATS