

When recorded mail to:

City Clerk's Office
City of Riverside
City Hall, 3900 Main Street
Riverside, California 92522

DOC # 2011-0105226

03/08/2011 12:35P Fee:NC

Page 1 of 8

Recorded in Official Records

County of Riverside

Larry W. Ward

Assessor, County Clerk & Recorder



FREE RECORDING

This instrument is for the benefit
Of the City of Riverside and is
entitled to be recorded without
fee (Government Code §6103)

S	R	U	PAGE	SIZE	DA	MISC	LONG	RFD	COPY
			8						
M	A	L	465	426	PCOR	NCOR	SMF	NCH	EXAM
NCR16619						T:	CTY	UNI	700

APN: 215-152-012
Address: 4085 Vine Street

~~DX~~

D-16619



GRANT DEED

FOR VALUABLE CONSIDERATION, receipt of which is hereby acknowledged, THE REDEVELOPMENT AGENCY OF THE CITY OF RIVERSIDE, CALIFORNIA, a public body corporate and politic, as Grantor, does hereby grant to THE CITY OF RIVERSIDE, a California charter city and municipal corporation, the real property as granted to the Redevelopment Agency of the City of Riverside in Instrument 2007-0458682, recorded on 07/13/2007, located in the City of Riverside, County of Riverside, State of California.

Dated: March 7, 2011

THE REDEVELOPMENT AGENCY OF THE
CITY OF RIVERSIDE, a public body corporate
and politic

By:
Bradley J. Hudson, Executive Director

APPROVED AS TO FORM:

AGENCY GENERAL COUNSEL

Attest:
Colleen J. Nicol, Agency Secretary

GENERAL ACKNOWLEDGEMENT

State of California

ss

County of Riverside

On 3-7-11 before me Lisa Andresen, Notary Public

a Notary Public in and for said State, personally appeared

Bradley J. Hudson

Name(s) of Signer(s)

personally known to me OR proved to me on the basis of satisfactory evidence to be the person(s) whose name(s) is/are subscribed to the within instrument and acknowledged to me that he/she/they executed the same in his/her/their authorized capacity(ies), and that by his/her/their signature(s) on the instrument the person(s), or the entity upon behalf of which the person(s) acted, executed the instrument.

I certify under PENALTY OF PERJURY under the laws of the State of California that the foregoing paragraph is true and correct.

WITNESS my hand and official seal.

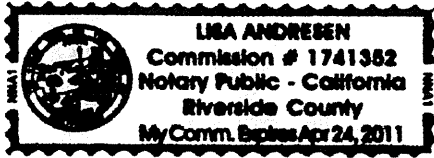

Lisa Andresen Signature

OPTIONAL SECTION

CAPACITY CLAIMED BY SIGNER

() Attorney-in-fact
() Corporate Officer(s)
Title
Title

() Guardian/Conservator
() Individual(s)
() Trustee(s)

() Other

() Partner(s)
() General
() Limited

The party(ies) executing this document is/are representing:



CALIFORNIA ALL-PURPOSE ACKNOWLEDGMENT

CIVIL CODE § 1189

State of California

County of Riverside

On March 7, 2011 before me, Sherry R. Morton, Notary Public
Date Here Insert Name and Title of the Officer

personally appeared Colleen J. Nicol
Name(s) of Signer(s)

who proved to me on the basis of satisfactory evidence to be the person(s) whose name(s) are subscribed to the within instrument and acknowledged to me that he/she/they executed the same in his/her/their authorized capacity(ies), and that by his/her/their signature(s) on the instrument the person(s), or the entity upon behalf of which the person(s) acted, executed the instrument.

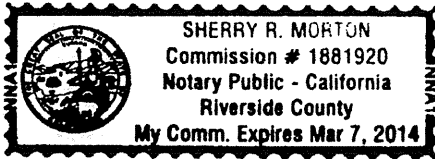

I certify under PENALTY OF PERJURY under the laws of the State of California that the foregoing paragraph is true and correct.

WITNESS my hand and official seal.

Signature: Sherry R. Morton
Signature of Notary Public

Place Notary Seal Above

OPTIONAL

Though the information below is not required by law, it may prove valuable to persons relying on the document and could prevent fraudulent removal and reattachment of this form to another document.

Description of Attached Document

Title or Type of Document: _____

Document Date: _____ Number of Pages: _____

Signer(s) Other Than Named Above: _____

Capacity(ies) Claimed by Signer(s)

Signer's Name: _____

- Corporate Officer — Title(s): _____
- Individual
- Partner — Limited General
- Attorney in Fact
- Trustee
- Guardian or Conservator
- Other: _____

Signer Is Representing: _____

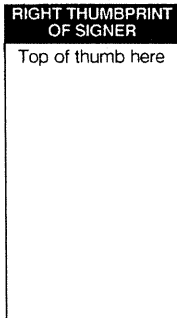

Signer's Name: _____

- Corporate Officer — Title(s): _____
- Individual
- Partner — Limited General
- Attorney in Fact
- Trustee
- Guardian or Conservator
- Other: _____

Signer Is Representing: _____

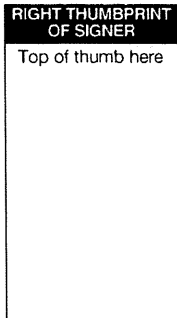

16619

**.CERTIFICATE OF ACCEPTANCE
(Government Code Section §27281)**

THIS IS TO CERTIFY that the interest in real property conveyed by the within instrument to the City of Riverside, a California charter city and municipal corporation, is hereby accepted by the undersigned officer on behalf of the City Council of said City pursuant to authority conferred by Resolution No. 21027 of said City Council adopted September 06, 2005 and the grantee consents to recordation thereof by its duly authorized officer.

Dated: March 7, 2011

CITY OF RIVERSIDE

By: 
Real Property Manager

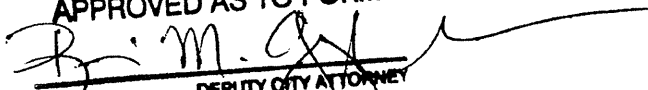
APPROVED AS TO FORM

DEPUTY CITY ATTORNEY



RECORDING REQUESTED BY
CHICAGO TITLE COMPANY
AND WHEN RECORDED MAIL TO

THE REDEVELOPMENT AGENCY
CITY OF RIVERSIDE
3900 MAIN STREET
RIVERSIDE, CA 92522

DOC # 2007-0458682
07/13/2007 08:00A Fee:NC
Page 1 of 5
Recorded in Official Records
County of Riverside
Larry H. Ward
Assessor, County Clerk & Recorder



S	R	U	PAGE	SIZE	DA	MISC	LONG	RFD	COPY
1			5						
M	A	L	465	426	PCOR	NCOB	SMF	NCHG	EXAM
							T:	CTY	UNI

ESCROW No. 602084703 - X55
Order No. 602084703K32
TRA 009-005

GRANT DEED

Assessor's Parcel No:
215-152-012

THE UNDERSIGNED GRANTOR(S) DECLARE(S)

DOCUMENTARY TRANSFER TAX IS \$- *Exempt*

unincorporated area City of RIVERSIDE

computed on the full value of the interest or property conveyed, or is

computed on the full value less the value of liens or encumbrances remaining at time of sale, and

FOR A VALUABLE CONSIDERATION, receipt of which is hereby acknowledged,

T 029

**ALLIE T. MALLAD; TRUSTEE OF THE ALLIE T. MALLAD 1990 LIVING TRUST,
WHO ACQUIRED TITLE AS ALLIE T. MALLAD LIVING TRUST**

hereby GRANT(S) to
THE REDEVELOPMENT AGENCY OF THE CITY OF RIVERSIDE

the following described real property in the City of RIVERSIDE
County of RIVERSIDE, State of California:

FULL LEGAL DESCRIPTION IS AS PER EXHIBIT "A" ATTACHED HERETO AND MADE A PART HEREOF

Dated June 18, 2007

STATE OF Michigan
COUNTY OF Oakland

On June 29, 2007 before me,

Jennifer L. Ellis

a Notary Public in and for said County and State, personally appeared

Allie T. Mallad

Allie T. Mallad, TRUSTEE
ALLIE T. MALLAD, TRUSTEE

personally known to me (or proved to me on the basis of satisfactory evidence) to be the person(s) whose name(s) is/are subscribed to the within instrument and acknowledged to me that he/she/they executed the same in his/her/their authorized capacity(ies), and that by his/her/their signature(s) on the instrument the person(s), or the entity upon behalf of which the person(s) acted, executed the instrument.

WITNESS my hand and official seal.

Jennifer L. Ellis
Signature of Notary

12/02/2011
Date My Commission Expires

JENNIFER L. ELLIS
Notary Public, Oakland County, Michigan
Acting in Oakland County
My Commission Expires 12/02/2011

FOR NOTARY SEAL OR STAMP

MAIL TAX STATEMENTS TO PARTY SHOWN ON FOLLOWING LINE: IF NO PARTY SO SHOWN, MAIL AS DIRECTED ABOVE

Name

Street Address

City, State & Zip

0D1 -05/30/07b1



16619



LARRY W. WARD
COUNTY OF RIVERSIDE
ASSESSOR-COUNTY CLERK-RECORDER

Recorder
P.O. Box 751
Riverside, CA 92502-0751
(951) 486-7000
<http://riverside.asrcrkcc.com>

NOTARY CLARITY

Under the provisions of Government Code 27361.7, I certify under the penalty of perjury that the notary seal on the document to which this statement is attached reads as follows:

Name of Notary: Jennifer L. Ellis

Commission #: _____

Place of Execution: Oakland

Date Commission Expires: 12-02-11

Date: 7-11-07

Signature: Maryl Antinora

Print Name: Maryl C. Antinora



16619

GENERAL ACKNOWLEDGEMENT

OPTIONAL SECTION

State of California
County of _____ ss
On _____, before me _____
(date) (name)

CAPACITY CLAIMED BY SIGNER

- () Attorney-in-fact
- () Corporate Officer(s)
- Title _____
- Title _____
- () Guardian/Conservator
- () Individual(s)
- () Trustee(s)
- () Other
- () Partner(s)
- () General
- () Limited

a Notary Public in and for said State, personally appeared

Name(s) of Signer(s)

personally known to me - OR - proved to me on the basis of satisfactory evidence to be the person(s) whose name(s) is/are subscribed to the within instrument and acknowledged to me that he/she/they executed the same in his/her/their authorized capacity(ies), and that by his/her/their signature(s) on the instrument the person(s), or the entity upon behalf of which the person(s) acted, executed the instrument.

WITNESS my hand and official seal.

Signature

The party(ies) executing this document is/are representing:

**CERTIFICATE OF ACCEPTANCE
(Government Code Section §27281)**

THIS IS TO CERTIFY that the interest in real property conveyed by the within instrument to The Redevelopment Agency of the City of Riverside, California, a public body, corporate and politic, is hereby accepted by the undersigned officer on behalf said Agency pursuant to authority conferred by Resolution No. 775 of said Agency adopted September 6, 2005, and the grantee consents to recordation thereof by its duly authorized officer.

Dated 7/12/07

**REDEVELOPMENT AGENCY OF THE
CITY OF RIVERSIDE**

By: Amelia M. Vailin

Print Name: Amelia M. Vailin

APPROVED AS TO FORM:

L.Andresen
7/3/2007
G:\Real_Property\DOCS\Ward 2\07-2-127- GtDeed.doc

[Signature]
AGENCY GENERAL COUNSEL
Page 2



EXHIBIT A

APN 215-152-012
FEE SIMPLE INTEREST

THAT CERTAIN REAL PROPERTY IN THE CITY OF RIVERSIDE, COUNTY OF RIVERSIDE, BEING THOSE PORTIONS OF PARCELS 2 AND 3 OF PARCEL MAP 26301, AS SHOWN BY MAP ON FILE IN BOOK 176 PAGES 72 THROUGH 81, INCLUSIVE, OF PARCEL MAPS, RECORDS OF RIVERSIDE COUNTY, CALIFORNIA, DESCRIBED AS FOLLOWS:

COMMENCING AT THE MOST EASTERLY CORNER OF PARCEL 4;

THENCE ALONG THE SOUTHEASTERLY LINE OF PARCEL 4 AND PARCEL 3 AND THE NORTHWESTERLY LINE OF VINE STREET, SOUTH 28° 52' 29" WEST, 218.21 FEET TO THE TRUE POINT OF BEGINNING;

THENCE NORTH 61°07' 31" WEST, 139.24 FEET;

THENCE SOUTH 28° 56' 43" WEST, 178.41 FEET TO THE SOUTHWESTERLY LINE OF PARCEL 2;

THENCE ALONG THE SOUTHWESTERLY LINE OF SAID PARCEL 2, SOUTH 61° 10' 05" EAST, 139.46 FEET TO A POINT IN THE NORTHWESTERLY LINE OF VINE STREET;

THENCE ALONG VINE STREET, NORTH 28° 52' 29" EAST, 178.31 FEET TO THE POINT OF BEGINNING.

This description was prepared by me or under my direction in conformance with the requirements of the Land Surveyors Act.

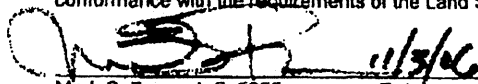
Mark S. Brown, L.S. 5655 Date: 11/3/06 Prep. _____
License Expires 9/30/07



APN 215-152-012 Deed.doc



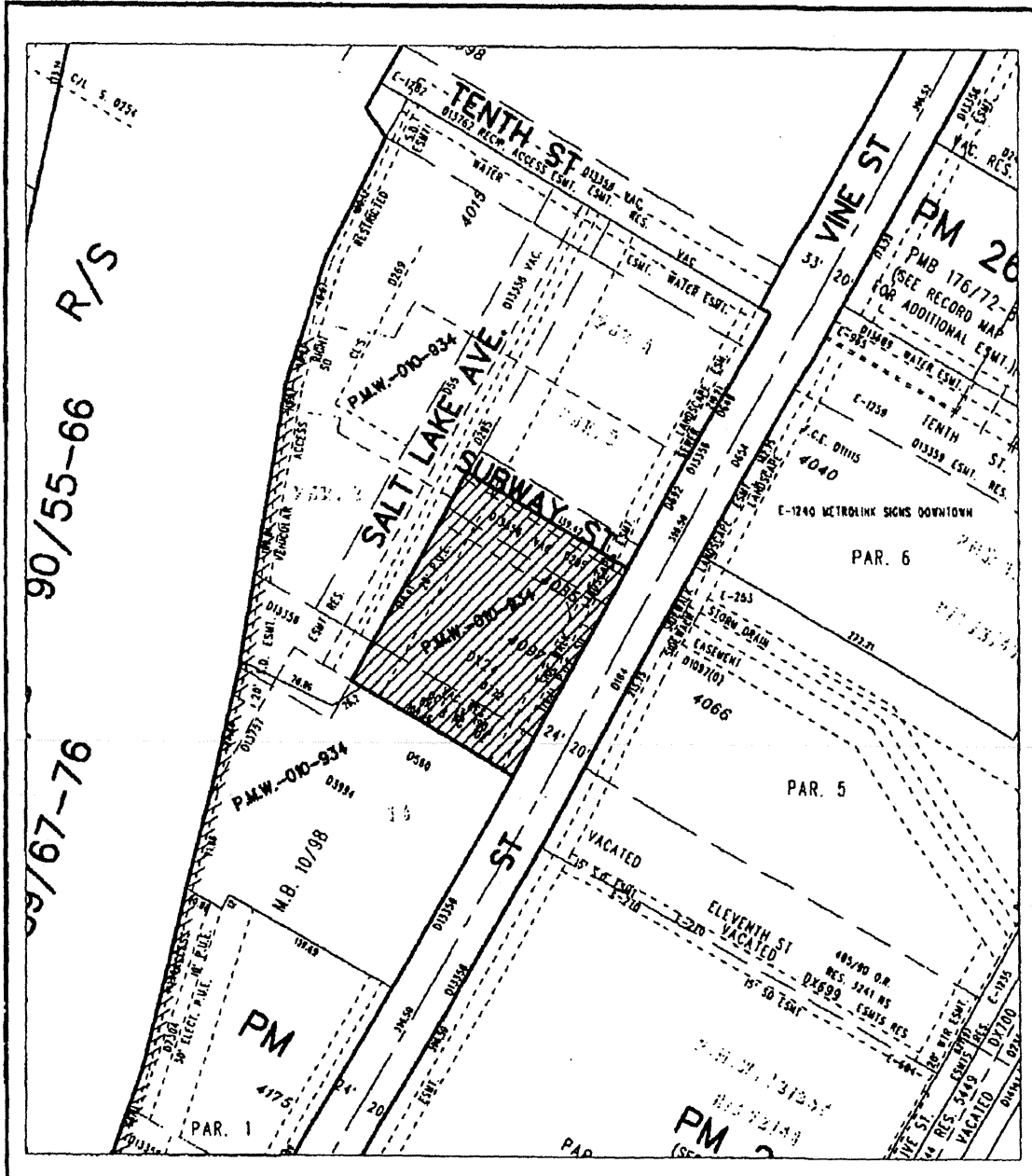

◆ CITY OF RIVERSIDE, CALIFORNIA ◆

THIS PLAT IS SOLELY AN AID IN LOCATING THE PARCEL(S) DESCRIBED IN THE ATTACHED DOCUMENT. IT IS NOT A PART OF THE WRITTEN DESCRIPTION THEREIN.

Sheet 1 of 1



Scale: 1" = 100'

Drawn by: bmark

Date: 11/03/06

Subject: RTA Transit Center

10619

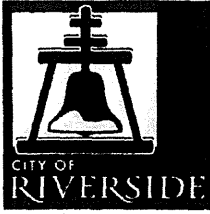

Request for City Attorney Services
GroupWise Address: City Attorney Services

To: Gregory P. Priamos
City Attorney

Date: 3/3/11

From: Natarkia Williams
Senior Office Specialist

Telephone Number: 5461

Subject: Redevelopment Grant Deed Out
APN: 215-152-012

Fax Number: 5744

Needed by (date): 3/4/11- RUSH

City Council action scheduled for (meeting date): _____

Please review

Instruction and back-up information attached

Please prepare: _____

Please "approve as to form" and forward to City Clerk's Office for execution

Please contact me if you have any questions or need further information at ext: 5461

Other comments: _____

Supervisor's Approval: *James M. Paul*