

DOC # 2012-0421475

09/05/2012 08:26A Fee:NC

Page 1 of 7

Recorded in Official Records
County of Riverside

Larry W. Ward

Assessor, County Clerk & Recorder

PLEASE COMPLETE THIS INFORMATION
RECORDING REQUESTED BY:

Colleen J. Nicol, MMC

AND WHEN RECORDED MAIL TO:

City Clerk
City of Riverside
3900 Main St.
Riverside, CA 92522
FREE RECORDING-
Exempt Pursuant to
Government Code S6103



S	R	U	PAGE	SIZE	DA	MISC	LONG	RF-D	COPY
1			7						
M	A	L	465	426	PCOR	NCOR	SMF	NCHG	EXAM
CONC#6						T:	CTY	UNI	517

517
C
517

SPACE ABOVE FOR RECORDERS USE ONLY

RESOLUTION NO. 21420

Title of Document

D- 16821

**THIS AREA FOR
RECORDER'S
USE ONLY**

THIS PAGE ADDED TO PROVIDE ADEQUATE SPACE FOR RECORDING INFORMATION
(\$3.00 Additional Recording Fee Applies)

16821

1
2
3
4
5
6
7
8
9
10
11
12
13
14
15
16
17
18
19
20
21
22
23
24
25
26
27
28

RESOLUTION NO. 21420

A RESOLUTION OF THE CITY COUNCIL OF RIVERSIDE, CALIFORNIA, MAKING ITS FINDINGS AND DETERMINATIONS IN THE MATTER OF RESOLUTION OF INTENTION NO. 21382; AND MAKING ITS ORDER VACATING A PORTION OF CAMPUS PARKWAY, INCLUDING SIDEWALK AND LANDSCAPE EASEMENT, IN RIVERSIDE, CALIFORNIA.

WHEREAS, on April 17, 2007, the City Council of the City of Riverside in Planning Case No. P03-1213 adopted Resolution No. 21382 declaring its intention to order a portion of Campus Parkway, including sidewalk and landscape easement, vacated, located westerly of Corporate Centre Place, within the City of Riverside, California, and fixing the time and place of hearing all persons interested in the proposed vacation pursuant to the provisions of the Public Streets, Highways and Service Easements Vacation Law, being Sections 8300 et seq. of Part 3, Division 9 of the Streets and Highways Code of the State of California; and

WHEREAS, notice of hearing before the City Council on said resolution of intention was duly given as provided by said Public Streets, Highways, and Service Easements Vacation Law; and

WHEREAS, said proposed vacation had been previously submitted to and considered by the Planning Commission of the City of Riverside at a duly noticed public hearing held on March 22, 2007; and

WHEREAS, following the close of the public hearing before the Planning Commission, the Planning Commission determined that the proposed vacation would not have a significant effect on the environment, and recommended that Planning Case No. P03-1213 should be approved subject to all staff conditions; and

WHEREAS, the recommendations of the Planning Commission were submitted to the City Council for consideration together with the testimony, whether oral or in writing, presented at the public hearing before said City Council; and

WHEREAS, the City Council heard and found and determined from all of the evidence submitted to said Council on the day fixed for the hearing, on June 12, 2007, that the portion of Campus Parkway, westerly of Corporate Centre Place, within the City of Riverside, proposed for



1 vacation was unnecessary for present or prospective public use, including the sidewalk and
2 landscape easement;

3 NOW, THEREFORE, IT IS RESOLVED, FOUND and DETERMINED by the City
4 Council of the City of Riverside, California, as follows:

5 Section 1: That a portion of Campus Parkway, westerly of Corporate Centre Place,
6 within the City of Riverside, in Planning case P03-1213 is undertaken pursuant to the provisions
7 of and in accordance with the procedures set forth in the Public Streets, Highways, and Service
8 Easements Vacation Law, Sections 8300 et seq., and all notices required thereby have been duly
9 given.

10 Section 2: That from all evidence submitted to the City Council at the June 12, 2007,
11 public hearing before it on Planning Case P03-1213, whether such evidence was oral or in
12 writing, together with the recommendations from the Planning Commission, a portion of Campus
13 Parkway, westerly of Corporate Centre Place, within the City of Riverside, California, as
14 hereinafter described and ordered vacated is unnecessary for present or prospective public use as
15 a public street, sidewalk or landscaping.

16 Section 3: That the portion of Campus Parkway, including the sidewalk and landscape
17 easement, westerly of Corporate Centre Place, within the City of Riverside, California, and
18 described and depicted in attached Exhibit "A", and by this reference made a part hereof, be and
19 the same is hereby ordered vacated.

20 Section 4: That the public convenience and necessity requires the exception of the
21 following easements and rights-of-way from the vacation hereinabove ordered: an easement for
22 electrical energy underground facilities; including water pipelines, gas lines, storm drains,
23 sanitary sewers, telephone, telegraph and communications structures, the right to construct,
24 place, inspect, operate, maintain, repair, replace and remove such underground facilities unless
25 said facilities are satisfactorily relocated and/or abandoned, further, that the public convenience
26 and necessity require the exception and reservation from the vacation of those easements and
27 rights-of-way in, under, across, upon, over and along that portion of a public street ordered to be
28



1 vacated necessary to maintain, operate, remove or renew any in-place public utility facilities that
2 are in use and not otherwise excepted and reserved hereinabove.

3 Section 5: That the vacation, termination and abandonment of that portion of a public
4 street described and depicted in Exhibit "A" shall occur only after the applicable conditions
5 contained in the Planning Department's report to the City Council and on file with the City
6 Clerk, as approved or amended by the City Council, have been satisfied, and the City Clerk is
7 hereby directed not to record this resolution of vacation until the applicable conditions have been
8 satisfied.

9 Section 6: That in connection with the vacation of a portion of Campus Parkway and the
10 corresponding Super Wal-Mart project, an EIR was prepared and certified by the City Council.

11 Section 7: That the City Clerk of the City of Riverside shall cause a certified copy of this
12 resolution to be recorded in the Office of the County Recorder of the County of Riverside,
13 California, upon the satisfaction of the applicable conditions, and a portion of the public street
14 described and depicted in Exhibit "A" shall no longer constitute a public street from and after the
15 date of recordation.

16 ADOPTED by the City Council and signed by the Mayor and attested by the City Clerk
17 this 12th day of June, 2007.

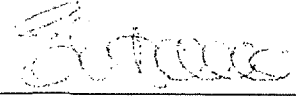

Mayor Pro Tempore of the City of Riverside
By [Signature]

18
19
20 ATTEST:

21 *[Signature]*
22 _____
23 City Clerk of the City of Riverside

24 ///
25 ///
26 ///
27 ///
28





1
2
3
4
5
6
7
8
9
10
11
12
13
14
15
16
17
18
19
20
21
22
23
24
25
26
27
28

I, Colleen J. Nicol, City Clerk of the City of Riverside, California, hereby certify that the foregoing resolution was duly and regularly introduced at a meeting of the City Council on the 12th day of June, 2007, by the following vote, to wit:

Ayes: Councilmembers Gage, Schiavone, Adkison, and Hart

Noes: Councilmember Melendrez

Abstain: None

Absent: Councilmembers Betro and Adams

IN WITNESS WHEREOF I have hereunto set my hand and affixed the official seal of the City of Riverside, California, this 12th day of June, 2007.



City Clerk of the City of Riverside

O:\Cycom\WPDocs\D030\005\00081924.doc
CA: 07-0741
05/30/07



EXHIBIT A
STREET AND HIGHWAY VACATION

PORTION LOT G
CAMPUS PARKWAY

THAT CERTAIN REAL PROPERTY IN THE CITY OF RIVERSIDE, COUNTY OF RIVERSIDE, STATE OF CALIFORNIA DESCRIBED AS FOLLOWS:

THAT PORTION OF LOT G, CAMPUS PARKWAY, AND THOSE PORTIONS OF THE SIDEWALK, STREET TREE, AND LANDSCAPING EASEMENTS ADJACENT TO SAID LOT G, AS SHOWN ON PARCEL MAP 19617 ON FILE IN PARCEL MAP BOOK 128, PAGES 91 THROUGH 103 THEREOF, RECORDS OF SAID RIVERSIDE COUNTY, LYING NORTHWESTERLY OF A LINE THAT IS PARALLEL AND 55 FEET NORTHWESTERLY AS MEASURED AT RIGHT ANGLES FROM THE CENTERLINE OF LOTS I AND J, CORPORATE CENTRE PLACE, (FORMERLY RIVERIDGE DRIVE) AS SHOWN ON SAID MAP.

This description was prepared by me or under my direction in conformance with the requirements of the Land Surveyors Act.

Date 4/2/07 Prep. _____

Mark S. Brown, L.S. 5655
License Expires 9/30/07



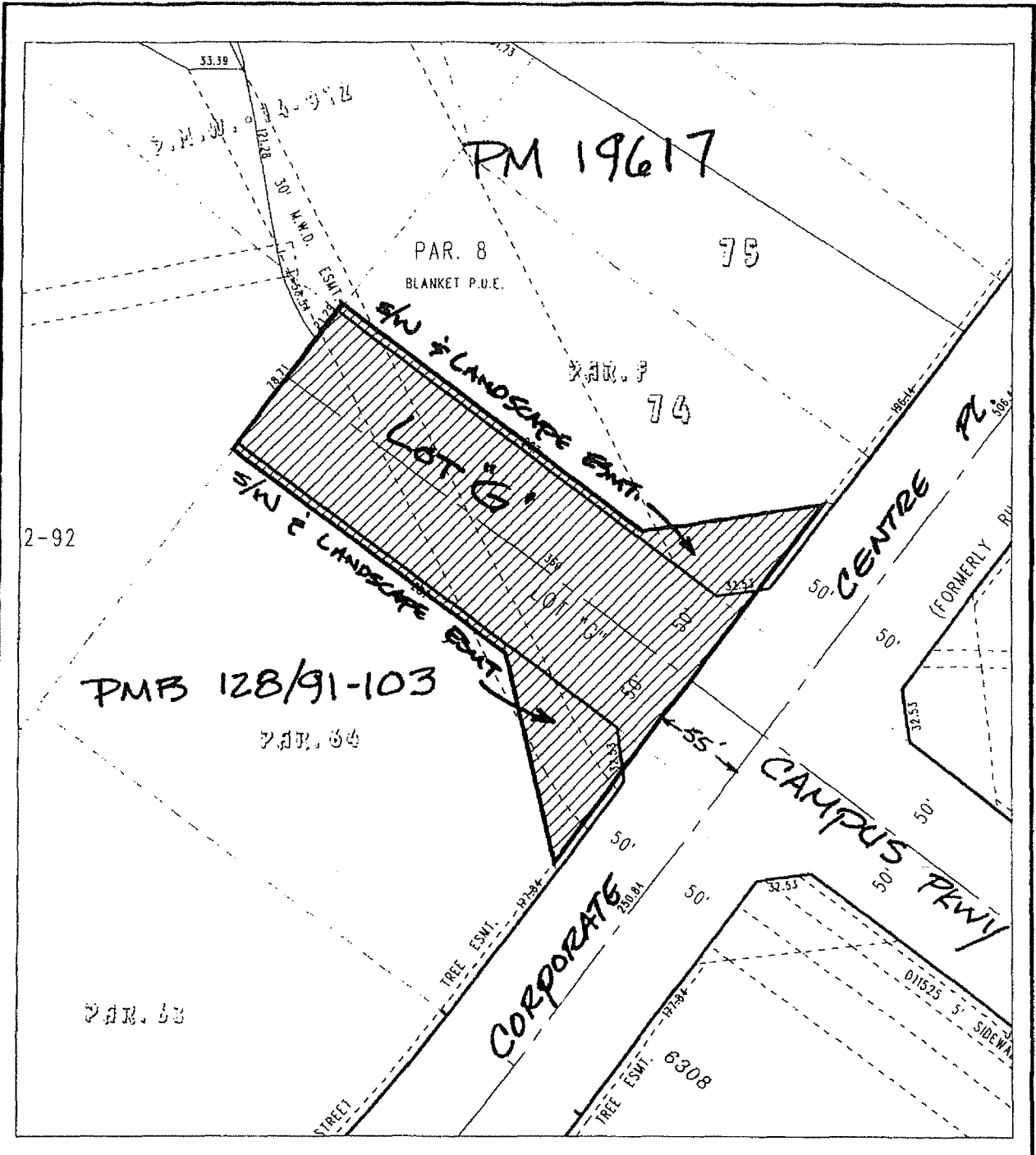

◆ CITY OF RIVERSIDE, CALIFORNIA ◆

THIS PLAT IS SOLELY AN AID IN LOCATING THE PARCEL(S) DESCRIBED IN THE ATTACHED DOCUMENT. IT IS NOT A PART OF THE WRITTEN DESCRIPTION THEREIN.		Sheet 1 of 1
Scale: 1" = 80'	Drawn by: bmark	Date: 04/03/07
Subject: Campus Pkwy - Vacation		

The foregoing instrument is certified, under penalty of perjury, to be a correct copy of the original on file in this office.

 Colleen J. Nicol, City Clerk
 City of Riverside, California

Executed on Sept. 4 2012 at
 Riverside, California



2012-0421475
 09/05/2012 08:26A
 2 of 7

16821