

When recorded mail to:

City Clerk's Office  
City of Riverside  
City Hall, 3900 Main Street  
Riverside, California 92522

**FREE RECORDING**

This instrument is for the benefit of the City of Riverside and is entitled to be recorded without fee (Government Code §6103)

**2019-0372257**

09/20/2019 03:07 PM Fee: \$ 0.00

Page 1 of 5

Recorded in Official Records  
County of Riverside  
Peter Aldana  
Assessor-County Clerk-Recorder



4080

FOR RECORDER'S OFFICE USE ONLY

Por. A.P.N.: 132-020-038  
Address: 11621 Sterling Avenue

**D- 17549**

**E A S E M E N T**

**FOR VALUABLE CONSIDERATION**, receipt of which is hereby acknowledged, **WESTERN MUNICIPAL WATER DISTRICT**, a **municipal water district**, as Grantor(s), grant(s) to the **CITY OF RIVERSIDE**, a **California charter city and municipal corporation**, as Grantee, its successors and assigns, an easement and right-of-way for the construction, reconstruction, maintenance, operation, inspection, repair, replacement, relocation, renewal and removal of **ELECTRIC ENERGY DISTRIBUTION AND TELECOMMUNICATION FACILITIES**, together with all necessary appurtenances, in, under, upon, over and along that certain real property described in **EXHIBIT "A"** attached hereto and incorporated herein by this reference, located in the City of Riverside, County of Riverside, State of California.

**TOGETHER WITH** the right to clear and keep clear said easement and right-of-way from any structures or trees, to enter upon and to pass and repass over and along said real property, and to deposit tools, implements and other material thereon by Grantee, its officers, agents and employees and by persons under contract with said Grantee and their officers, agents and employees, whenever and wherever necessary for the purpose of constructing, reconstructing, maintaining, operating, inspecting, repairing, replacing, relocating, renewing and removing said **ELECTRIC ENERGY DISTRIBUTION AND TELECOMMUNICATION FACILITIES**.

**CERTIFICATE OF ACCEPTANCE  
(Government Code Section §27281)**

THIS IS TO CERTIFY that the interest in real property conveyed by the within instrument to the City of Riverside, a California charter city and municipal corporation, is hereby accepted by the undersigned officer on behalf of the City Council of said City pursuant to authority conferred by Resolution No. 23439 of said City Council adopted May 14th, 2019, and the grantee consents to recordation thereof by its duly authorized officer.

DATED September 19, 2019

CITY OF RIVERSIDE

By: \_\_\_\_\_

  
David Welch  
Community & Economic  
Development Director

Approved as to Form

By: \_\_\_\_\_

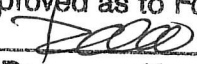
  
Rosemary Koo  
Senior Deputy City Attorney

Dated \_\_\_\_\_

**Western Municipal Water District,  
a municipal water district**

By: \_\_\_\_\_

By: Craig D. Miller

Print Name: \_\_\_\_\_

Print Name: Craig D. Miller

Title: \_\_\_\_\_

Title: General Manager

**ACKNOWLEDGMENT**

A notary public or other officer completing this certificate verifies only the identity of the individual who signed the document to which this certificate is attached, and not the truthfulness, accuracy, or validity of that document.

State of California

County of Riverside } ss

On September 17, 2019, before me, Jean Marie Perry, Notary Public,  
notary public, personally appeared, Craig D. Miller

who proved to me on the basis of satisfactory evidence to be the person(s) whose name(s) is/are subscribed to the within instrument and acknowledged to me that he/she/they executed the same in his/her/their authorized capacity(ies), and that by his/her/their signature(s) on the instrument the person(s), or the entity upon behalf of which the person(s) acted, executed the instrument.

I certify under PENALTY OF PERJURY under the laws of the State of California that the foregoing paragraph is true and correct.

WITNESS my hand and official seal.



Jean Marie Perry  
Notary Signature

**EXHIBIT "A"**  
**LEGAL DESCRIPTION**

Por. A.P.N.: 132-020-038  
Address: 11621 Sterling Avenue

That certain real property located in the City of Riverside, County of Riverside, State of California, being a portion of Parcel 1 of Parcel Map No. 23562 as shown by map on file in Book 173, pages 23 and 24 of Parcel Maps, Records of Riverside County, California, described as follows:

**BEGINNING** at the northwest corner of said Parcel 1;

Thence South 34°00'00" East, along the southwest line of said Parcel 1, a distance of 23.00 feet;

Thence South 87°49'52" East, a distance of 13.00 feet;

Thence North 02°10'08" East, a distance of 19.34 feet to a point on the north line of said Parcel 1 and the beginning of a non-tangent curve concave south, having a radius of 500.00 feet, a radial line to said point bears North 02°01'42" East;

THENCE Westerly to the left along said curve and said north line an arc length of 26.59 feet, through a central angle of 03°02'48" to the **POINT OF BEGINNING**.

Area - 381 square feet, more or less

This description was prepared by me or under my direction in conformance with the requirements of the Land Surveyors Act.

Curtis C. Stephens 8/15/19 Prep. (3)  
Curtis C. Stephens, L.S. 7519 Date



| CURVE DATA |         |        |          |
|------------|---------|--------|----------|
| SYM        | RAD     | LENGTH | DELTA    |
| C1         | 500.00' | 26.59' | 3°02'48" |

| LINE DATA |        |             |
|-----------|--------|-------------|
| SYM       | LENGTH | BEARING     |
| L1        | 23.00' | S34°00'00"E |
| L2        | 13.00' | S87°49'52"E |
| L3        | 19.34' | N02°10'08"E |

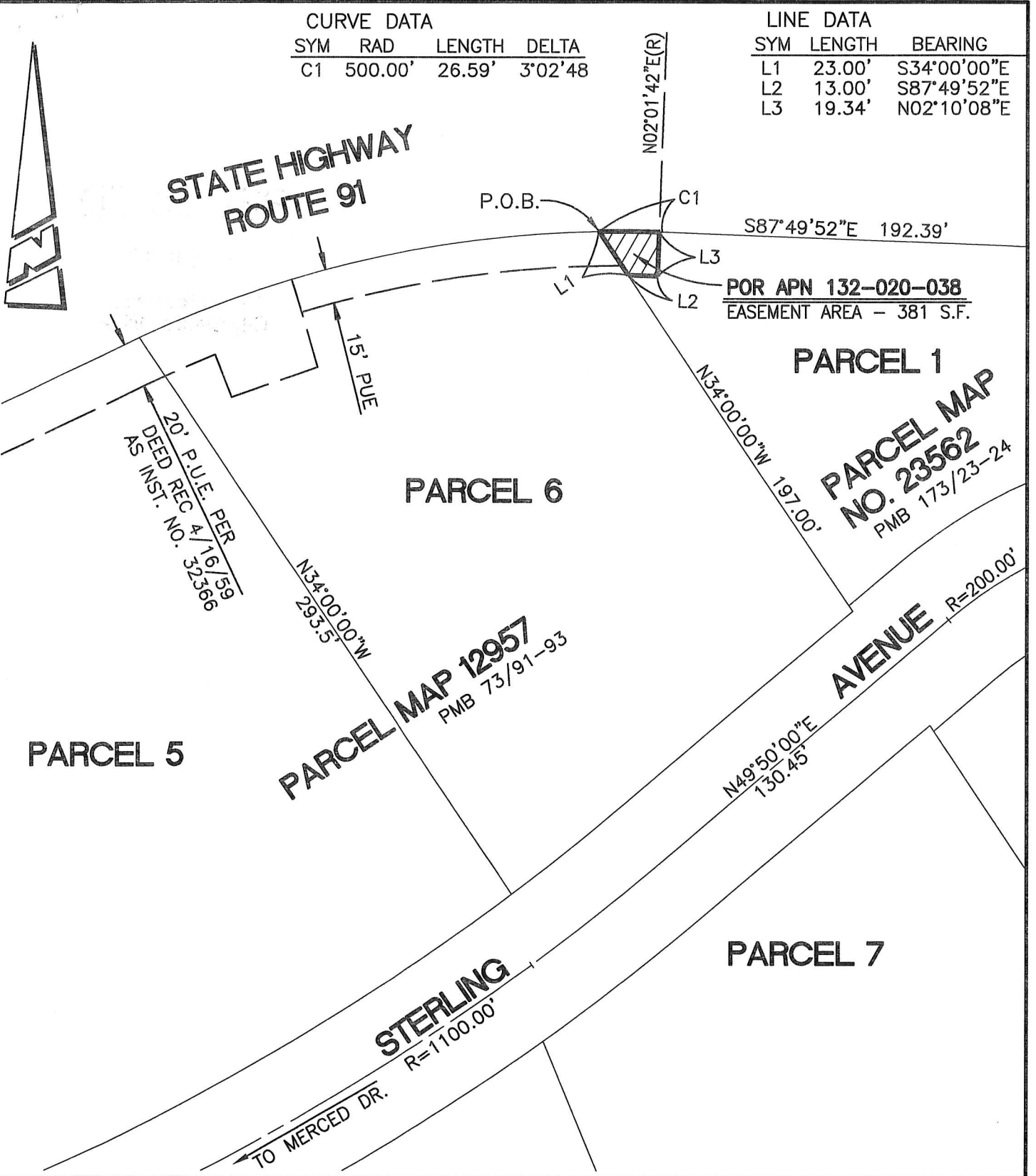

• CITY OF RIVERSIDE, CALIFORNIA •

THIS PLAT IS SOLELY AN AID IN LOCATING THE PARCEL(S) DESCRIBED IN THE ATTACHED DOCUMENT. IT IS NOT A PART OF THE WRITTEN DESCRIPTION THEREIN.

SHEET 1 OF 1

SCALE: 1"=60'

DRAWN BY: CURT

DATE: 5/22/19

SUBJECT: 132-020-038 - 11621 STERLING AVE - P..U.E.