

E A S E M E N T

THIS INSTRUMENT, made this 13 day of July, 19 60

by and between ~~WALLACE E. BOYER and BARBARA BOYER, husband and wife,~~

L. ELDEN SMITH and HARRIET F. SMITH, husband and wife,

part ies of the first part and the CITY OF RIVERSIDE, a municipal corporation of the State of California, the party of the second part;

WITNESSETH:

THAT for a valuable consideration, receipt whereof is hereby acknowledged, said part ies of the first part do _____ by these presents grant unto the said party of the second part, its successors and assigns, a perpetual easement and right-of-way for the construction, reconstruction, inspection, maintenance, operation and repair of a sanitary sewer, together with manholes, cleanouts, wye branches and other necessary appurtenances, all hereinafter referred to collectively as "structure", in, under and along that certain parcel of land situated in the County of Riverside, State of California, described as follows:

All that portion of Lot 42 of Castleman's Addition, as shown by map on file in Book 3, page 19 of Maps, Records of San Bernardino County, California, more particularly described as follows:

A uniform strip of land, 10.00 feet in width, lying 5.00 feet, measured at a right angle, on either side of the following described center line;

Beginning at the intersection of the center lines of Ottawa Avenue and Prince Albert Drive, as shown on map of Victoria Estates on file in Book 24, page 58 of Maps, Records of Riverside County, California.

Thence South 00° 18' 50" West along the Southerly prolongation of the center line of Ottawa Avenue, 3.90 feet; thence South 75° 57' 29" East 71.57 feet; thence South 67° 49' 50" East 319.25 feet; thence North 70° 42' 20" East 315.06 feet to an end on the East line of said Lot 42, distant thereon 0.25 feet Northarly of the intersection of the center line of Prince Albert Drive with the said East line of Lot 42, as shown on map of Sunset Heights on file in Book 23, page 10 of Maps, Records of said Riverside County.

EXCEPTING THEREFROM that portion within Ottawa Avenue.

The sidelines of said strip to be lengthened or shortened to terminate Westerly on the Easterly line of Ottawa Avenue, and Easterly on the East line of said Lot 42.

TOGETHER WITH the right to enter upon and to pass and repass over and along said strip of land, and to deposit tools, implements, and other materials thereon by said party of the second part, its officers, agents and employees, and by persons

RECORDED Aug. 5, 1960
BOOK 2744 PAGE 590
OFFICIAL RECORDS, RIV. CO.
INSTRUMENT NO. 69294.

under contract with it and their employees, whenever and wherever necessary for the purpose of constructing, reconstructing, inspecting, maintaining, operating or repairing said structure.

IN WITNESS WHEREOF the said parties of the first part have hereunto executed the within instrument the day and year first above written.

RECORDED Aug. 5, 1960
BOOK 2744 PAGE 590
OFFICIAL RECORDS, RIV. CO.
INSTRUMENT NO. 69294

~~Wallace E. Boyer~~
~~Barbara Boyer~~
(S)
L. Elden Smith
(S)
Harriet F. Smith

CITY OF RIVERSIDE

VICTORIA

LOT 42
CASTLEMAN'S ADDITION
M.B. 3/19, Rec. S. B. Co.

SANITARY SEWER EASEMENT
TO BE ACQUIRED
PLAT

ESTATES

PRINCE ALBERT KNOLLS
(PROPOSED)

SUNSET

13

HEIGHS

10

PRINCE ALBERT KNOLLS (PROPOSED)

☉ SANITARY SEWER
☉ PROPOSED 66' STREET
20' WORKING EASEMENT
20' WORKING EASEMENT
10' EASEMENT, 5' EACH SIDE
OF ☉ OF SEWER.

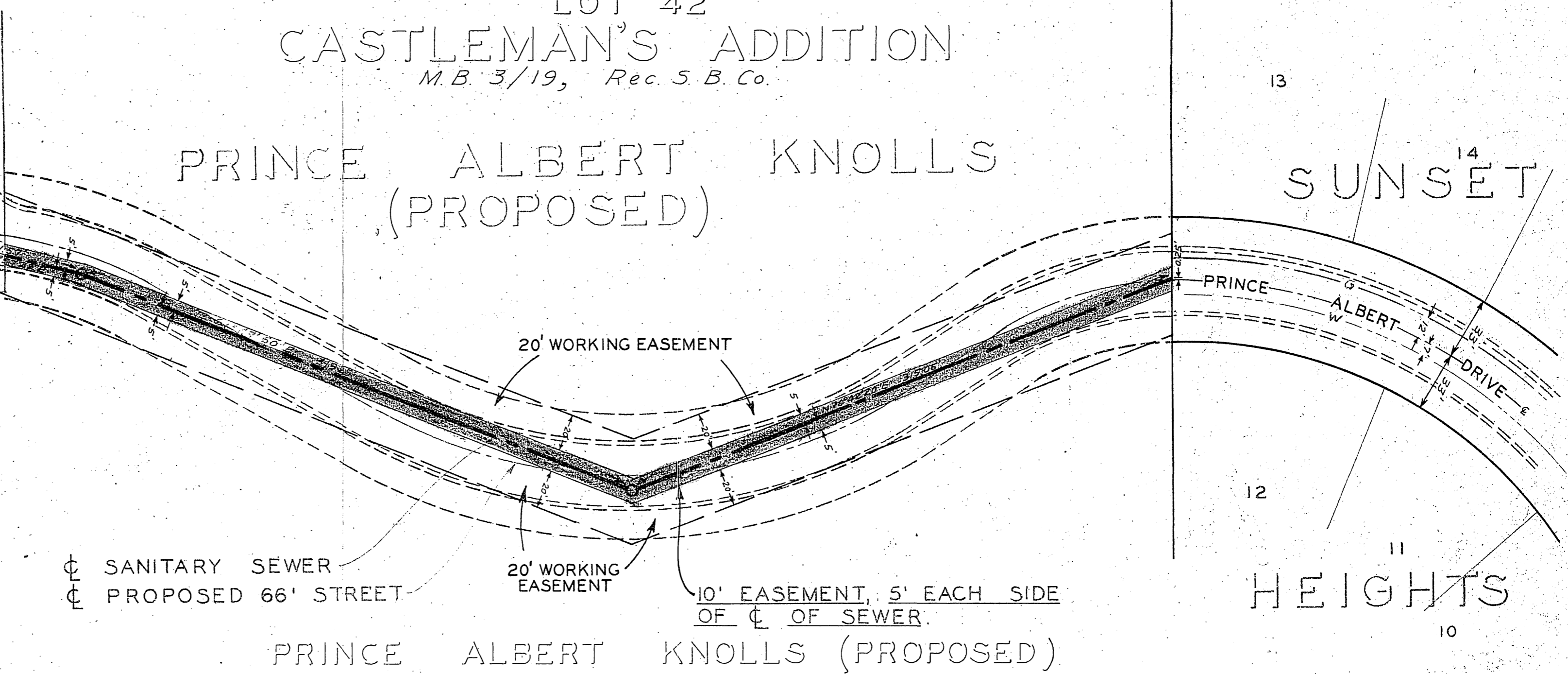
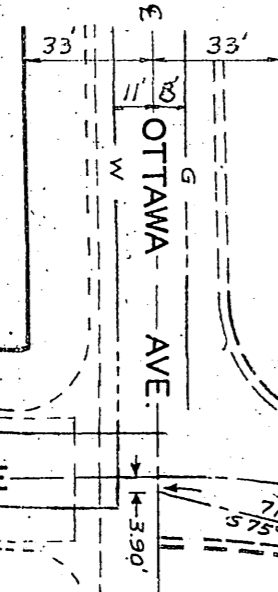

RECORDED Aug. 5, 1960
BOOK 2744 PAGE 590
OFFICIAL RECORDS, RIV. CO.
INSTRUMENT NO. 69294

DRAWN MAY 13, 1960

3768