

FILE

GRANT DEED

BEN H. LEWIS and CATHERINE D. LEWIS, husband and wife;
HUGH E. MURRAY and ANNABELL J. MURRAY, husband and wife;
CHARLES R. LEWSADER and EVELYN M. LEWSADER, husband and wife;
PATRICK O. BRAWLEY and BELLA A. BRAWLEY, husband and wife;
JAMES H. HARNAGE and PATRICIA ANN HARNAGE, husband and wife, (Grantor - Grantors)

FOR A VALUABLE CONSIDERATION, receipt of which is hereby acknowledged, do _____ hereby grant to the CITY OF RIVERSIDE, a municipal corporation, the real property in the City of Riverside, County of Riverside, State of California, described as follows: --

The Southeasterly 2.50 feet of the Northwesterly 157.5 feet of the Northeasterly 140 feet of Range 5, Block 3 of the Town of Riverside as shown by map on file in Book 7, page 17 of Maps, Records of San Bernardino County, California.

EXCEPTING THEREFROM the Northeasterly 80 feet.

For public street purposes.

Dated October 5, 1960

(S)
Ben H. Lewis

(S)
Catherine D. Lewis

(S)
Hugh E. Murray

(S)
Annabell J. Murray

(S)
Charles R. Lewsader

(S)
Evelyn M. Lewsader

(S)
Patrick O. Brawley
(S) Bella A. aka Bella A.
Bella A. Brawley

(S) James H. Harnage Jr.
James H. Harnage Jr.

(S)
Patricia Ann Harnage

RECORDED 12-16-1960
BOOK 2817 PAGE 30
OFFICIAL RECORDS, RIV. CO.
INSTRUMENT NO. 106405

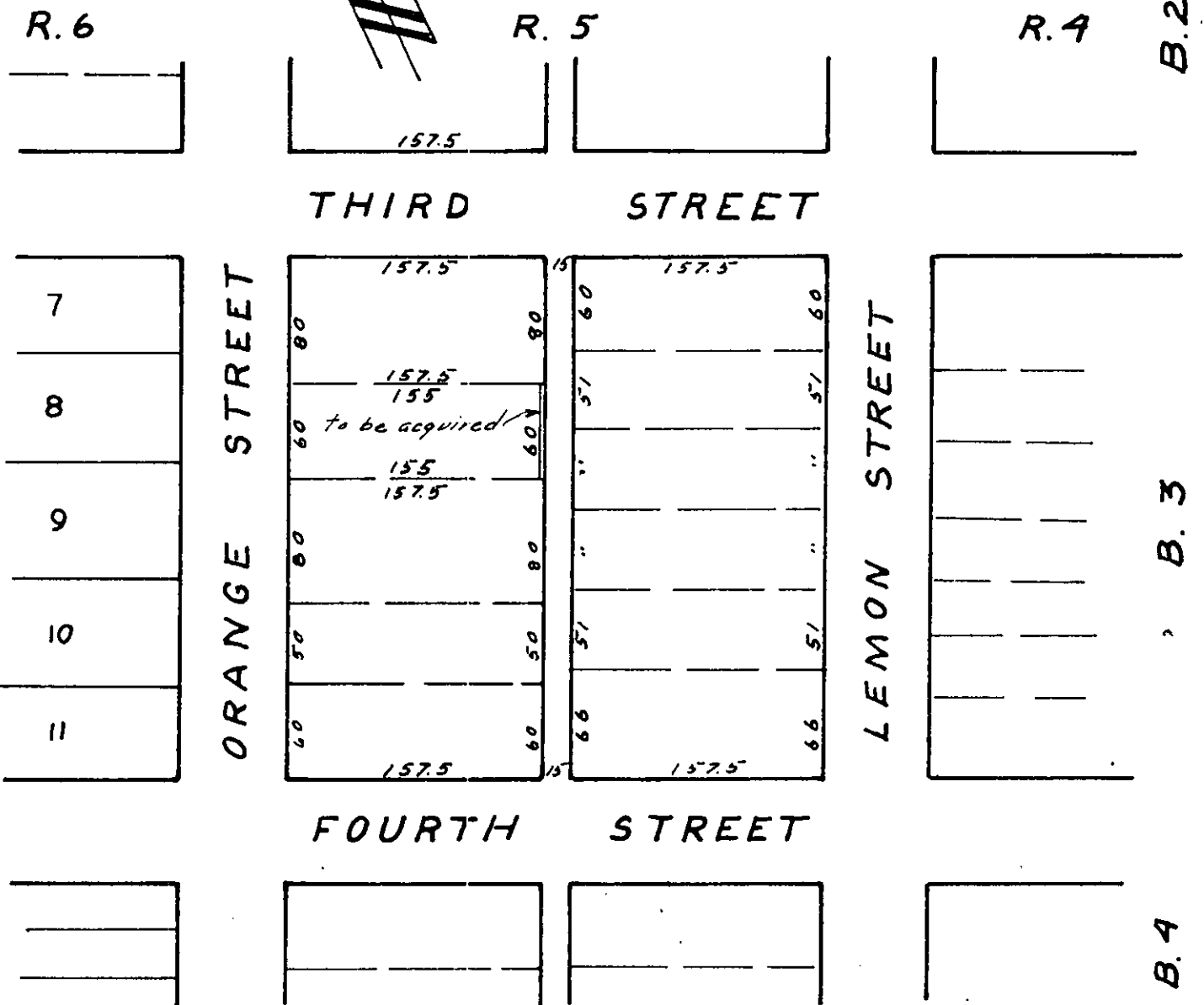
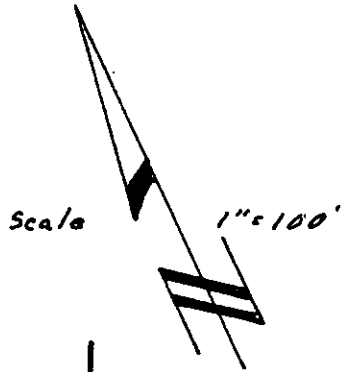

TOWN OF RIVERSIDE M.B. 7/17 S.B. Co.

PLAT

LAND TO BE ACQUIRED
FOR ALLEY PURPOSES