

EASEMENT

THIS INDENTURE, made this 8<sup>th</sup> day of April, 19 63

by and between ~~FREDERICK WILLIAM BRAUN and IDA L. BRAUN, husband and wife,~~  
and ELLSWORTH WELLINGTON BRAUN, a single man, as their respective interests  
appear of record,  
part ies of the first part, and the CITY OF RIVERSIDE, a municipal corporation  
of the State of California, the party of the second part.

WITNESSETH:

THAT for a valuable consideration, receipt whereof is hereby  
acknowledged, said part ies of the first part do \_\_\_ by these presents grant  
unto the said party of the second part, its successors and assigns, an  
easement and right of way for the construction, maintenance, operation,  
inspection, repair, replacement, and removal of electric lines and cables,  
including such additional lines as said grantee may from time to time in  
the future require, upon and by means of one line of poles, with supporting  
structures, crossarms, wires, anchors, fixtures, and appurtenances, for  
the transmission of electric energy for any and all purposes for which the  
same may be used, and communication purposes upon, over, and across that  
certain real property situated in the County of Riverside, State of California,  
described as follows:

**The northerly 17 feet of Lot 30 of Castleman's Addition per map  
on file in Book 3, page 19, of Maps, Records of San Bernardino County,  
California.**

TOGETHER WITH the right of entry upon said premises over and  
across which said easement and right of way is granted, for the purposes of

3/24-1 RK

4608

installing, maintaining and repairing said poles, lines, wires and equipment; provided, however, that the grantor s reserve \_\_\_ the right to use and enjoy the land over which said easement and right of way is granted, for any purpose and in any manner which does not interfere with or impair the right of the grantee to use the said easement and right of way.

IN WITNESS WHEREOF the said parties of the first part have hereunto executed the within instrument the day and year first above written.

RECORDED Apr 12, 63  
BOOK 3367 PAGE A14  
OFFICIAL RECORDS, RIV. CO.  
INSTRUMENT NO. 37198

~~FREDERICK WILLIAM BRAUN~~ *deceased*  
\_\_\_\_\_  
(S) IDA L. BRAUN  
\_\_\_\_\_  
(S) ELLSWORTH WELLINGTON BRAUN  
\_\_\_\_\_  
\_\_\_\_\_  
\_\_\_\_\_

4608  
7600

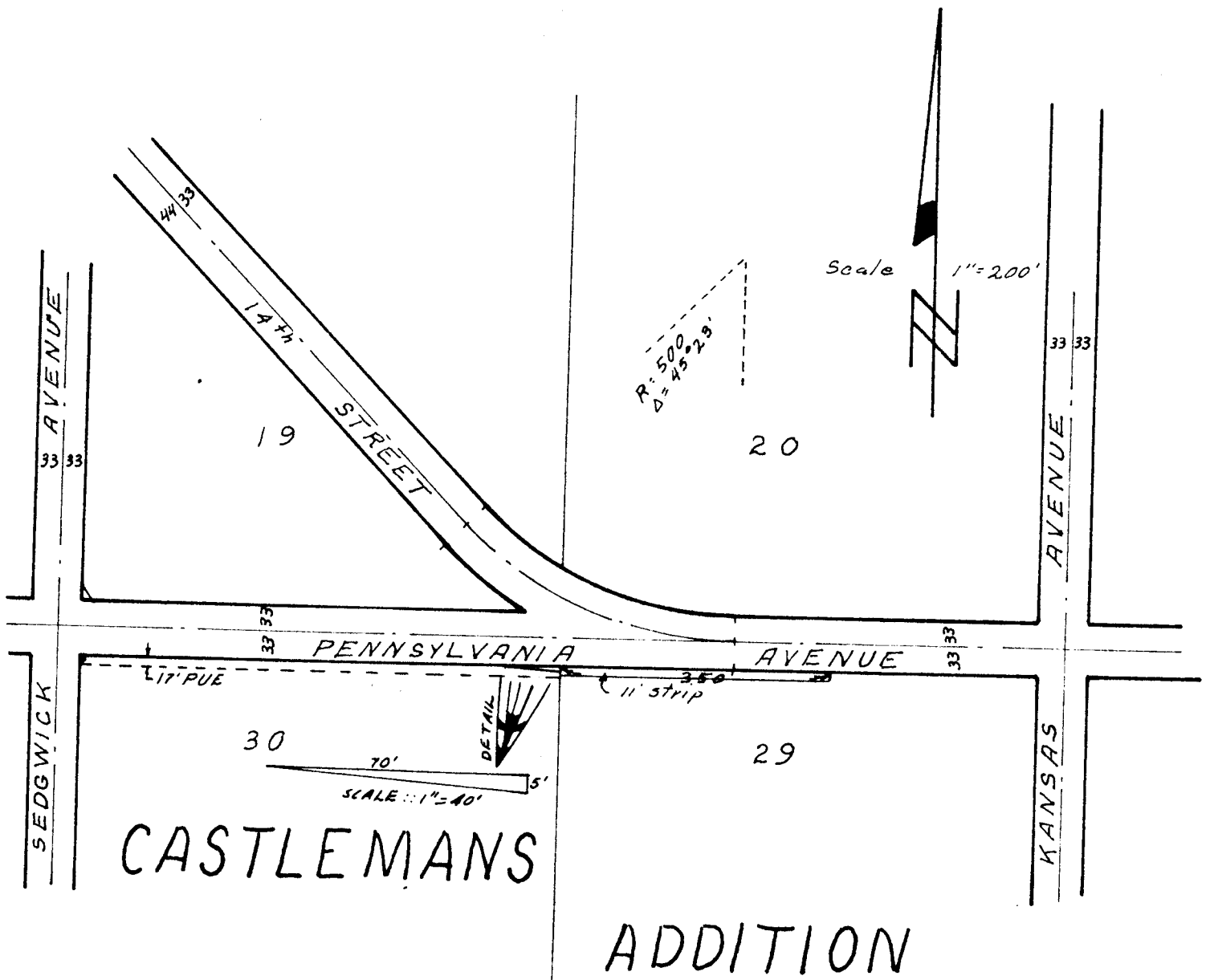

Recorded Book 3, page 19 of Maps  
 San Bernardino Co. Rec.

CITY OF RIVERSIDE, CALIFORNIA

PLAT OF PARCEL(S) DESCRIBED  
 IN THE ATTACHED DOCUMENT

*This plat is solely an aid in locating the parcel(s) described in the  
 attached document. It is not a part of the written description therein.*

SCALE: 1" = 200'

DRAWN 4/2/63 BY EDS

SUBJECT R/S 740