

GRANT DEED

IDA L. BRAUN

(Grantor - ~~SKANDORA~~)

FOR A VALUABLE CONSIDERATION, receipt of which is hereby acknowledged, do es
hereby grant to the CITY OF RIVERSIDE, a municipal corporation, the real property in the
City of Riverside, County of Riverside, State of California, described as follows: --

An irregularly-shaped parcel of land lying within
Lot 30 of Castleman's Addition, per map on file in Book 3,
page 19, of Maps, Records of San Bernardino County,
California, described as follows:

Beginning at a point in the easterly line of said
Lot 30, S00°14'12"W, 5 feet from the northeasterly corner
of said Lot 30;

Thence N00°14'12"E, 5 feet to said northeasterly
corner;

Thence N89°49'00"W, 70 feet along the northerly line
of said Lot 30;

Thence southeasterly in a straight line to the point
of beginning.

For public street purposes.

Dated Apr. 20 19 63

(5)

Ida L. Braun

RECORDED Apr. 26, 63
BOOK 3379 PAGE 210
OFFICIAL RECORDS, RIV. CO.
INSTRUMENT NO. 42921

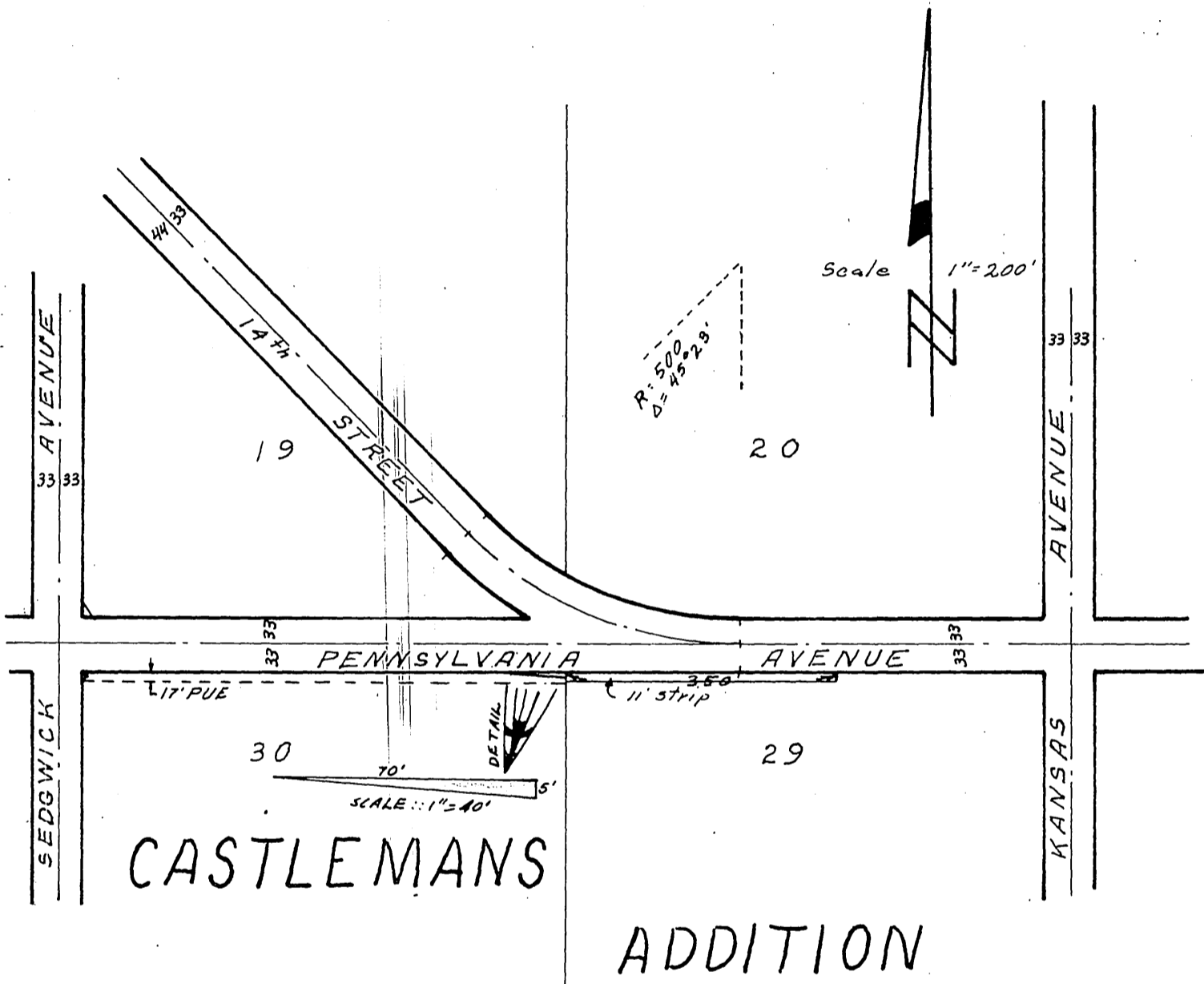

Recorded Book 3, page 19 of Maps

San Bernardino Co. Rec.

CITY OF RIVERSIDE, CALIFORNIA

PLAT OF PARCEL(S) DESCRIBED
IN THE ATTACHED DOCUMENT

*This plat is solely an aid in locating the parcel(s) described in the
attached document. It is not a part of the written description therein.*

SCALE: 1"=200'

DRAWN 4/2/63 BY ED

SUBJECT R/S 740

4620