

SPACE ABOVE THIS LINE FOR RECORDER'S USE

BOOK 2154 PAGE 180

PLACE INTERNAL REVENUE STAMPS IN THIS SPACE

EASEMENT

398 4-57

THIS FORM FURNISHED BY TITLE INSURANCE AND TRUST COMPANY

Affix I. R. S. \$.....

FOR A VALUABLE CONSIDERATION, receipt of which is hereby acknowledged.

Burl E. Stahlman and Betty Jane Stahlman, husband and wife as joint tenants hereby GRANT(S) to La Sierra Community Services District

the following described real property in the state of California, county of Riverside
An easement for the construction, reconstruction, operation, maintenance and repair of a sanitary sewer main and appurtenances over, under and across
The westerly ten (10) feet and the southerly ten (10) feet of the following described parcel.

In the county of Riverside, state of California, and described as follows:

Commencing at the northeast corner of the 120-acre tract in the southwesterly portion of Fractional Section 15, Township 3 South, Range 6 West, San Bernardino Base and Meridian, as shown by Map of Subdivision of RANCHO LA SIERRA on file in Book 6, page 70 of Maps, Riverside County Records; thence South 00° 20' East along the easterly boundary of said 120-acre tract, 1077.3 feet; thence South 89° 40' West, 350 feet; thence South 00° 20' East, 245 feet to a point of beginning; thence South 89° 40' West, 150 feet; thence South 00° 20' East, 65 feet; thence North 89° 40' East, 150 feet; thence North 00° 20' West, 65 feet to the point of beginning.

EXCEPTING therefrom an easement over the westerly 30 feet thereof for road purposes.

Said property is shown as a portion of Lot 32 on Assessor's Map No. 20 on file in Book 1, page 25 of Assessor's Maps, Riverside County Records.

Dated: September 16, 1957

STATE OF CALIFORNIA
COUNTY OF

SS.

Riverside

On September 16, 1957 before me, the undersigned, a Notary Public in and for said County and State, personally appeared
Burl E. Stahlman and
Betty Jane Stahlman

Burl E. Stahlman
Betty Jane Stahlman

known to me to be the persons whose names are subscribed to the within instrument and acknowledged that they executed the same.

WITNESS my hand and official seal.

George M. [Signature]
(Seal) Notary Public in and for said County and State.

My Comm. Exp. Aug. 1, 1959
WHEN RECORDED MAIL TO

69641 La Sierra Community Services District
P. O. Box 140, La Sierra Station
Arlington, California

Title Order No.....

Escrow or Loan No.....

SPACE BELOW FOR RECORDER'S USE ONLY

PHOTOSTATED
COMPARED
CHAMPAREL

RECEIVED FOR RECORD

SEP 27 1957
Min Post. At Request of Clerk

2154 PAGE 180
Et Seq. Records of Riverside County, California

JACK A. ROSE
Recorder

[Signature]
Deputy Recorder

PHOTOSTATED
COMPARED

CHIGA 6/29 5072-N

WHEN

TITLE

TRUST

INCO
HON
433 SOUTH SPRIN

LA SIERRA COMMUNITY SERVICES DISTRICT
RIVERSIDE COUNTY, CALIFORNIA

**URANCE
MPANY**

- COUNTY
- OAKLAND
- ALABAMA
- COUNTY
- FRESNO
- COUNTY
- SAN DIEGO
- COUNTY
- SAN LUIS OBISPO
- COUNTY
- SANTA BARBARA
- COUNTY
- ET, VISALIA
- COUNTY
- REET, VENTURA

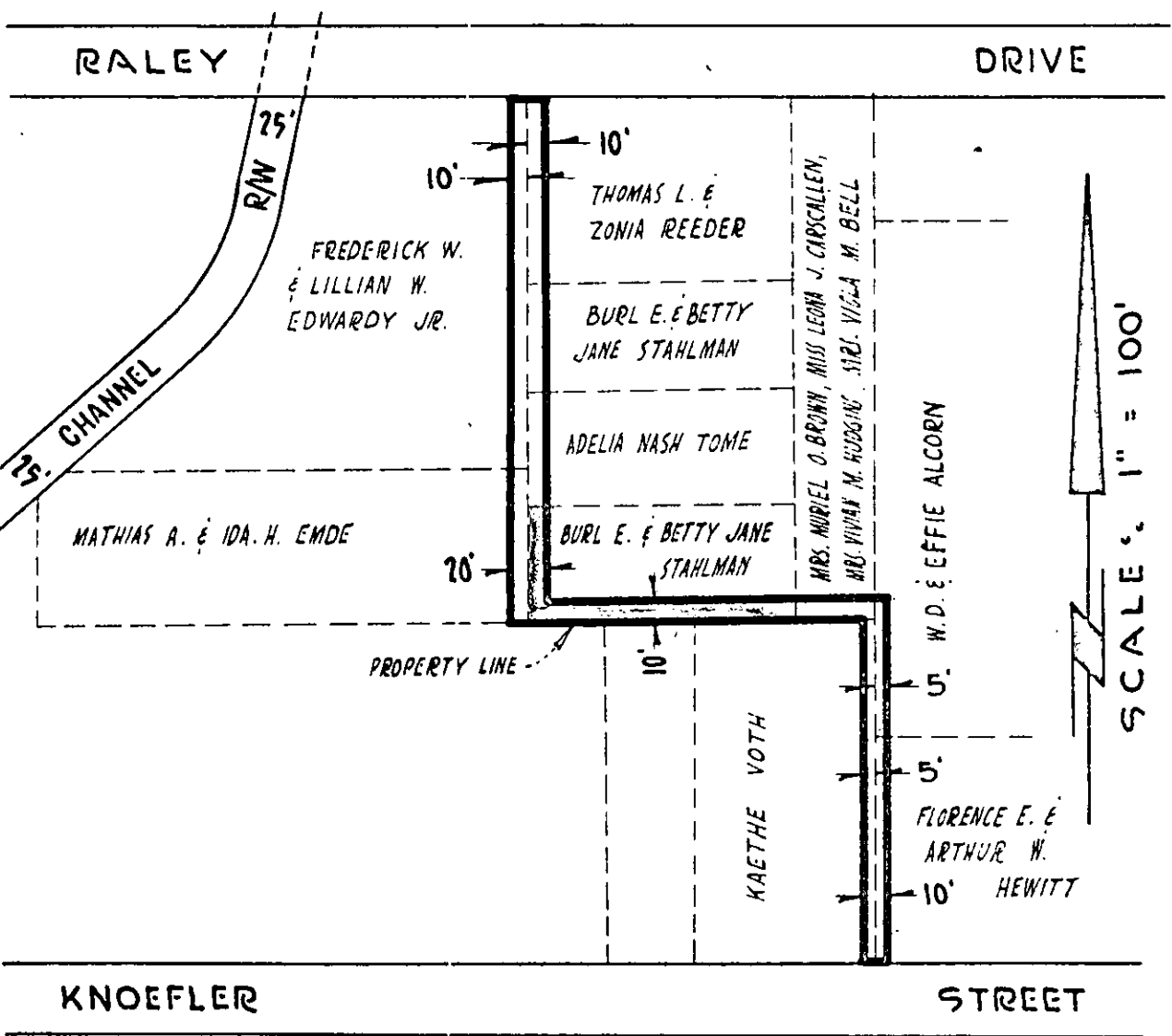

Job No. 2698

BOYLE ENGINEERING
Consulting Engineers
Santa Ana San Diego

Prepared by B.K. 14

RESOLUTION ACCEPTING EASEMENT

BOOK 2154 P. 102

On motion of George M. Allen, seconded by William Lightfeldt, in regular meeting assembled this 17th day of September, 1957, the following resolution was adopted:

BE IT RESOLVED in regular meeting assembled this 17th day of September, 1957, that that certain Easement dated September 16, 1957, from BURL E. STAHLMAN and BETTY JANE STAHLMAN, husband and wife as joint tenants, to La Sierra Community Services District, is accepted and shall be recorded, attached to a certified copy hereof.

The foregoing is certified to be a true copy of a resolution duly adopted by said Board of Directors on the date therein set forth.

Marion Ratagick
Marion Ratagick, Secretary

615072-N