

38442

C-11-645

GRANT DEED

RECEIVED FOR RECORD
APR 2 1965

Min. Past 3 To Clock
At Request of
CITY OF RIVERSIDE

Recorded in Official Records
of Riverside County, California

W.H. DeLong

Recorder
FEE \$

INDEXED

5342

AL MARINEAU and CECELIA MARINEAU, husband and wife

(GRANTORS - Grantors)

FOR A VALUABLE CONSIDERATION, receipt of which is hereby acknowledged, we do _____ hereby grant to the CITY OF RIVERSIDE, a municipal corporation, the real property in the City of Riverside, County of Riverside, State of California, described as follows: --

That portion of Lot 2 of Castleman's Addition to Riverside, as shown by map on file in Book 3, Page 19 of Maps, Records of San Bernardino County, California, described as follows:

The south 8.00 feet of the west 120.00 feet of said Lot 2.

APPROVED AS TO DESCRIPTION

J. F. MARTINEZ
Director of Public Works

By [Signature]
Assistant City Engineer

by HRP-3-16-65

APPROVED AS TO FORM

[Signature]
DEPUTY CITY ATTORNEY

Dated 3-22 1965

RECORDED Apr 2 1965

CITY OF RIVERSIDE, CALIF.
RECORDS DEPARTMENT NO. 23442

X Al Marineau
X Cecelia Marineau

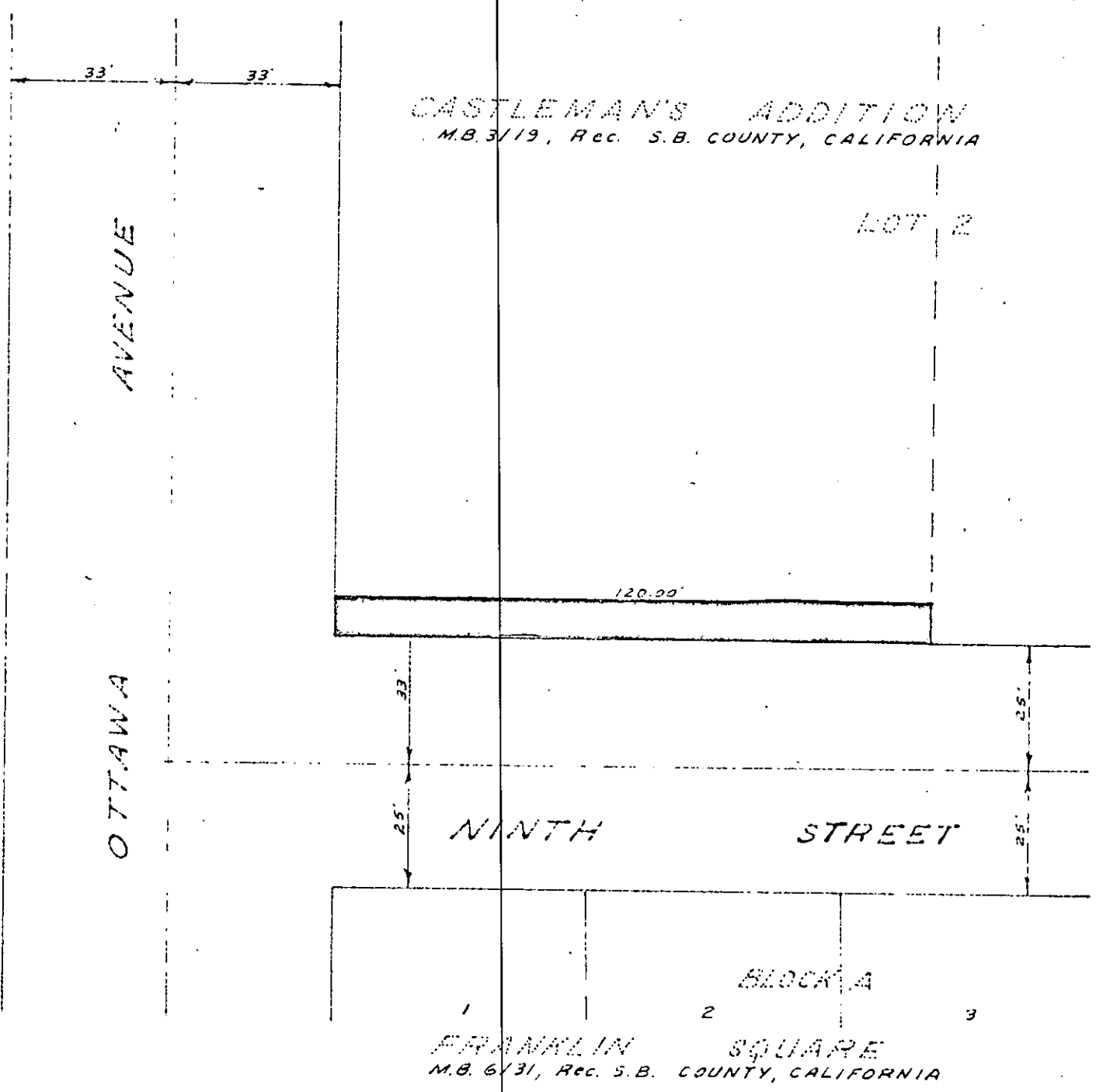

CITY OF RIVERSIDE, CALIFORNIA

**PLAT OF PARCEL(S) DESCRIBED
 IN THE ATTACHED DOCUMENT**

This plat is solely an aid in locating the parcel(s) described in the
 attached document. It is not a part of the written description therein

WO. 65-51
FILE 1905.0
SHEET 1

SCALE: 1" = 30' DRAWN 12 05 BY HGL

SUBJECT *zoning case C-11-645, St. Widening*

OF 1 SHEETS
5212