

44541

City Copy

EASEMENT

APPROVED AS TO FORM

M. Neal Singer
DEPUTY CITY ATTORNEY

5359

THIS INDENTURE, made this 12th day of April, 1965

by and between MEL ALEXANDER and VELMA ALEXANDER, husband and wife

~~H.E. ALEXANDER and BEULAH ALEXANDER, husband and wife~~

part ies of the first part, and the CITY OF RIVERSIDE, a municipal corporation of the State of California, the party of the second part.

WITNESSETH:

THAT for a valuable consideration, receipt whereof is hereby acknowledged, said parties of the first part do ___ by these presents grant unto the said party of the second part, its successors and assigns, an easement and right of way for the construction, maintenance, operation, inspection, repair, replacement, and removal of electric lines and cables, including such additional lines as said grantee may from time to time in the future require, upon and by means of one line of poles, with supporting structures, crossarms, wires, anchors, fixtures, and appurtenances, for the transmission of electric energy for any and all purposes for which the same may be used, and communication purposes upon, over, and across that certain real property situated in the County of Riverside, State of California, described as follows:

The southerly 11 feet of the easterly 60 feet of Lot 15, as shown on map of the Wilbur Tract on file in Book 4 of Maps at page 36 thereof, Records of San Bernardino County, California.

RECORDED Apr 16 1965
BOOK _____
OFFICIAL RECORDS DIVISION
INSTRUMENT NO. 44541

APPROVED AS TO DESCRIPTION
R. Campbell 3/11/65
GEN. SUPT. & CHIEF ENGINEER

TOGETHER WITH the right of entry upon said premises over and across which said easement and right of way is granted, for the purposes of

5359

✓ AP 3/5/65

44541

installing, maintaining and repairing said poles, lines, wires and equipment; provided, however, that the grantor reserve s the right to use and enjoy the land over which said easement and right of way is granted, for any purpose and in any manner which does not interfere with or impair the right of the grantee to use the said easement and right of way.

IN WITNESS WHEREOF the said parties of the first part have hereunto executed the within instrument the day and year first above written.

CONSENT TO RECORDATION

THIS IS TO CERTIFY that the interest in real property conveyed by the Deed or Grant dated

From: [Signature]
For: [Signature]

to the City of Riverside, a municipal corporation, is hereby accepted for and on behalf of said City pursuant to Resolution of the City Council thereof recorded on 12-3-58 in Bk. 2374 O.R. pg. 339 Et Seq. Riverside County Records, and the Grantor hereby consents to recordation of this instrument through the undersigned.

Dated: [Signature] Property Management Officer

Return Deed to: Office of City Clerk Riverside, California

[Signature]

MEL ALEXANDER

[Signature]

VELMA ALEXANDER

[Signature]

[Signature]

BEULAH ALEXANDER

STATE OF CALIFORNIA,

County of Riverside

ss.

ON April 12, the undersigned, a Notary Public in and for said State,

Mel Alexander, Velma Alexander, Beulah Alexander.

to be the persons whose names are subscribed to this Instrument, and acknowledged to me that they executed the same.

WITNESS my hand and official seal.

Glenda G. Bright

California
NAME (TYPED OR PRINTED)
Notary Public in and for said State.

GLEND A G. BRIGHT
My Commission Expires March 25, 1969

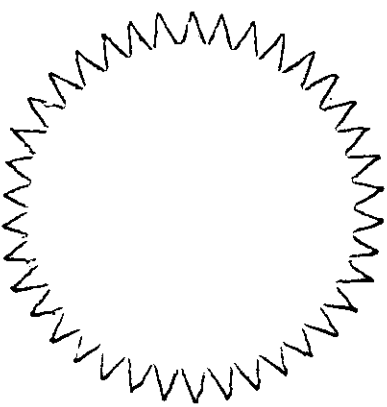
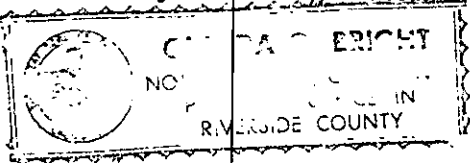

ACKNOWLEDGMENT-GENERAL-WOLCOTTS FORM 233, REV. 8-62

81412

44541

CL 304-419 (11/63)

City of Riverside et al.
Virginia Washington City Club
Room 10 City Hall
Riverside, California

RECEIVED FOR RECORD

APR 16 1965

At Request of

City of Riverside
Recorded in Official Records
of Riverside County, California

W. W. Bologh

Recorder

MICRO-FILMED

Microfilm recording from [unclear] book and page no [unclear] number and year of [unclear]

5359

44541

X 2/179

EASE. REC 1-2-65
INST. NO. 2601-

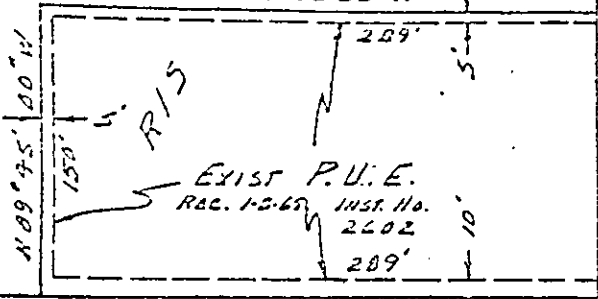

N 0° 08' 35\"/>

661.97 to 1/4 cor. 1.

P.U.E. to be acquired

So. line Sec. 18

Por. SW 4 SE 4 SW 4
Section 18, T.2 S., R. 4 W.
S.B. B. & M.

603.16

661.91

661.97
N 89° 45' 00\"/>

SPRUCE

N 44° 45' 00\"/>

ATLANTA
N 0° 02' 20\"/>

30' 30' AVE.

P.U.E. to be acquired

Lot 15
WILBUR TRACT
M.B. 4/36 S.B. Co.

SCALE 1"=100'
DATE 4 MAR 65

DRAWN LEE
APPROVED [Signature]

CITY OF RIVERSIDE
DEPARTMENT OF PUBLIC UTILITIES

LT
DEPT.

DRAWING NO.
PI-3797

5359