

E A S E M E N T

APPROVED AS TO FORM

DEPUTY CITY ATTORNEY

THIS INSTRUMENT, made this 27th day of June, 1965

by and between FIRST BAPTIST CHURCH OF ARLINGTON, a Corp. 5351

party of the first part and the CITY OF RIVERSIDE, a municipal corporation of the State of California, the party of the second part;

WITNESSETH:

THAT for a valuable consideration, receipt whereof is hereby acknowledged, said party of the first part does by these presents grant unto the said party of the second part, its successors and assigns, a perpetual easement and right of way for the construction, reconstruction, maintenance, operation, inspection, repair, replacement and removal of a

PUBLIC UTILITIES

together with all necessary appurtenances, in, under, upon, over, and along that certain real property situated in the County of Riverside, State of California, described as follows:

See attached descriptions

TOGETHER WITH the right to clear and keep clear said easement and right of way from any structures or trees, to enter upon and to pass and repass

over and along said real property, and to deposit tools, implements and other material thereon by said party of the second part, its officers, agents and employees and by persons under contract with it and their officers, agents and employees, whenever and wherever necessary for the purpose of constructing, reconstructing, maintaining, operating, inspecting, repairing, replacing, and removing said Public Utilities

Provided, however, that the grantors reserve the right to use and enjoy the land over which said easement and right of way is granted, for any purpose and in any manner which does not interfere with or impair the right of the grantee to use the said easement and right of way.

IN WITNESS WHEREOF the said party of the first part has hereunto executed the within instrument the day and year first above written.

FIRST BAPTIST CHURCH OF ARLINGTON,
a Corp

By Mrs. Mildred Stone Secretary

By Marilee Warran Chairman of the Board

CONSENT TO RECORDATION

THIS IS TO CERTIFY that the interest in real property conveyed by the Deed or Grant dated 4-27-45
From: First Baptist Church of Arlington
For: Public Utilities
to the City of Riverside, a municipal corporation, is hereby accepted for use on behalf of said City pursuant

STATE OF CALIFORNIA,

County RIVERSIDE } ss.

56349

ON official 27th, 1945, before me, the undersigned, a Notary Public in and for said County and State, personally appeared Marilee Warran Chairman of the Board and Mildred Stone, known to me to be the of the the Corporation that executed the within Instrument, known to me to be the person who executed the within Instrument, on behalf of the Corporation, therein named, and acknowledged to me that such Corporation executed the same.

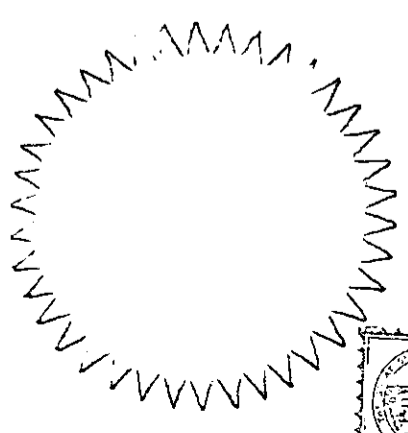

WITNESS my hand and official seal.
ANDREW B. DONALDSON
NOTARY PUBLIC
RIVERSIDE CO., CALIF.

Andrew B. Donaldson
ANDREW B. DONALDSON
Notary Public in and for said County and State.

PARCEL 1

That portion of Lot 13, Block 9 of the LANDS OF THE RIVERSIDE LAND and IRRIGATING COMPANY as shown by map on file in Book 1, page 70 of Maps, Records of San Bernardino County, California, being a strip of land 12 feet wide, the center line of said strip being described as follows:

Commencing at a point in the southwesterly line of said Lot 13; N34°16'00"W, 154 feet from the most southerly corner thereof, said point being the most westerly corner of that certain parcel of land conveyed to the First Baptist Church of Arlington by deed filed for Record, June 13, 1950, as Instrument No. 1521 of Official Records, Records of Riverside County, California;

Thence N55°47'40"E, 150 feet along the northwesterly line of said parcel so conveyed and the point of beginning;

Thence S34°16'00"E, 150 feet, parallel with the southwesterly line of said Lot 13 to the end of this center line description, said point being N34°16'00"W, 4 feet northwesterly from the southeasterly line of said Lot 13.

PARCEL 2

That portion of Lot 13, Block 9 of the LANDS OF THE RIVERSIDE LAND and IRRIGATING COMPANY as shown by map on file in Book 1, page 70 of Maps, Records of San Bernardino County, California, being a strip of land 6 feet wide lying southeasterly and southwesterly of and adjacent to the following described line:

Commencing at a point in the southwesterly line of said Lot 13, N34°16'00"W, 154 feet from the most southerly corner thereof, said point being the most westerly corner of that certain parcel of land conveyed to the First Baptist Church of Arlington by deed filed for Record, June 13, 1950 as Instrument No. 1521 of Official Records, Records of Riverside County, California;

Thence N55°47'40"E, 15 feet along the northwesterly line of said parcel conveyed to the First Baptist Church of Arlington and the point of beginning;

Thence continuing N55°47'40"E, 315.60 feet along the northwesterly line of said parcel so conveyed to the most northerly corner thereof;

Thence S34°16'00"E, 150 feet along the northeasterly line of said parcel to the end of this line description, said point being N34°16'00"W, 4 feet from the most easterly corner of said parcel.

DESCRIPTION APPROVAL

by *Edward L. Smith*, 4/16/65 by *J.P.*
Surveyor

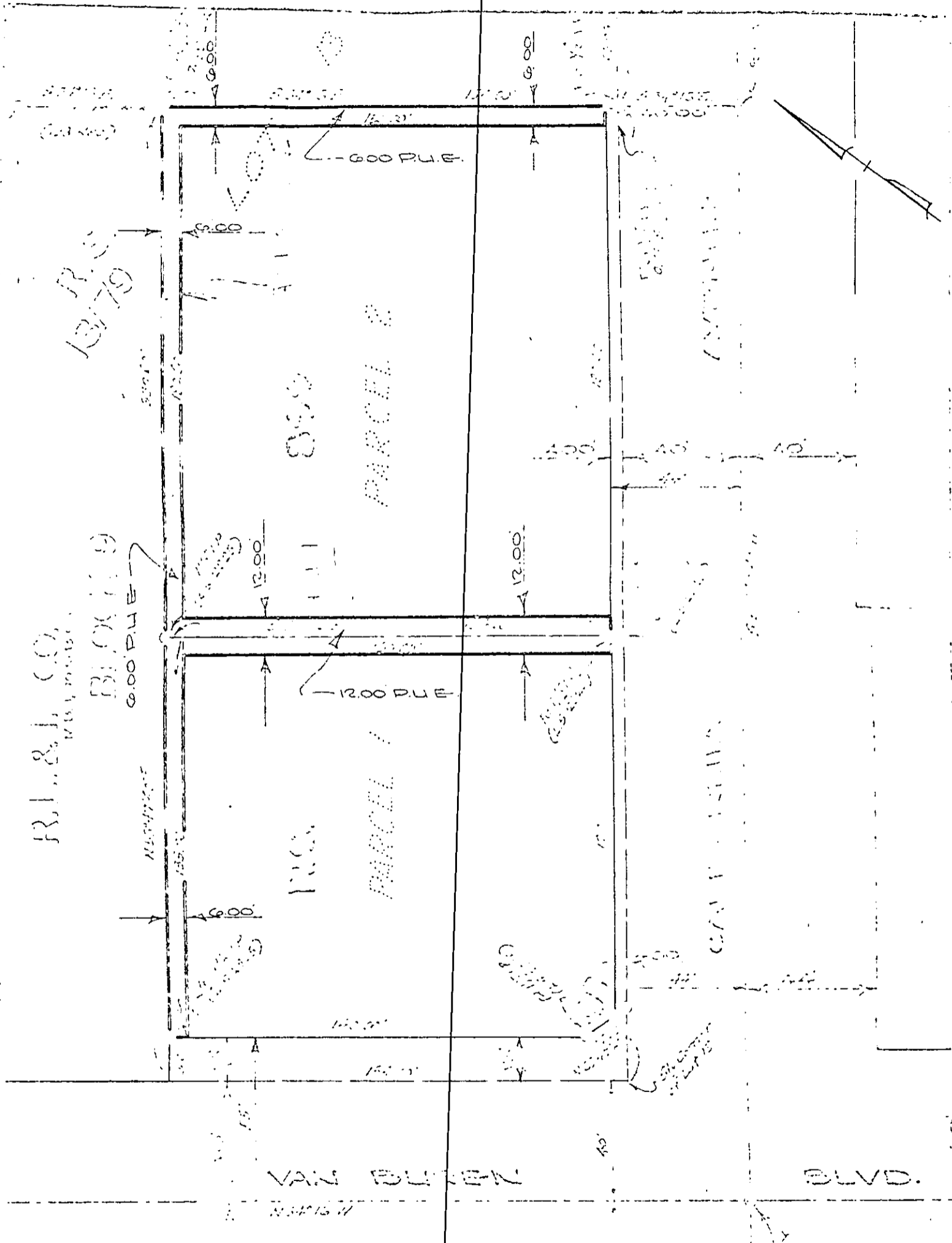

CITY OF RIVERSIDE, CALIFORNIA

PLAT OF PARCEL(S) DESCRIBED IN THE ATTACHED DOCUMENT

This plat is solely an aid in locating the parcel(s) described in the attached document.
 It is not a part of the written description therein.

Scale 1"=50' Date 4-15-65 Subject R/S 299 J.H. Johnson issue 1/11/65

56349

520

Microfilm made from original
by the County Recorder's Office
Number 56349 of 56349

MICRO-FILMED

RECEIVED FOR RECORD

MAY 14 1965

Min. Post. 12 o'clock

At Request of

Recorder in Official Records
of Riverside County, California

W. D. Dwyer

RECORDER

INDEXED