

93969

RECEIVED FOR RECORD

AUG 13 1965

5 Min. Past 4 o'clock PM
At Request of
City of Riverside
Recorded in Official Records
of Riverside County, California

W.A. DeLoach

Fees \$ Recorder

10440 Campbell

Microfilm recording from 4-1-65. Book and page no longer assigned. Identify by document number and year of filing.

5502

INDEXED

GRANT DEED

APPROVED AS TO FORM

M. Neal Simon

DEPUTY CITY ATTORNEY

ELBERT L. MYRICK & SHIRLEY A. MYRICK, HUSBAND and WIFE

(Grantor - Grantors)

FOR A VALUABLE CONSIDERATION, receipt of which is hereby acknowledged, do hereby grant to the CITY OF RIVERSIDE, a municipal corporation, the real property in the City of Riverside, County of Riverside, State of California, described as follows: --

The northerly 8 feet of the following described property:
Lot 5, Block III of Chadbourne Heights as shown by map on file in Book 12, pages 11, 12, and 13 of Maps, Records of Riverside County, California.

EXCEPTING therefrom the following described property:

Beginning at the northwest corner of said Lot 5;

Thence easterly along the northerly line of said Lot 5,

30 feet;

Thence southerly, 350 feet to the southwest corner of said

Lot 5;

Thence northerly along the westerly line of said Lot 5

to the point of beginning.

ALSO EXCEPTING the following described property:

Commencing at the northwest corner of said Lot 5;

Thence easterly along the northerly line of said Lot 5,

30 feet to the true point of beginning;

Thence continuing easterly along the northerly line of

said Lot 5, 60 feet;

Thence southerly and parallel with the easterly line of

said Lot 5, 140 feet;

Thence westerly and parallel with the northerly line of

said Lot 5 to a point in a line drawn from the true point of

beginning, directly south to the southwest corner of said Lot 5;

Thence northerly on said last described line to the true

point of beginning.

DESCRIPTION APPROVAL

By *Samuel L. ...*, 8/13/65 by *...*
Surveyor

Dated Aug 2, 1965 19 65

Elbert L. Myrick
ELBERT L. MYRICK

SHIRLEY A. MYRICK

Shirley A. Myrick

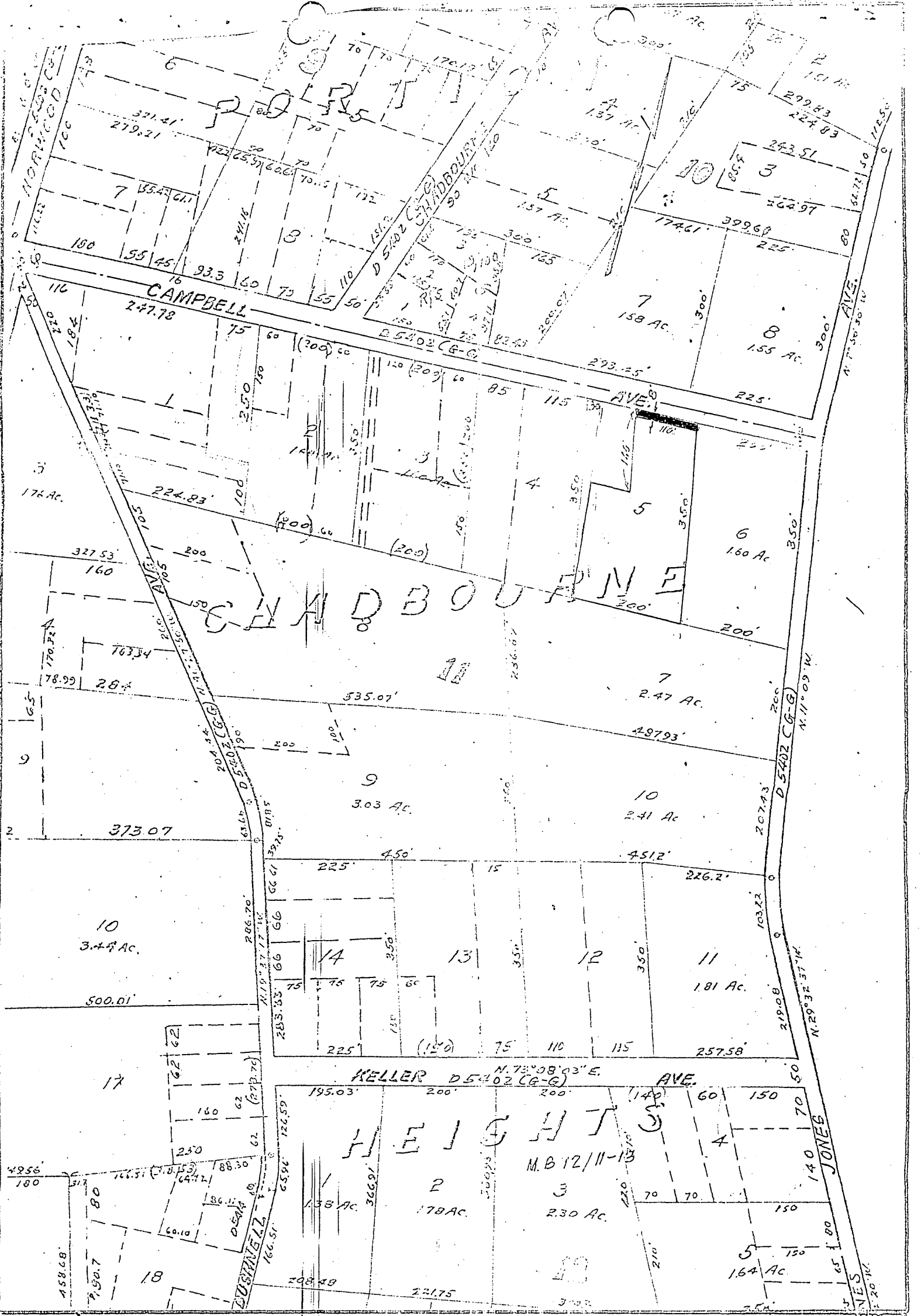

CITY OF RIVERSIDE, CALIFORNIA

PLAT OF PARCEL(S) DESCRIBED
IN THE ATTACHED DOCUMENT

This plat is solely an aid in locating the parcel(s) described in the attached document. It is not a part of the written description therein.

5502