

installing, maintaining and repairing said poles, lines, wires and equipment; provided, however, that the grantors reserve the right to use and enjoy the land over which said easement and right of way is granted, for any purpose and in any manner which does not interfere with or impair the right of the grantee to use the said easement and right of way.

IN WITNESS WHEREOF the said parties of the first part have hereunto executed the within instrument the day and year first above written.

Witnessed By  
Robert Mills  
11/15/65

Hans M. Scapple  
Esther Scapple

CONSENT TO RECORDATION

THIS IS TO CERTIFY that the interest in real property conveyed by the Deed or Grant dated 11-15-65 From: Hans M. Scapple & Esther Scapple For: City of Riverside, a municipal corporation, is hereby accepted for and on behalf of said City pursuant to Resolution of the City Council thereof recorded on 12-3-58 in Bk. 2374 O.R. pg. 339 et seq. Riverside County Records, and the Grantee hereby consents to recordation of this instrument through the undersigned.

Dated 11-17-65 L. A. Bailey Property Management Officer

Return Deed to: Office of City Clerk Riverside, California

STATE OF CALIFORNIA  
COUNTY OF RIVERSIDE

ss.

ON November 15th, 1965 before me, the undersigned, a Notary Public in and for said State, personally appeared Robert L. Mills personally known to me to be the person whose name is subscribed to the within instrument, as a Witness thereto, who being by me duly sworn, deposes and says: That he resides in Riverside County and that he was present and saw Han M. Scapple and Esther Scapple personally known to him to be the same persons described in and whose names subscribed to the within and annexed instrument as Parties thereto, execute and deliver the same, and they acknowledged to said affiant that they executed the same; and that said affiant subscribed his name thereto as a Witness.

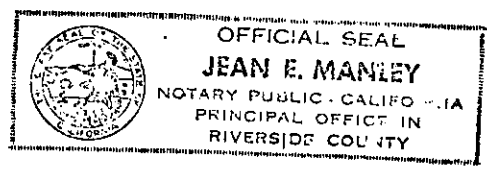

Jean E. Manley  
JEAN E. MANLEY  
My Commission Expires January 3, 1966  
Notary Public in and for said State.

4th ST.

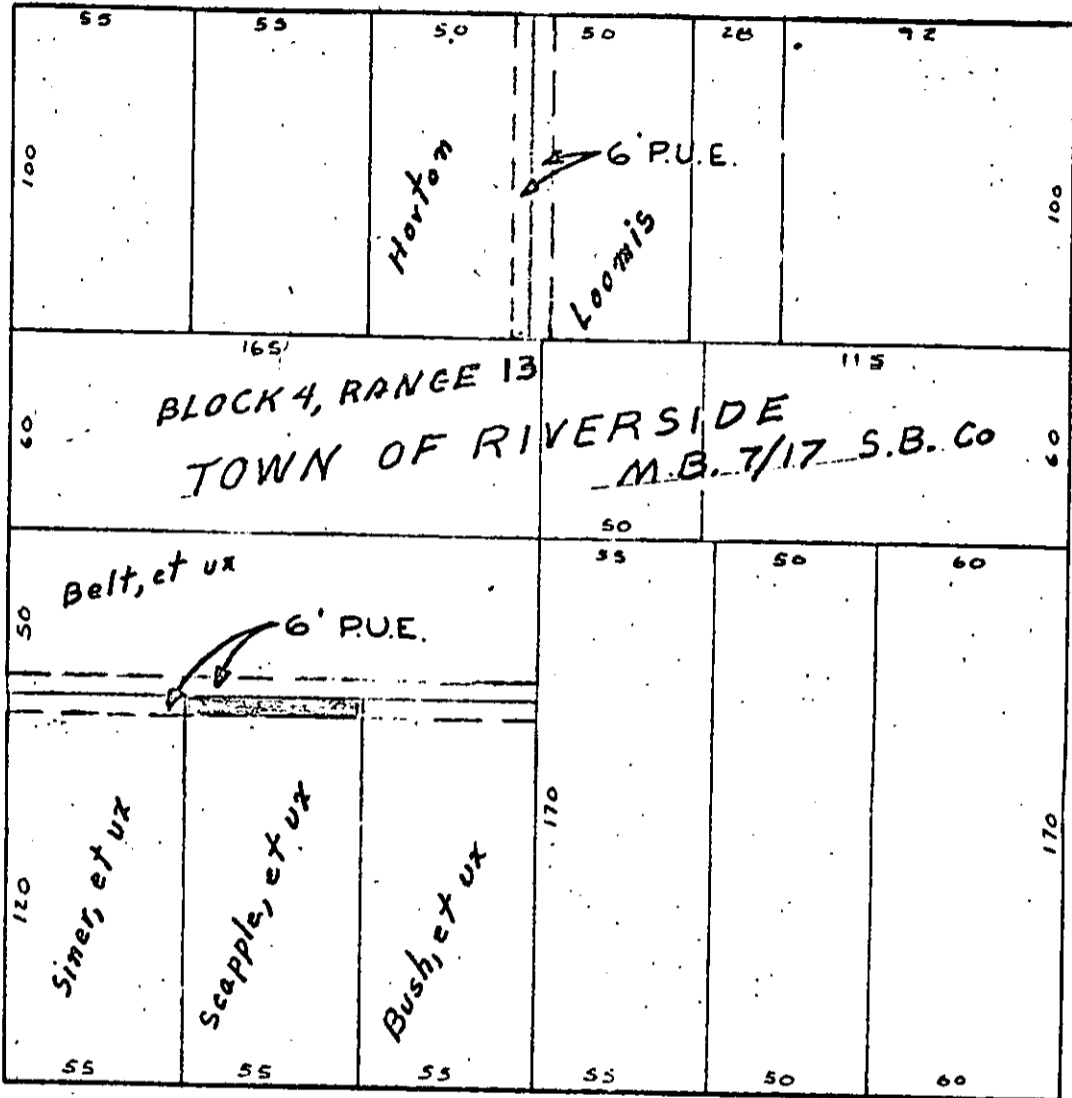

5th ST.

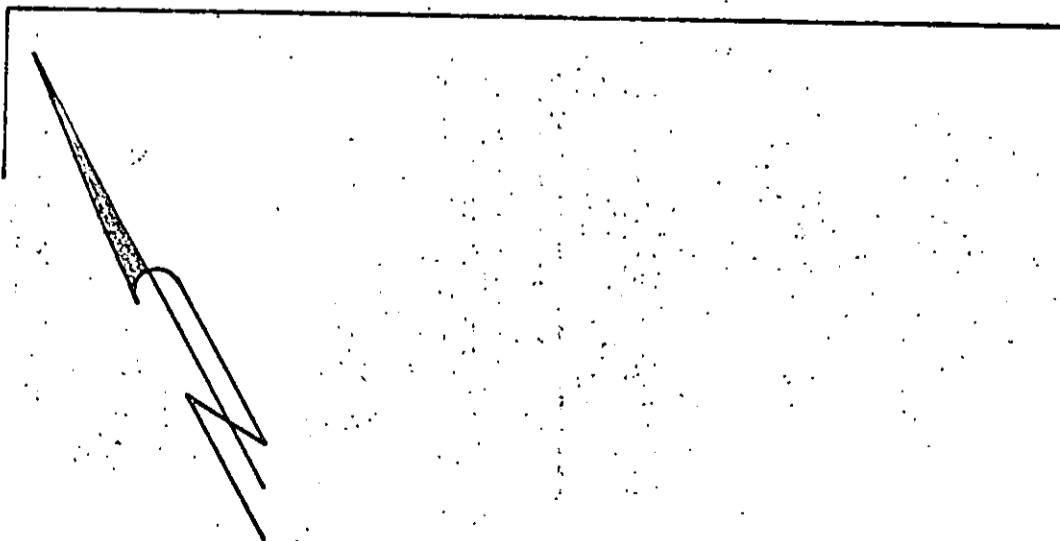

SCALE 1" = 60'  
DATE 8-31-65

DRAWN RJH  
APPROVED *[Signature]*

CITY OF RIVERSIDE  
DEPARTMENT OF PUBLIC UTILITIES

LT  
DEPT.

DRAWING NO.

PI-3065-2

131645

Microfilm recording from 4-1-65. Book and  
page no longer assigned. Identity by document  
number and year of filing.

RECEIVED FOR RECORD

NOV 19 1965

3:00 Min. Past 5 o'clock

AV Request of

*[Signature]*  
Recorded in Official Records  
of Riverside County, California

*W. W. DeLoach*

Recorder

FEES \$7.00

INDEXED

APPROVED AS TO FORM

*M. Seal-Linger*  
DEPUTY CITY ATTORNEY

EASEMENT

5602

THIS INDENTURE, made this 15th day of November, 1965

by and between HANS M. SCAPPLE & ESTHER SCAPPLE, husband & wife

parties of the first part, and the CITY OF RIVERSIDE, a municipal corporation of the State of California, the party of the second part.

WITNESSETH:

THAT for a valuable consideration, receipt whereof is hereby acknowledged, said parties of the first part do by these presents grant unto the said party of the second part, its successors and assigns, an easement and right of way for the construction, maintenance, operation, inspection, repair, replacement, and removal of electric lines and cables, including such additional lines as said grantee may from time to time in the future require, upon and by means of one line of poles, with supporting structures, crossarms, wires, anchors, fixtures, and appurtenances, for the transmission of electric energy for any and all purposes for which the same may be used, and communication purposes upon, over, and across that certain real property situated in the County of Riverside, State of California, described as follows:

The northeasterly 6 feet of that portion of Block 4 Range 13 as shown on map of Town of Riverside on file in Map Book 7 at page 17 thereof, San Bernardino County records, described as follows:

Beginning at a point on the southwesterly line of said Block, 55 feet southeasterly of the most westerly corner of said Block;  
Thence northeasterly parallel with the northwesterly line of said Block, 120 feet;  
Thence southeasterly parallel with the southwesterly line of said Block, 55 feet;  
Thence southwesterly parallel with the northwesterly line of said Block, 120 feet to the southwesterly line of said Block;  
Thence northwesterly along said southwesterly line, 55 feet to the point of beginning.

APPROVED AS TO DESCRIPTION

*J. Lambert* 9/22/65  
SEN. SUPT. & CHIEF ENGINEER

RECORDED Nov. 19. 1965  
BOOK \_\_\_\_\_ PAGE \_\_\_\_\_  
OFFICIAL RECORDS DIVISION  
INSTRUMENT NO. 131645

TOGETHER WITH the right of entry upon said premises over and across which said easement and right of way is granted, for the purposes of