

6140 Stover Avenue

133687

5605

GRANT DEED

APPROVED AS TO FORM

M. J. Seal
DEPUTY CITY ATTORNEY

Microfilm recording from 4-1-65. Book and page no. of recording to be determined by number and year of filing.

RECEIVED FOR RECORD

NOV 26 1965

Min. Past 9 o'clock
At Request of

Recorded in Official Records
of Riverside County, California

W. H. Dealy

Recorder
FEES \$ *1.00*

INDEXED

SR.
DONALD L. REES / & VIOLA J. REES, husband and wife

(Grantor - ~~Grantors~~)

FOR A VALUABLE CONSIDERATION, receipt of which is hereby acknowledged, do es hereby grant to the CITY OF RIVERSIDE, a municipal corporation, the real property in the City of Riverside, County of Riverside, State of California, described as follows: --

The easterly 8 feet of the southerly 61.18 feet of Lot 9, Block 1 of Chadbourne Heights as shown by map on file in Book 12, pages 11, 12 & 13 of Maps, Records of Riverside County, California.

DESCRIPTION APPROVAL

by *E. W. Kinter*, 11/2/65 by *J. L. P.*
Surveyor

Nov 18 1965

Donald L. Rees Sr.
DONALD L. REES SR.
Viola J. Rees
VIOLA J. REES

RECORDED Nov. 26 1965
BOOK 133687
OFFICIAL RECORDS
INSTRUMENT NO. 133687

133687 (-/64)

5605

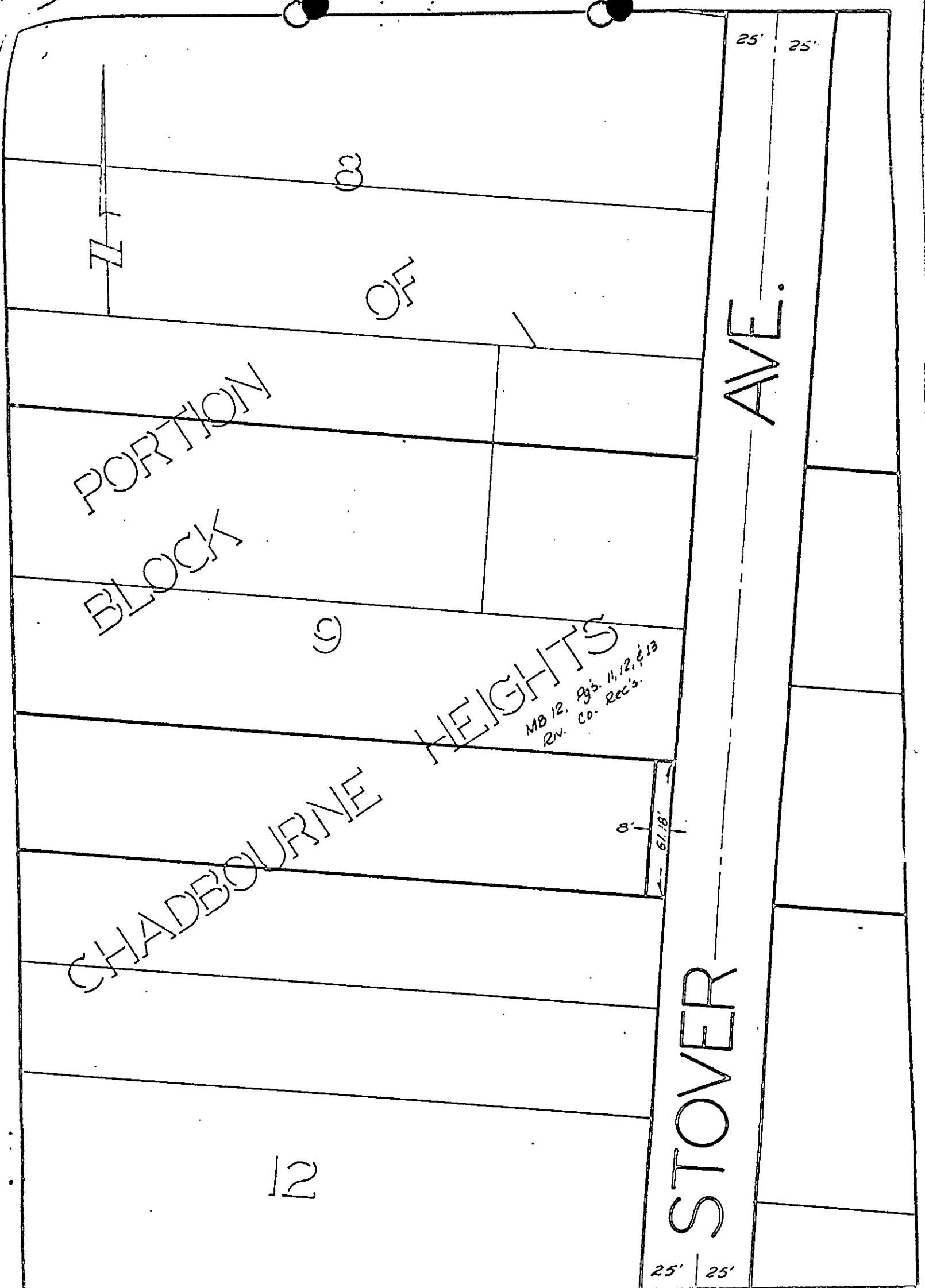

25' 25'

AVE.

PORTION OF
BLOCK

3
9

CHADBourNE HEIGHTS

MB 12, Pgs. 11, 12, & 13
Rev. Co. Rec's.

8' 61.18''

12

STOVER

25' 25'

CITY OF RIVERSIDE, CALIFORNIA

PLAT OF PARCEL(S) DESCRIBED
IN THE ATTACHED DOCUMENT

*This plat is solely an aid in locating the parcel(s) described in the
attached document. It is not a part of the written description therein.*