

WAIVER OF VEHICULAR ACCESS

M. Neal Jensen
DEPUTY CITY ATTORNEY

5389

For a valuable consideration, receipt of which is hereby acknowledged, RIVERSIDE SHOPPING CENTER INC., a California corporation, hereby waives and relinquishes all rights of vehicular ingress and egress to and from Riverside Avenue, a public street in the City of Riverside and the below described parcel of land, and covenants and agrees that they will permit no vehicular ingress or egress to or from said parcel and Riverside Avenue.

The Northerly 443.93 feet of that portion of the Southwest one-quarter of the Northeast one-quarter of Section 34, Township 2 South, Range 5 West, San Bernardino Base and Meridian lying Southerly of Merrill Avenue as conveyed to the City of Riverside by Deed recorded in Book 1888 page 240 of Official Records of Riverside County, California and Westerly of said Riverside Avenue.

This waiver of vehicular access shall be binding on the heirs, successors and assigns of Riverside Shopping Center, Inc.

Microfilm recording form 14-55. Book and page no. listed in 14. Identify by document number and year of filing.

DESCRIPTION APPROVAL
by *Edward L. ...* 7.11.66 by *J.P.S.*
Surveyor

CONSENT TO RECORDATION

THIS IS TO CERTIFY that the interest in real property covered by the Deed or Grant dated 7-28-66

RECORDED Aug 12 1966
BOOK 1733
OFFICIAL RECORDS, INT. CO.
INSTRUMENT NO. 82548

STATE OF CALIFORNIA,

County of Riverside } ss.

ON July 28, 1966, before me, the undersigned, a Notary Public in and for said County and State, personally appeared R. G. Hibbard, known to me to be the Vice President of the _____ the Corporation that executed the within Instrument, known to me to be the person who executed the within Instrument, on behalf of the Corporation, therein named, and acknowledged to me that such Corporation executed the same.

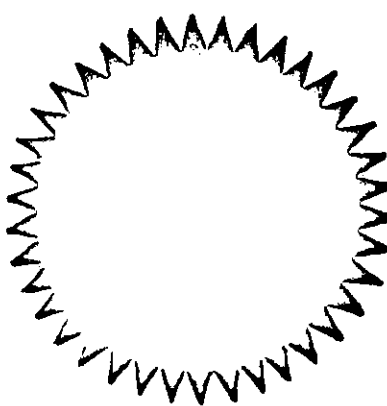

WITNESS my hand and official seal.

L. M. Badger
L. M. Badger
NAME (TYPED OR PRINTED)
Notary Public in and for said County and State.

11/26 HB

709

82548

1888/240 O.R.

MERRILL AVENUE

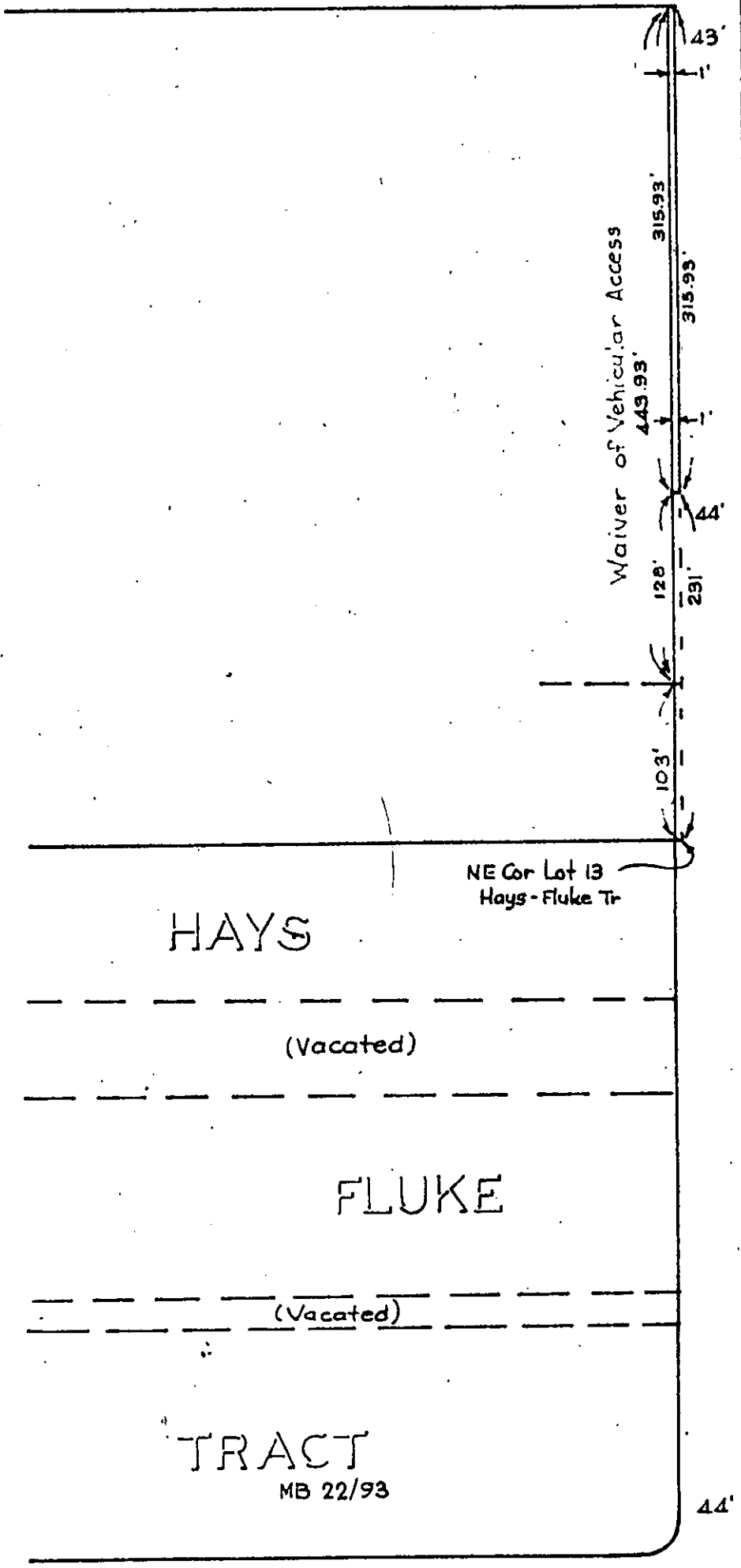

AVENUE
RIVERSIDE

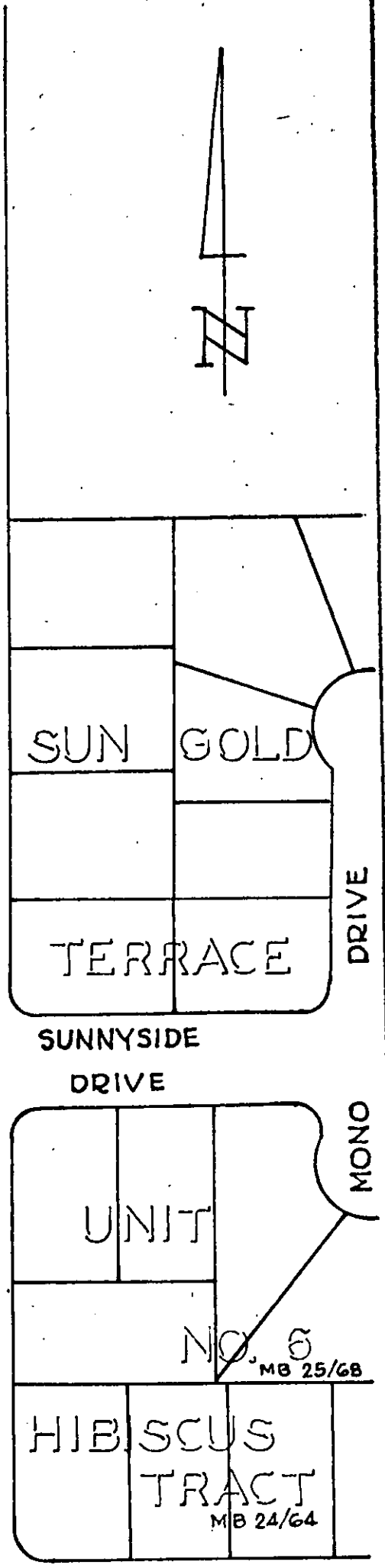

CENTRAL

AVENUE

CITY OF RIVERSIDE, CALIFORNIA

PLAT OF PARCEL(S) DESCRIBED IN THE ATTACHED DOCUMENT

This plat is solely an aid in locating the parcel(s) described in the attached document. It is not a part of the written description therein.

5909

82548

5909

RECEIVED FOR RECORD

AUG 12 1966

3³⁴ Min. Past 9:00 Clock

At Request of

William L. ...

Recorded in Official Records
of Riverside County, California

W. W. ...

Recorder

FEE \$ *1.00*

INDEXED