

110003

1777 Main Street
Pas. #15

GRANT DEED

APPROVED AS TO FORM

M. Neal Hengele

DEPUTY CITY ATTORNEY

5992

RALPH GIBBS and LORENA GIBBS, husband and wife

[Signature]
(GRANTOR - Grantors)

FOR A VALUABLE CONSIDERATION, receipt of which is hereby acknowledged, do hereby grant to the CITY OF RIVERSIDE, a municipal corporation, the real property in the City of Riverside, County of Riverside, State of California, described as follows: --

The easterly 11 feet of Lot 6 of GLENDORA TRACT as measured at right angles westerly from the easterly line of said Lot, as shown by map on file in Book 8, page 25 of Maps, Records of Riverside County, California.

APPROVED AS TO DESCRIPTION

I. F. MARTINEK
Director of Public Works

[Signature]
Assistant City Engineer
by 742P-3-12-65

CONSENT TO RECORDATION

THIS IS TO CERTIFY that the interest in real property conveyed by the Deed or Grant dated 11-1-66

From: Ralph and Lorena Gibbs
For: Par. Lot 6, Glendora Tract

to the City of Riverside, a municipal corporation, is hereby accepted for and on behalf of said City pursuant to Resolution of the City Council thereof recorded on 12-3-58 in Bk. 2374 O.R. pg. 339 et Seq. Riverside County Records, and the Grantor hereby consents to recordation of this instrument through the undersigned.

Dated 11-10-66 *[Signature]*
Property Management Officer

Return Deed to: Office of City Clerk
Riverside, California

Noted 10/19/66
110003

110003

STATE OF CALIFORNIA,

COUNTY OF RIVERSIDE

ss.

ON November 7th, 1966
before me, the undersigned, a Notary Public in and for said State, personally appeared Thomas D. Kennelly

personally known to me to be the person whose name is subscribed to the within instrument, as a Witness thereto, who being by me duly sworn, deposes and says:

That he resides in Riverside County
and that he was present and saw Ralph Gibbs and Lorena Gibbs

personally known to him to be the same person as described in and whose name is subscribed to the within and annexed instrument as Parties thereto, execute and deliver the same, and they acknowledged to said affiant that they executed the same; and that said affiant subscribed his name thereto as a Witness.

WITNESS my hand and official seal.

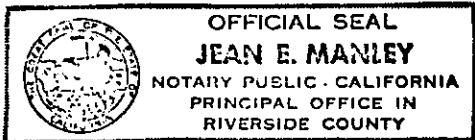

[Signature]
JEAN E. MANLEY
Notary Public in and for said State.

NAME (TYPED OR PRINTED) January 3, 1969
Notary Public in and for said State.

5992

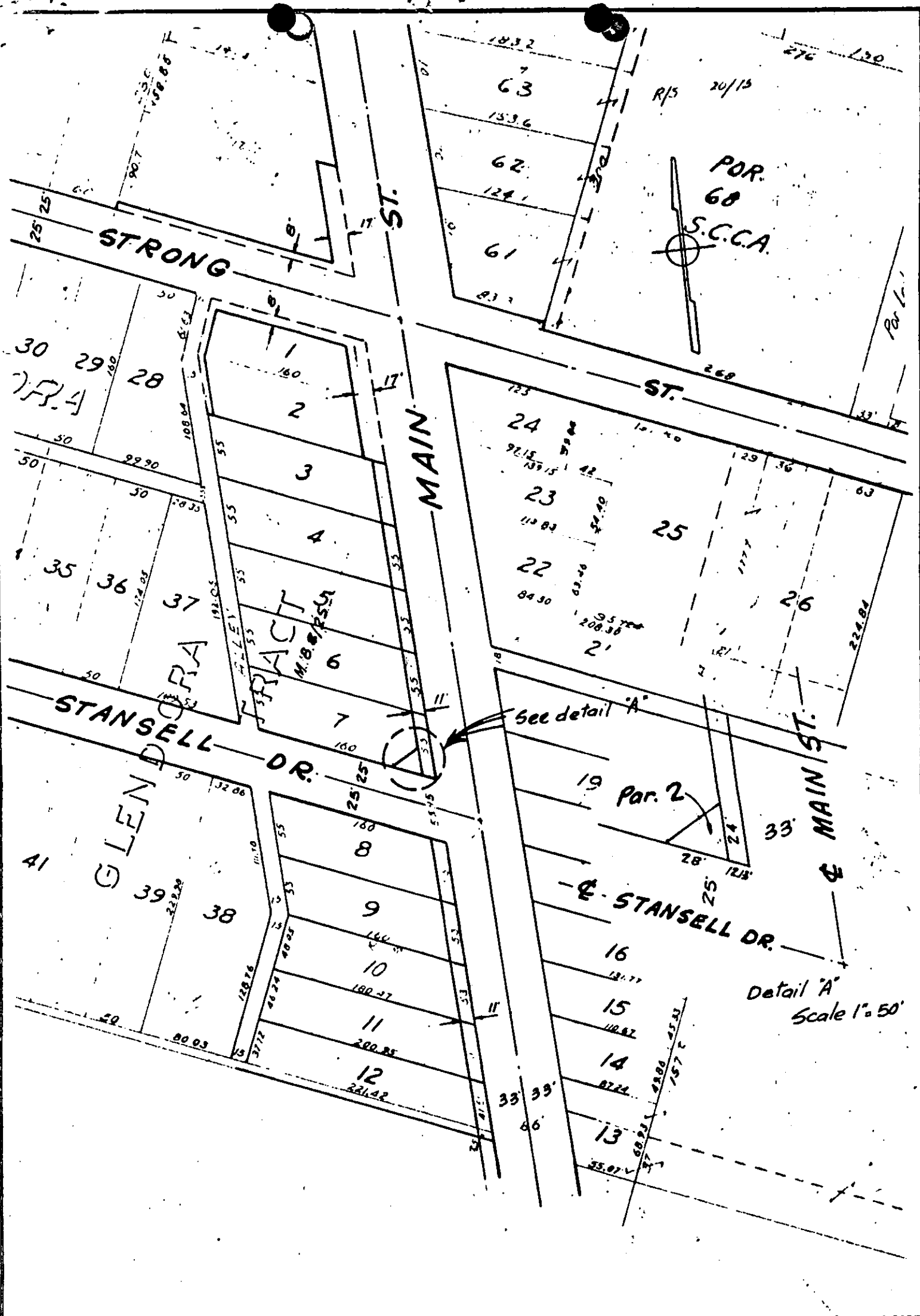

CITY OF RIVERSIDE, CALIFORNIA

PLAT OF PARCEL(S) DESCRIBED
IN THE ATTACHED DOCUMENT

This plat is solely an aid in locating the parcel(s) described in the
attached document. It is not a part of the written description therein.

SCALE: 1" = 100' DRAWN 3/4/65 BY G.S. SUBJECT Main St. widening 2/6.

5992

Microfilm recording from 4-1-65. B.
page no longer assigned. Identify by
number and year of filing.

RECEIVED FOR RECORD
NOV 10 1966

40 Min. Past 3 o'Clock P M
At Request of
City of Riverside
Recorded in Official Records
of Riverside County, California

W. H. Walsh
Recorder
FEE \$ 0.00
INDEXED