

INDEXED 11708

Microfilm recording from 4-1-66. Book and page no longer assigned. Identify by document number and year of filing.

APPROVED AS TO FORM

Mr. Noel Singer
DEPUTY CITY ATTORNEY

6088

RECEIVED FOR RECORD
FEB 10 1967

2 Min. Past 4 o'clock P.M.
At Request of
Grimes
Recorded in Official Records
of Riverside County, California

FEE *Monroe*
Recorder

ELBERT M. DENNY and RUBY D. DENNY, husband and wife

Grantors

FOR A VALUABLE CONSIDERATION, receipt of which is hereby acknowledged, do hereby grant to the CITY OF RIVERSIDE, a municipal corporation, the real property in the City of Riverside, County of Riverside, State of California, described as follows: --

The Southwesterly 8 feet of the Northwesterly 100 feet of Lot ⁽³¹⁾ 30 of Hall's Addition to Riverside, Division "C" as shown in Book 9, page 3 of Maps, San Bernardino County Records, California.

CONSENT TO RECORDATION

THIS IS TO CERTIFY that the interest in real property conveyed by the Deed or Grant dated 2-7-67

From: Elbert M. & Ruby D. Denny

For: Part Lot 30 Hall's Add. to Riverside

to the City of Riverside, a municipal corporation, is hereby accepted for and on behalf of said City pursuant to Resolution of the City Council thereof recorded on 12-3-58 in Bk. 2374 O.R. pg. 309 1st Sec. Riverside County Records, and the Grantee hereby consents to recordation of this instrument through the undersigned.

Dated 2-10-67

[Signature]
Property Management Officer

Return Deed to: Office of City Clerk
Riverside, California

DESCRIPTION APPROVAL

by *[Signature]* 1-7-67 by C.S.
Surveyor

Dated 2-7 1967

Witnessed By
Robert L. Mills

Feb 10, 67

Elbert M. Denny
ELBERT M. DENNY
Ruby D. Denny
RUBY D. DENNY

11708

11708

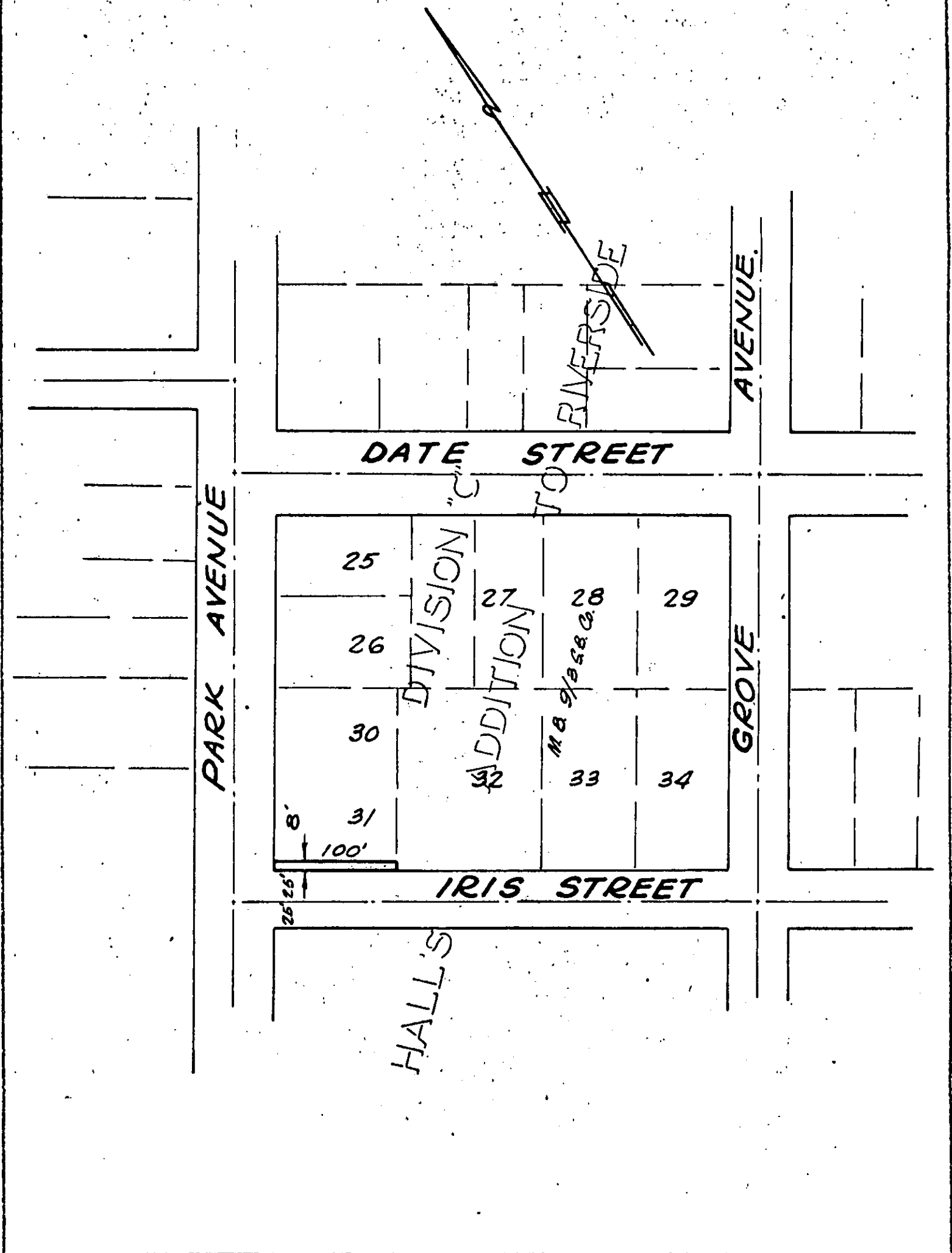

CITY OF RIVERSIDE, CALIFORNIA

PLAT OF PARCEL(S) DESCRIBED
IN THE ATTACHED DOCUMENT

This plat is solely an aid in locating the parcel(s) described in the
attached document. It is not a part of the written description therein.

6088