

*no consideration paid
In City of Riverside
6421*

21484

21484
FEE \$ *11.00*
Recorder

W. H. D. D. D.

Recorded in Official Records
of Riverside County, California

CITY CLERK

20 Min. Past *4* o'clock *P* M

RECEIVED FOR RECORD
MAR 8 1968

Microfilm recording from 4-1-65. Book and Page
no longer assigned. Identify by account number
and year of filing.

GRANT DEED

APPROVED AS TO FORM
Hugh Coffin
CITY ATTORNEY

L & M ENTERPRISES, a partnership

Grantor

FOR A VALUABLE CONSIDERATION, receipt of which is hereby acknowledged,
does hereby grant to the CITY OF RIVERSIDE, a municipal corporation, the
real property in the City of Riverside, County of Riverside, State of
California, described as follows: --

A strip of land 18.00 feet in width, being the Easterly 3.00 feet
of Lot 17, Block 14 of Tract No. 3 of the Riverview Addition to the
City of Riverside, as shown by map on file in Book 7, Page 5 of Maps,
Records of said County, and all that part of the Westerly 15.00 feet
of the rejected Fremont Street, 60.00 feet in width, which lies adjacent
to said Lot.

CONSENT TO RECORDATION

THIS IS TO CERTIFY that the interest in real property
conveyed by the Deed or Grant dated 3-5-68
From: L & M Enterprises
For: Lot 17, Bl. 14 of Tract No. 3

to the City of Riverside, a municipal corporation, is hereby
accepted for and on behalf of said City pursuant
to Resolution of the City Council thereof recorded on
12-3-58 in Bk. 2374 O.R. pg. 339 Et Seq. Riverside County
Records, and the Grantee hereby consents to recordation
of this instrument through the undersigned,

Dated 3-8-68
AM Rice
Property Management Officer

Return Deed to: Office of City Clerk
Riverside, California

DESCRIPTION APPROVAL

by *Edward H. ...* 3/11/68 by *OS*
Surveyor

L & M ENTERPRISES, a partnership

Dated March 5 19 68

BY *Orson W. Lauritzen*

BY *D. ...*

58512

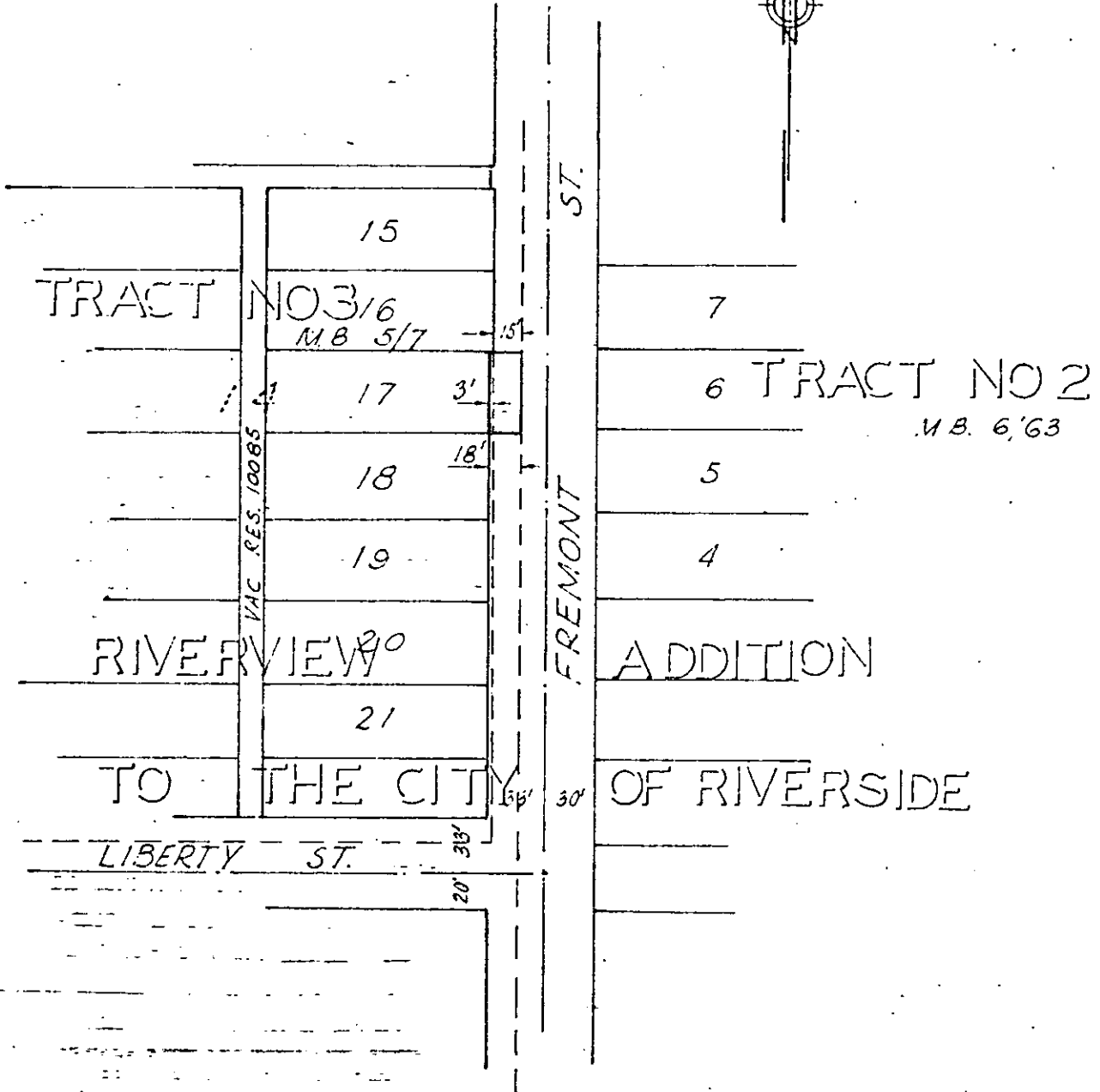

CITY OF RIVERSIDE, CALIFORNIA

PLAT OF PARCEL(S) DESCRIBED
IN THE ATTACHED DOCUMENT

*This plat is solely an aid in locating the parcel(s) described in the
attached document. It is not a part of the written description therein.*

6421

SCALE 1" = 100' DRAWN 2/27/68 BY G.S. SUBJECT 5851 FREMONT ST.

4/4