

100781

This instrument is for the benefit of City of Riverside and is entitled to be recorded without fee. (Govt. Code 6103)

EASEMENT

THIS INSTRUMENT, made this 14th day of October, 1948

by and between MARY C. DALE

party of the first part and the CITY OF RIVERSIDE, a municipal corporation of the State of California, the party of the second part;

WITNESSETH:

THAT for a valuable consideration, receipt whereof is hereby acknowledged, said party of the first part does by these presents grant unto the said party of the second part, its successors and assigns, a perpetual easement and right of way for the construction, reconstruction, maintenance, operation, inspection, repair, replacement and removal of a public utilities facilities

together with all necessary appurtenances, in, under, upon, over, and along that certain real property situated in the County of Riverside, State of California, described as follows:

The Westerly 10 feet of the Easterly 50 feet of that portion of the North one-half of the Southeast one-quarter of the Northeast one-quarter of the Northeast one-quarter of Section 24, T2S, R5W, SBB&M according to Official U. S. Government Survey, lying southeasterly of the Right of Way conveyed to the Southern Pacific Railroad Company by Deed recorded October 17, 1896, in Book 52, Page 134 of Deeds, Riverside County Records.

Excepting therefrom that portion conveyed to the State of California by Deed recorded June 10, 1957, in Book 2101, Page 3 of Official Records of Riverside County, California.

DESCRIPTION APPROVAL BY [Signature] DATE 9-27-48 PROPERTY SERVICES

DOCUMENTARY TRANSFER TAX \$ None Signature [Signature] Firm

TOGETHER WITH the right to clear and keep clear said easement and right of way from any structures or trees, to enter upon and to pass and repass

100781

over and along said real property, and to deposit tools, implements and other material thereon by said party of the second part, its officers, agents and employees and by persons under contract with it and their officers, agents and employees, whenever and wherever necessary for the purpose of constructing, reconstructing, maintaining, operating, inspecting, repairing, replacing, and removing said public utilities facilities

Provided, however, that the grantor reserves the right to use and enjoy the land over which said easement and right of way is granted, for any purpose and in any manner which does not interfere with or impair the right of the grantee to use the said easement and right of way.

IN WITNESS WHEREOF the said party of the first part has hereunto executed the within instrument the day and year first above written.

Witnessed by
Robert L. Mills
10-17-68

Mary C. Dale
MARY C. DALE

100781

CONSENT TO RECORDATION

THIS IS TO CERTIFY that the interest in real property conveyed by the Deed or Grant dated 10-17-68 From: Robert L. Mills For: to the City of Riverside, a municipal corporation, is hereby accepted for and on behalf of said City pursuant to Resolution of the City Council thereof recorded on 12-3-58 in Bk. 2374 O.R. pg. 339 Et Seq. Riverside County Records, and the Grantee hereby consents to recordation of this instrument through the undersigned, dated 10-17-68 Property Management Officer

Return Deed to: Office of City Clerk
Riverside, California

October 17th, 1968

I, the undersigned, a Notary Public in and for said State, personally appeared Robert L. Mills known to me to be the person whose name is subscribed to the within instrument, as a Witness being by me duly sworn, deposes and says: she resides in Riverside County he was present and saw Mary C. Dale known to him to be the same person described in and whose name subscribed and annexed instrument as a Part y thereto, execute and deliver the she acknowledged to said affiant that she executed the same; affiant subscribed his name thereto as a Witness.

Jean E. Manley
JEAN E. MANLEY
My Commission Expires 12-31-69
Notary Public in and for said State.

100781

6584

RECEIVED FOR RECORD
OCT 18 1968

15 Min. Past 4 o'clock

CITY OF RIVERSIDE

Recorded in Official Records
of Riverside County, California

W. D. Doherty

Recorder

FEE \$ *None*

Microfilm recording from 4-1-65. Book and page
no longer assigned. Identify by account number
and year of filing.

INDEX

100781

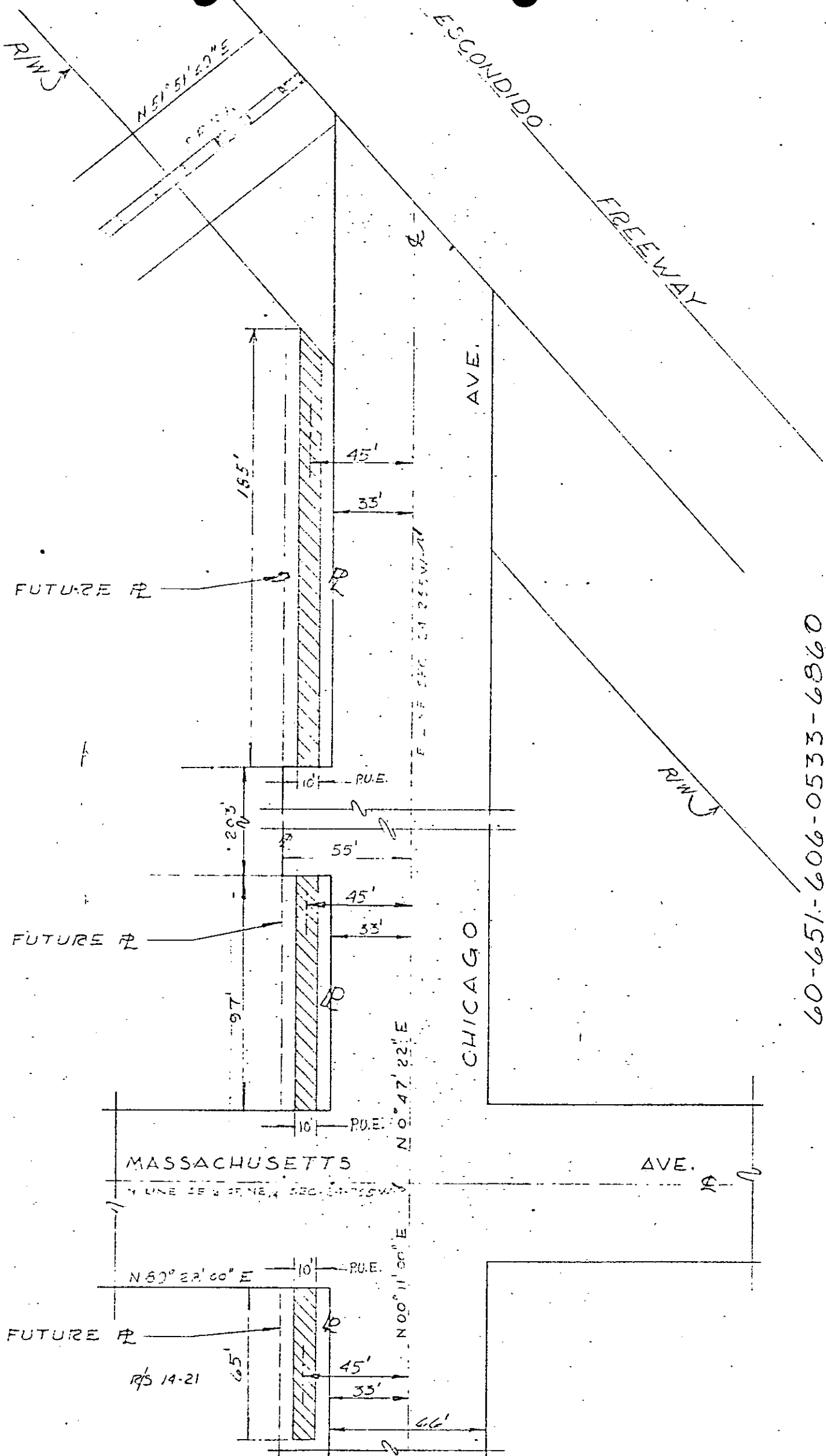

60-651-606-0533-6860

SCALE 1" = 50'	DRAWN PAYNE	CITY OF RIVERSIDE DEPARTMENT OF PUBLIC UTILITIES	ELECT DEPT.	DRAWING NO.
DATE 11-6-67	APPROVED <i>[Signature]</i>			P1-0533-A

6584