

126163

When recorded mail to:

City Clerk's Office
City Hall 211 7th Street
Riverside, Cal. 92501

CITY DEED NO. _____

Microfilm recording from 4-1-65. Book and page
no. being assigned. Identify by account number
and year of filing.

APPROVED AS TO FORM
[Signature]
DEPUTY CITY ATTORNEY
6641

DOCUMENTARY STAMPS AFFIXED \$ _____
DOCUMENTARY TRANSFER TAX
\$ _____ None
Signature [Signature]
CITY OF RIVERSIDE

The real property herein described is in the
City of Riverside.

GRANT DEED

ROBERT MARK MARTINEZ and MARGARIT J. MARTINEZ, husband and wife

Grantor S

FOR A VALUABLE CONSIDERATION, receipt of which is hereby acknowledged, do _____ hereby grant
to the CITY OF RIVERSIDE, a Municipal Corporation, the real property in the City of River-
side, County of Riverside, State of California, described as follows:

The southeasterly 8.00 feet of Lot 32 of Monterey Subdivision as
shown by map on file in Book 12, Page 24 of Maps, records of said County.

DESCRIPTION APPROVAL
by [Signature] 12/11/66 by [Signature]
Surveyor

Dated _____

[Signature]
ROBERT MARK MARTINEZ

MARGARIT J. MARTINEZ
[Signature]
[Signature]

CONSENT TO RECORDATION

THIS IS TO CERTIFY that the interest
in real property conveyed by the Deed or
Grant dated 12-29-66
From Robert Mark Martinez and Margarit J. Martinez
for the City of Riverside
to the City of Riverside, a Municipal
Corporation, is hereby accepted for and
on behalf of said City pursuant to Reso-
lution of the City Council thereof re-
corded on 12-29-66 by Inst. No. 123460,
Riverside County Records, and the Grantee
hereby consents to recordation of this
instrument through the undersigned.

Dated 12-29-66 [Signature]
Property Manager

5-38 NB

6641

126163

6641

RECEIVED FOR RECORD

DEC 27 1968

3:51 Min. Past 3 o'clock P M

At Request of

City Clerk
Recorder
of Riverside County, California

W. W. DeLoach

FEE \$ None

INDEXED

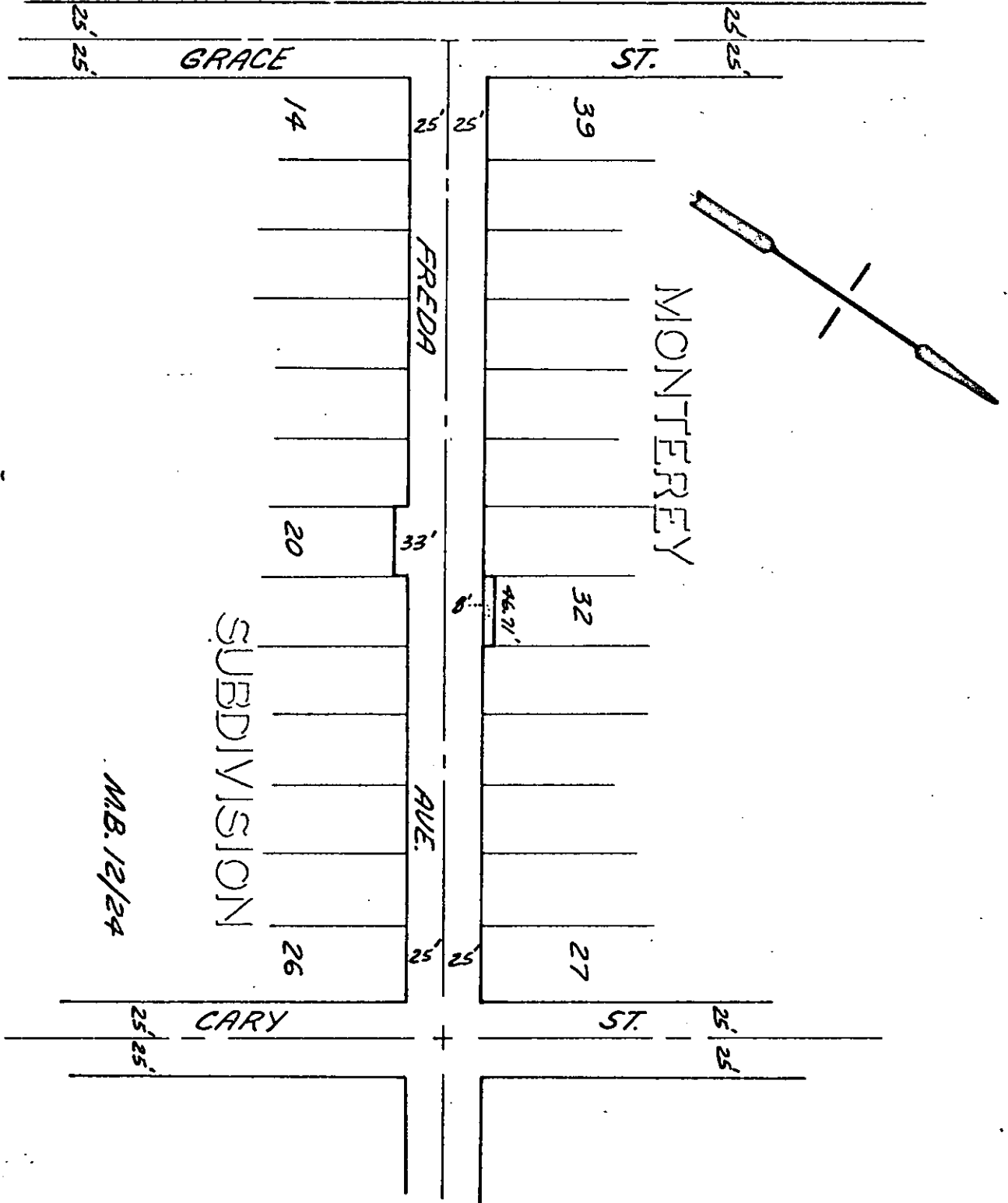

CITY OF RIVERSIDE, CALIFORNIA

PLAT OF PARCEL(S) DESCRIBED
IN THE ATTACHED DOCUMENT

A.M. 5/38

This plat is solely an aid in locating the parcel(s) described in the attached document. It is not a part of the written description therein.

SHEET 1

SCALE: 1" = 100'

DRAWN 12-11-68 BY HJB

SUBJECT 7643 FREDA AVE.-BLDG. PER.

OF 1 SHEETS

6641