

102399

When recorded mail to:

City Clerk's Office
City of Riverside
City Hall
3711 Orange St.
Riverside, Calif. 92501
Grant Deed - 5626 Brocktor Ave.

CITY DEED NO. _____

DOCUMENTARY TRANSFER TAX
\$ 1.25 None
Signature [Signature]
CITY OF RIVERSIDE d.s.

Microfilm recording from 4-1-65. See page 100
no longer assigned. Identify by account number
and year of filing.

RECEIVED FOR RECORD
OCT 9 1970
25 Min. Past 2 o'clock P.M.
At Request of
CITY CLERK
Recorded in Official Records
of Riverside County, California
W.W. [Signature]
Recorder
FEE \$ [Signature]

FOR RECORDER'S OFFICE USE ONLY

APPROVED AS TO FORM
[Signature]
DEPUTY CLERK

GRANT DEED

LILLIAN VANDERSCHRIER, a widow

Grantor

FOR A VALUABLE CONSIDERATION, receipt of which is hereby acknowledged, does
hereby grant to the CITY OF RIVERSIDE, a Municipal Corporation, the real property
in the City of Riverside, County of Riverside, State of California, described as
follows:

The southeast 2.50 feet of Lot 26 of the Rosewood Addition
as shown by map on file in Book 8, Page 33 of Maps, Records of
Riverside County, California; said 2.50 feet being measured
along the northeast line of said Lot 26.

DESCRIPTION APPROVAL
By [Signature] 10/2/70 by
Surveyor

Dated October 2, 1970

Lillian Vanderschrier
LILLIAN VANDERSCHRIER

CONSENT TO RECORDATION
THIS IS TO CERTIFY that the interest
in real property conveyed by the Deed or
Grant dated 10/2/70
From Lillian Vanderschrier

for S/E 2.50', Lot 26, Rosewood Addition
map Bk 8, p 33, Riv. Co.

to the City of Riverside, a Municipal
Corporation, is hereby accepted for and
on behalf of said City pursuant to Reso-
lution of the City Council thereof re-
corded on 12-29-66 by Inst. No. 123460,
Riverside County Records, and the Grantee
hereby consents to recordation of this
instrument through the undersigned.

Dated 10/9/70
[Signature]
Property Services Mgr.

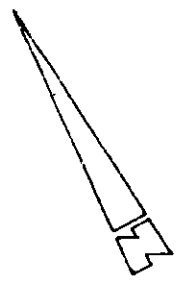

102399

N/4 LINE LOT 230 5022 LANDS
BROCKTON AVE.

POE LOT 230
S.C.A. M.B. 7/3 98.

37'

37'

30'

OAKWOOD PL.

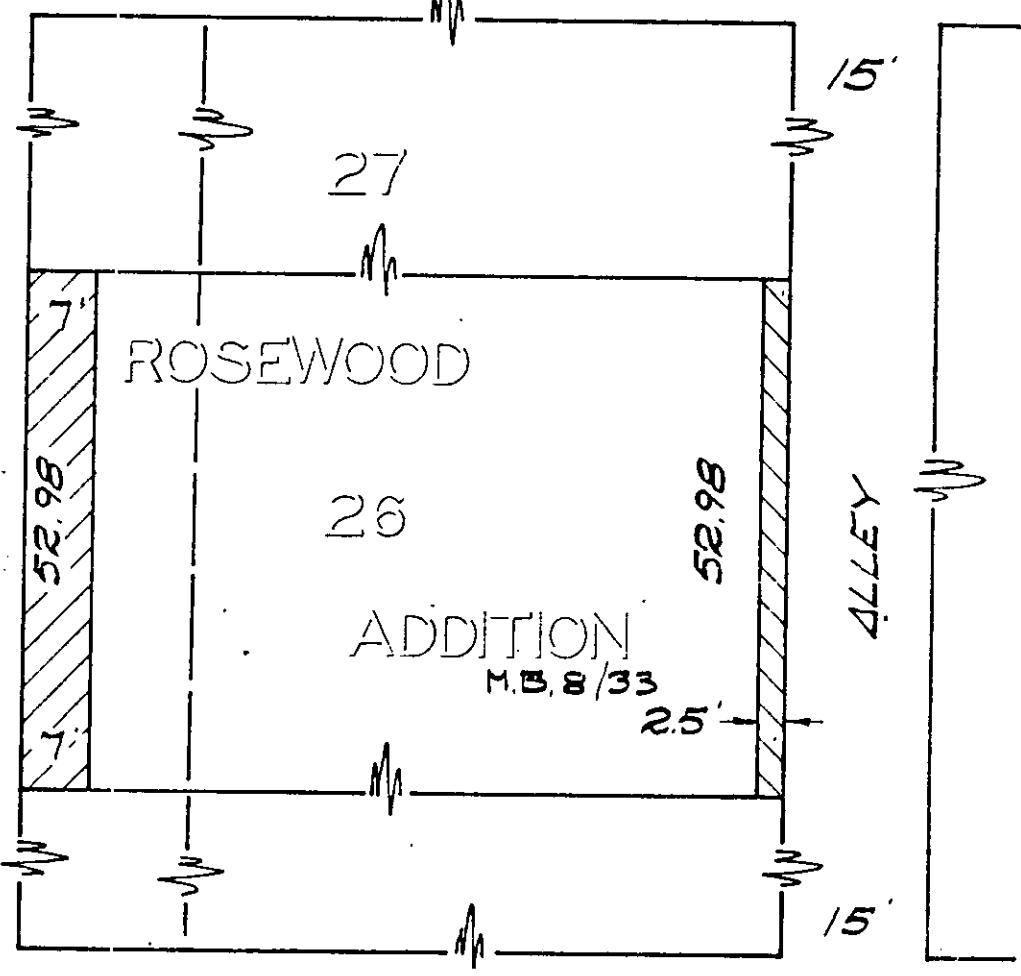

30'

ROSEWOOD PL.

CITY OF RIVERSIDE, CALIFORNIA

PLAT OF PARCEL(S) DESCRIBED
IN THE ATTACHED DOCUMENT

This plat is solely an aid in locating the parcel(s) described in the
attached document. It is not a part of the written description therein.

SHEET

1

OF 1 SHEETS

SCALE: 1" = 30'

DRAWN 10 2 70 BY YALE

SUBJECT 5626 BROCKTON AVE.

7201