

57340

When recorded mail to:

City Clerk's Office
City of Riverside
City Hall
3711 Orange St.
Riverside, California 92501
Grant Deed - C-1-690

CITY DEED NO. _____

DOCUMENTARY TRANSFER TAX
\$ _____ None
Signature [Signature]
CITY OF RIVERSIDE

GRANT DEED

RECEIVED FOR RECORD
MAY 28 1971
30 Min. Past 12 o'clock P.M.
At Request of
CITY OF RIVERSIDE
Recorded in Official Records
of Riverside County, California
W.H. DeLoach
Recorder
FEE INDEXED

FOR RECORDER'S OFFICE USE ONLY

APPROVED-AS TO FORM
[Signature]
DEPUTY CLERK

7356

ROBERT D. GERARD and CLEDITH R. GERARD, husband and wife,

Grantors

FOR A VALUABLE CONSIDERATION, receipt of which is hereby acknowledged, do
hereby grant to the CITY OF RIVERSIDE, a Municipal Corporation, the real property
in the City of Riverside, County of Riverside, State of California, described as
follows:

DESCRIPTION APPROVAL
by [Signature] Surveyor

The southeast 11.00 feet of the following described portion of Lot 14 in Block 35 of the Lands of the Riverside Land and Irrigating Company, as shown by map on file in Book 1, Page 70 of Maps, in the office of the County Recorder of the County of San Bernardino, State of California, particularly described as follows:

Commencing at a point on the southeast line of said Lot 14, a distance of 977 feet northeast from the most south corner of said Block 35; thence northeast on said southeast line of Lot 14, a distance of 122.30 feet to the true point of beginning; thence northwest and parallel with the northeast line of said Lot 14, a distance of 290 feet; thence northeast and parallel with said southeast line of Lot 14, a distance of 122.30 feet; thence southeast and parallel with said northeast line of Lot 14, a distance of 290 feet to the southeast line of said Lot; thence southwest along said southeast line of Lot 14, a distance of 122.30 feet to the point of beginning.

Dated April 27 1971

[Signature]
ROBERT D. GERARD
[Signature]
CLEDITH R. GERARD

CONSENT TO RECORDATION

57340

CONSENT TO RECORDATION

THIS IS TO CERTIFY that the interest in real property conveyed by the Deed or Grant dated 4/27/71 from Robert D. Gerard and Cledith R. Gerard for S/E 11' of por. of Lot 14, Blk 35 of Lands of Riv. L & I. Co. map bk 1, page 70 of maps, Rec. of San Ber. Co. to the City of Riverside, a Municipal Corporation, is hereby accepted for and on behalf of said City pursuant to Resolution of the City Council thereof recorded on 12-29-66 by Inst. No. 123460, Riverside County Records, and the Grantee hereby consents to recordation of this instrument through the undersigned.

Dated 5/28/71

[Signature]
Property Services Manager

7356

57340

R.L. & L. Co.
M.B. 1/70 S.B. Co.
LOT 14

35

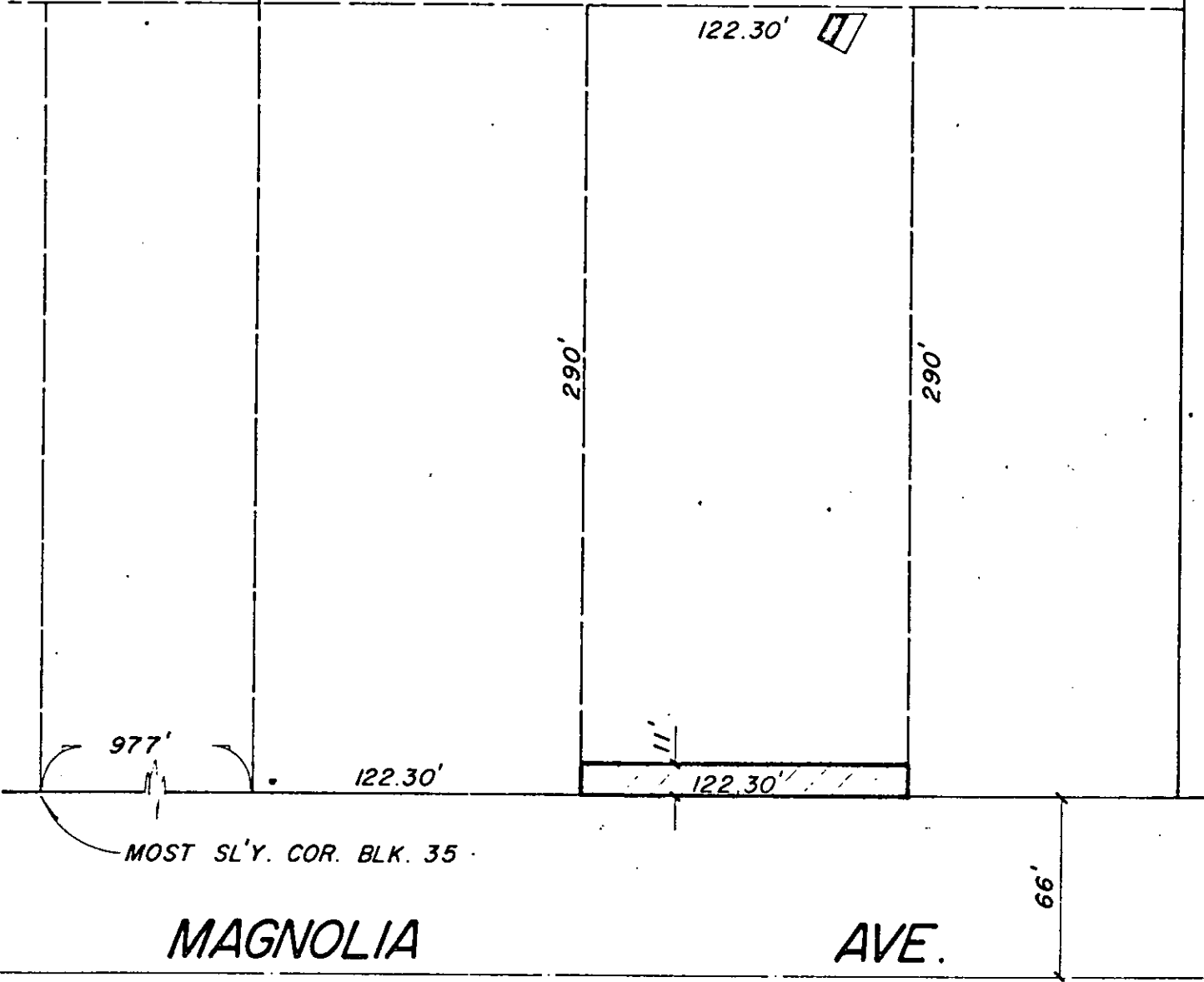

MOST SL'Y. COR. BLK. 35

MAGNOLIA

AVE.

66'

CITY OF RIVERSIDE, CALIFORNIA

6/37

PLAT OF PARCEL(S) DESCRIBED
IN THE ATTACHED DOCUMENT

This plat is solely an aid in locating the parcel(s) described in the
attached document. It is not a part of the written description therein

SCALE: 1" = 60'

DRAWN 4/27/71 BY ME

SUBJECT C-1-690

OF 1 SHEETS

7356

"Please record on behalf of and for the benefit of the City of Riverside"

DESCRIPTION APPROVAL
By *[Signature]* 5/17/71
Recorder

RECORDING REQUESTED BY

WHEN RECORDED, MAIL TO

City Clerk's Office
City of Riverside
City Hall - 3711 Orange St.
Riverside, California 92501

Microfilm recording from 4-1-65. Book and Page no longer assigned. Identify by account number and year of filing.

RECEIVED FOR RECORD

MAY 21 1971

10 Min. Past 11 o'clock A.
At Request of

CITY CLERK

Recorded in Official Records of Riverside County, California

W.H. Walsh

Recorder
FEE \$ *None*

INDEXED

SPACE ABOVE THIS LINE FOR RECORDER'S USE

Partial Reconveyance

Security-First National Bank, a National Banking Association, as Trustee under Deed of Trust dated March 16, 1964

Arlo L. Kullman and Nana R. Kullman, husband and wife,

as Trustor, and recorded on May 19, 1964, in Book 3697 Page 166

of Official Records in the office of the Recorder of Riverside County, California,

has received from Beneficiary thereunder said Deed of Trust and note or notes secured thereby for endorsement and a written request to reconvey and in accordance with said request and the provisions of said Deed of Trust, does hereby reconvey, without warranty, to the person or persons legally entitled thereto, the estate now held by it thereunder in and to that portion of the property described in said Deed of Trust, situate in the County of Riverside, California, described as:

The southeast 11.00 feet of the following described portion of Lot 14 in Block 35 of the lands of the Riverside Land and Irrigating Company, as shown by map on file in book 1, page 70 of maps, in the office of the county recorder of ~~San Bernardino~~ county of San Bernardino, State of California particularly described as follows: Commencing at a point on the southeast line of said Lot 14, a distance of 977 feet northeast from the most south corner of said block 35; thence northeast on said southeast line of Lot 14, a distance of 122.30 feet to the true point of beginning; thence northwest and parallel with the northeast line of said Lot 14, a distance of 290 feet; thence northeast and parallel with said southeast line of Lot 14, a distance of 122.30 feet; thence southeast and parallel with said northeast line of Lot 14, a distance of 290 feet to the southeast line of said Lot; thence southwest along said southeast line of Lot 14, a distance of 122.30 feet to the point of beginning.

Security-First National Bank, as Trustee,

Dated May 17, 1971

No. 934

By *Lynd Bridges*
Lynd Bridges Vice President
By *[Signature]*
Assistant Trust Officer

STATE OF CALIFORNIA }
COUNTY OF Riverside } ss.

On May 17 1971, before me, the undersigned, a Notary Public for Riverside County, California, personally appeared Lynd Bridges, known to me to be the Vice President, and *[Signature]*, known to me to be the Assistant Trust Officer of the Security-First National Bank, the Association that executed the within instrument, known to me to be the persons who executed the within instrument on behalf of the Association therein named, and acknowledged to me that such Association executed the same as Trustee.

WITNESS my hand and official seal.

(Seal)

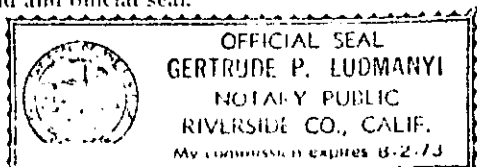

Gertrude P. Ludmany
Notary Public

"Please record on behalf of and for the benefit of the City of Riverside"

DESCRIPTION APPROVAL
By *[Signature]* 5/17/71

RECORDING REQUESTED BY

WHEN RECORDED, MAIL TO

City Clerk's Office
City of Riverside
City Hall - 3711 Orange St.
Riverside, California 92501

Microfilm recording from 4-1-65. Book and page no longer assigned. Identify by account number and year of filing.

RECEIVED FOR RECORD

MAY 21 1971

10 Min. Past 11 o'clock A

At Request of
CITY CLERK

Recorded in Official Records of Riverside County, California

W. H. Dabagh

Recorder
FEE \$ *None*

INDEXED

SPACE ABOVE THIS LINE FOR RECORDER'S USE

Partial Reconveyance

Security-First National Bank, a National Banking Association, as Trustee under Deed of Trust dated March 16, 1964

Arlo L. Kullman and Nana R. Kullman, husband and wife,

as Trustor, and recorded on May 19, 1964, in Book 3697 Page 166

of Official Records in the office of the Recorder of Riverside County, California.

has received from Beneficiary thereunder said Deed of Trust and note or notes secured thereby for endorsement and a written request to reconvey and in accordance with said request and the provisions of said Deed of Trust, does hereby reconvey, without warranty, to the person or persons legally entitled thereto, the estate now held by it thereunder in and to that portion of the property described in said Deed of Trust, situate in the County of Riverside, California, described as:

The southeast 11.00 feet of the following described portion of Lot 14 in Block 35 of the lands of the Riverside Land and Irrigating Company, as shown by map on file in book 1, page 70 of maps, in the office of the county recorder of ~~and~~ county of San Bernardino, State of California particularly described as follows: Commencing at a point on the southeast line of said Lot 14, a distance of 977 feet northeast from the most south corner of said block 35; thence northeast on said southeast line of Lot 14, a distance of 122.30 feet to the true point of beginning; thence northwest and parallel with the northeast line of said Lot 14, a distance of 290 feet; thence northeast and parallel with said southeast line of Lot 14, a distance of 122.30 feet; thence southeast and parallel with said northeast line of Lot 14, a distance of 290 feet to the southeast line of said Lot; thence southwest along said southeast line of Lot 14, a distance of 122.30 feet to the point of beginning.

Security-First National Bank, as Trustee,

By *Lynd Bridges*
Lynd Bridges Vice President

By *XXXXXXXXXX*
Assistant Trust Officer

CONSENT TO RECORDATION

THIS IS TO CERTIFY that the interest in real property conveyed by the Deed or Grant dated 5/17/71 From: Security-First Nat. Bank, Trustee For: *Lynd Bridges, President* 57E 11, L 14, B R 35, m BK 1, p 70 San Ber. Co.

to the City of Riverside, a municipal corporation, is hereby accepted for and on behalf of said City pursuant to Resolution of the City Council thereof recorded on 12-3-58 in Bk. 2374 O.R. pg. 339 et Seq. Riverside County Records. and the Grantor hereby consents to recordation of this instrument through the undersigned,

Dated 5/21/71 *[Signature]*
Property Management Officer

undersigned, a Notary Public for Riverside County, known to me to be the Vice President, known to me to be the Assistant Trust Officer of the Security-First instrument, known to me to be the persons who executed the within and acknowledged to me that such Association executed the same

Return Deed to: Office of City Clerk
Riverside, California

1
3

Gertrude P. Lubmanzi
Notary Public

ALL SECURITY TRUST SERVICES
ARE Personalized

To the officers and employees
who serve your trust

needs "Personalized"
means courteous, helpful

and sympathetic attention to
your problems — expert

workmanship at a
reasonable cost — promptness

and dependability.

OUR SERVICES INCLUDE:

Acting as Trustee

Administering estates

Acting as Guardian
of estates

SECURITY-FIRST NATIONAL BANK

LOCATION OF TRUST DEPARTMENTS

Los Angeles

— Head Office
215 West Sixth Street

— Farmers & Merchants Office
401 South Main Street

Riverside

— Citizens Divisional Office
3800 Main Street

San Diego

— San Diego Divisional Office
904 Fifth Avenue

Fresno

— Fresno Divisional Office
1058 Fulton Street

Beverly Hills

— 469 North Canon Drive

Long Beach

— 102 Pine Avenue

Pasadena

— 230 East Colorado Street

Santa Ana

— 301 North Main Street

Santa Barbara

— 834 State Street

Ventura

— 507 East Main Street

Westwood Village

— 950 Westwood Boulevard
Los Angeles 24

SECURITY-FIRST
NATIONAL BANK

INQUIRE AT ANY BRANCH

Partial
Reconveyance
of Property Covered by Deed of Trust

REGISTER NO. _____

FROM

SECURITY-FIRST NATIONAL BANK

TO

Escrow No.

Order No.

Personalized
TRUST SERVICE
available at

SECURITY-FIRST
NATIONAL BANK

regardless of
the size of your estate

TRUST DEPARTMENTS CONVENIENTLY LOCATED
TO CONVENIENTLY SERVE YOU