

When recorded mail to:

DOCUMENTARY TRANSFER TAX
\$ 0 None
Signature _____
CITY OF RIVERSIDE

CITY DEED NO. _____

RECEIVED FOR RECORD

SEP 7 1972

20 Min. Past 11 o'clock P. M.
At Request of
City of Riverside
Book 1971, Page 119812
Recorded in Official Records
of Riverside County, California

W. W. Dabagh Recorder

FEES \$ 2.00

none

FOR RECORDER'S OFFICE USE ONLY

APPROVED AS TO FORM

[Signature]
ASST. CITY ATTORNEY

7718

SEWER
EASEMENT

FOR VALUABLE CONSIDERATION, receipt of which is hereby acknowledged,
THE COUNTY OF RIVERSIDE

as Grantor, grant(s) to the CITY OF RIVERSIDE, a municipal corporation of the State of California, as Grantee, its successors and assigns, a perpetual easement and right of way for the construction, reconstruction, maintenance, operation, inspection, repair, replacement, relocation, renewal and removal of sanitary sewer facilities

together with all necessary appurtenances, in, under, upon, over and along that certain real property situated in the County of Riverside, State of California, described as follows:

A strip of land 10.00 feet in width over portions of Lots 6, 7, 8, 9, 10, 11, 12 and 13 of JARVIS SUBDIVISION, as shown by map on file in Book 5 of Maps, at Page 42 thereof, records of San Bernardino County, California, the centerline of said strip being described as follows:

Commencing at the most westerly corner of said Lot 13;

Thence southeasterly, along said southwesterly line of said Lot 13, 5.00 feet to a point in a line parallel with and distant 5.00 feet southeasterly as measured at right angles to the northwesterly line of said Lots 6, 7, 8, 9, 10, 11, 12 and 13, said point also being the TRUE POINT OF BEGINNING;

Thence northeasterly, along said parallel line, 174.00 feet to a line parallel with and distant 1.00 foot southwesterly as measured at right angles to the southwesterly line of said Lot 6;

Thence southeasterly, along last mentioned parallel line, 150.00 feet to the southeasterly line of said Lot 7 and the END of this line description.

The above described parcel of land contains an area of 3,240 square feet.

DESCRIPTION APPROVAL
by *George P. Hutchinson* 7/31/72 by *Steele*
Surveyor

119812

TOGETHER WITH the right to clear and keep clear said easement and right-of-way from any structures or trees, to enter upon and to pass and repass over and along said real property, and to deposit tools, implements and other material thereon by Grantee, its officers, agents and employees and by persons under contract with said Grantee and their officers, agents and employees, whenever and wherever necessary for the purpose of constructing, reconstructing, maintaining, operating, inspecting, repairing, replacing, relocating, renewing and removing said sanitary sewer facilities

Provided, however, that the Grantor reserves the right to use and enjoy the land over which said easement and right-of-way is granted, for any purpose and in any manner which does not interfere with or impair the right of the Grantee to use said easement and right-of-way.

THE COUNTY OF RIVERSIDE

Dated 22 August 1972

BY A. A. McCandless
A. A. McCandless, Chairman
Board of Supervisors

ATTEST: DONALD D. SULLIVAN,
County Clerk

BY _____
FORM 1. PROVED
FORM 2. PROVED
AUG 3 - 1972
RDS,
DONALD D. SULLIVAN JR.
COUNTY COUNSEL

By _____
Deputy

CONSENT TO RECORDATION

THIS IS TO CERTIFY that the interest in real property conveyed by the Deed or Grant dated 8-22-72 from County of Riverside

for 10' over Lots 6, 7, 8, 9, 10, 11, 12 & 13, Jarvis Subdiv., Bk. 5, P. 42.

to the City of Riverside, a Municipal Corporation, is hereby accepted for and on behalf of said City pursuant to Resolution of the City Council thereof recorded on 12-29-66 by Instr. No. 123450, Riverside County Records, and the Grantee hereby consents to recordation of this instrument through the undersigned.

Dated 9-7-72

[Signature]
Property Services Manager

119812

MAIN ST.

SUBDIVISION

M.B. 5/42
S.B. CO.

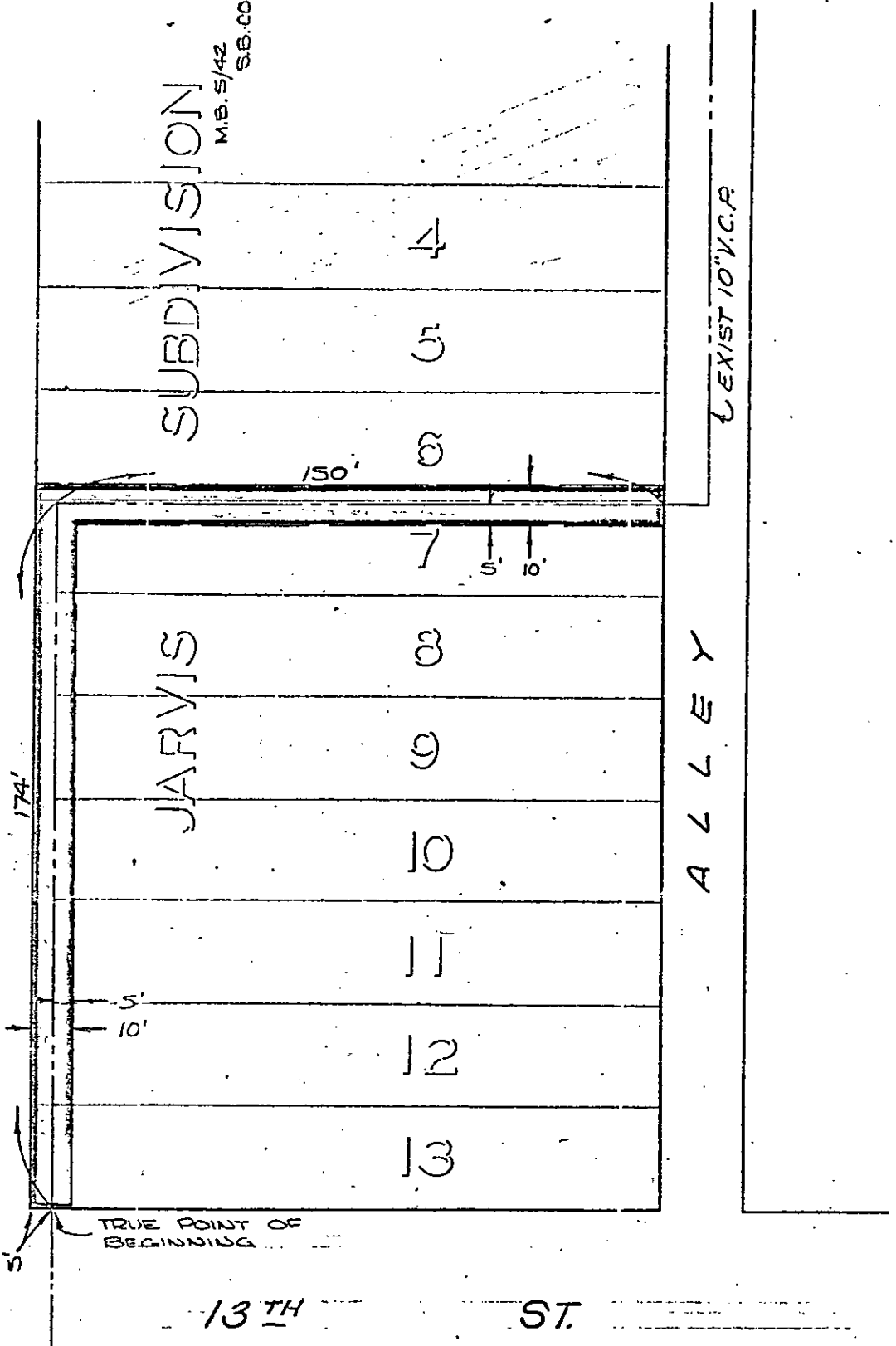

MAIN

JARVIS

ALLEY

13TH ST.

CITY OF RIVERSIDE, CALIFORNIA

THIS PLAT IS SOLELY AN AID IN LOCATING THE PARCEL(S) DESCRIBED IN THE ATTACHED DOCUMENT. IT IS NOT A PART OF THE WRITTEN DESCRIPTION THEREIN.

SHEET 1 OF 1

A.M. 1-11

SCALE: 1" = 40'

DRAWN BY Sto DATE 7/24/72

SUBJECT 10' SEWER EASEMENT (S-CBA)

7718