

119813

TOGETHER WITH the right to clear and keep clear said easement and right-of-way from any structures or trees, to enter upon and to pass and repass over and along said real property, and to deposit tools, implements and other material thereon by Grantee, its officers, agents and employees and by persons under contract with said Grantee and their officers, agents and employees, whenever and wherever necessary for the purpose of constructing, reconstructing, maintaining, operating, inspecting, repairing, replacing, relocating, renewing and removing said public utilities facilities

Provided, however, that the Grantor reserves the right to use and enjoy the land over which said easement and right-of-way is granted, for any purpose and in any manner which does not interfere with or impair the right of the Grantee to use said easement and right-of-way.

Dated 8-30-72

BEVERLY HILLS NATIONAL BANK
By [Signature]

By Raymond Mallett

CONSENT TO RECORDATION

THIS IS TO CERTIFY that the interest in real property conveyed by the Deed or Grant dated 8-30-72 from Beverly Hills National Bank

for s. 10', NW quarter, Sec. 9, Twnsp. 3 S., Range 4 W., S.B. Meridian.

to the City of Riverside, a Municipal Corporation, is hereby accepted for and on behalf of said City pursuant to Resolution of the City Council thereof recorded on 12-29-66 by Instr. No. 123450, Riverside County Records, and the Grantee hereby consents to recordation of this instrument through the undersigned

Dated 9-7-72

[Signature]
Property Services Manager

119813

NW 1/4
SEC. 9
T. 3 S. R. 4 W.
S.B.M.

SE 1/4
NE 1/4
SEC. 8
T. 3 S. R. 4 W.
S.B.M.

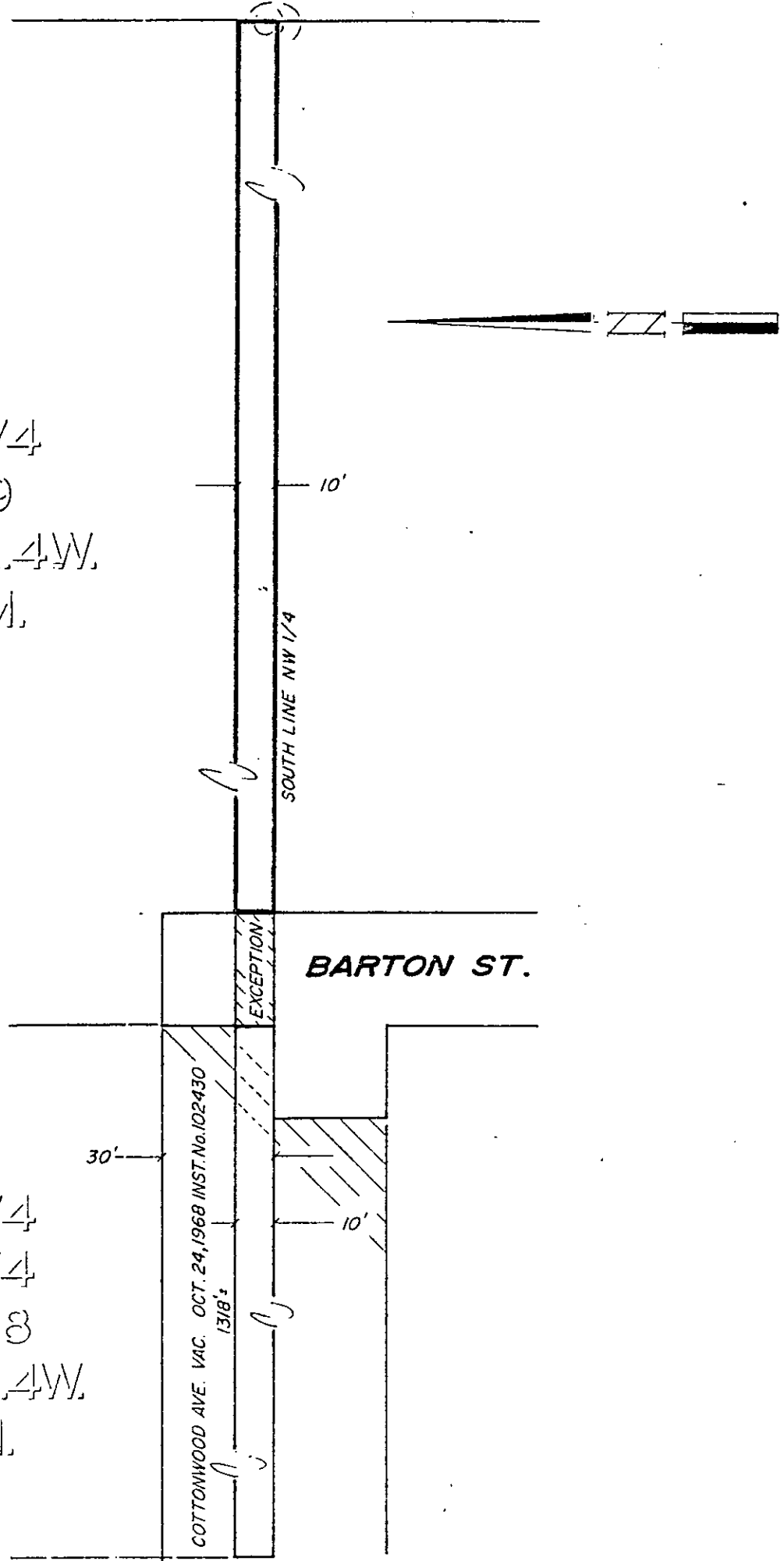

° CITY OF RIVERSIDE, CALIFORNIA °

THIS PLAT IS SOLELY AN AID IN LOCATING THE PARCEL(S) DESCRIBED IN THE ATTACHED DOCUMENT. IT IS NOT A PART OF THE WRITTEN DESCRIPTION THEREIN.

SHEET 1 OF 1

11/28/20

SCALE: 1" = 40'

DRAWN BY M.E. DATE 6/8/72

SUBJECT P.U.E. 8139

7/11/20