

When recorded mail to:

City Clerk's Office
City of Riverside
City Hall - 3711 Orange
Riverside, California 92501
Performing Arts Center - C-9
CITY DEED NO.

RECEIVED FOR RECORD

JAN 2 1973

AT 9:00 O'CLOCK A.M.

At Request of

SECURITY TITLE INSURANCE CO.

Book 1973, Page 139

Recorded in Official Records
of Riverside County, California

W.H. DeLoach Recorder

FEES \$

INDEXED

none

FOR RECORDER'S OFFICE USE ONLY

DOCUMENTARY TRANSFER TAX
\$ _____ <input checked="" type="checkbox"/> None
Signature <i>[Signature]</i>
CITY OF RIVERSIDE

7829

GRANT DEED

JOHN R. DALMAN and J. FAYE DALMAN, husband and wife

Grantor s

FOR A VALUABLE CONSIDERATION, receipt of which is hereby acknowledged, do
hereby grant to the CITY OF RIVERSIDE, a Municipal Corporation, the real property
in the City of Riverside, County of Riverside, State of California, described as
follows:

The Southerly rectangular 5 feet of Lot 14, all of Lot 15 and
the Northerly rectangular 25 feet of Lot 16 of V. S. Runnel's
Resubdivision of Block 4, Range 6 of the Town of Riverside,
as shown by Map on file in Book 6 page 1 of Maps, San Bernardino
County Records.

Witnessed by *Robert Mills*

Dated November 9, 1972

[Signature]
JOHN R. DALMAN
[Signature]
J. FAYE DALMAN

CONSENT TO RECORDATION

THIS IS TO CERTIFY that the interest
in real property conveyed by the Deed or
Grant dated November 9, 1972
From John R. Dalman and J. Faye Dalman

for S. rec. 5' Lot 14, all Lot 15 & N. rec.
25' Lot 16, VS Runnel's Resub. Bk 4, R.6, Bk.6, P.1, SB
to the City of Riverside, a Municipal
Corporation, is hereby accepted for and
on behalf of said City pursuant to Reso-
lution of the City Council thereof re-
corded on 12-29-66 by Inst. No. 123460,
Riverside County Records, and the Grantee
hereby consents to recordation of this
instrument through the undersigned

Dated 11-29-72 *[Signature]*
Property Services Mgr.

CL 122-8 R-1

APPROVED AS TO FORM

[Signature]
DEPUTY CITY RECORDER

Parcel 27

7829

407029-3601
DESCRIPTION APPROVAL
by *[Signature]* Surveyor

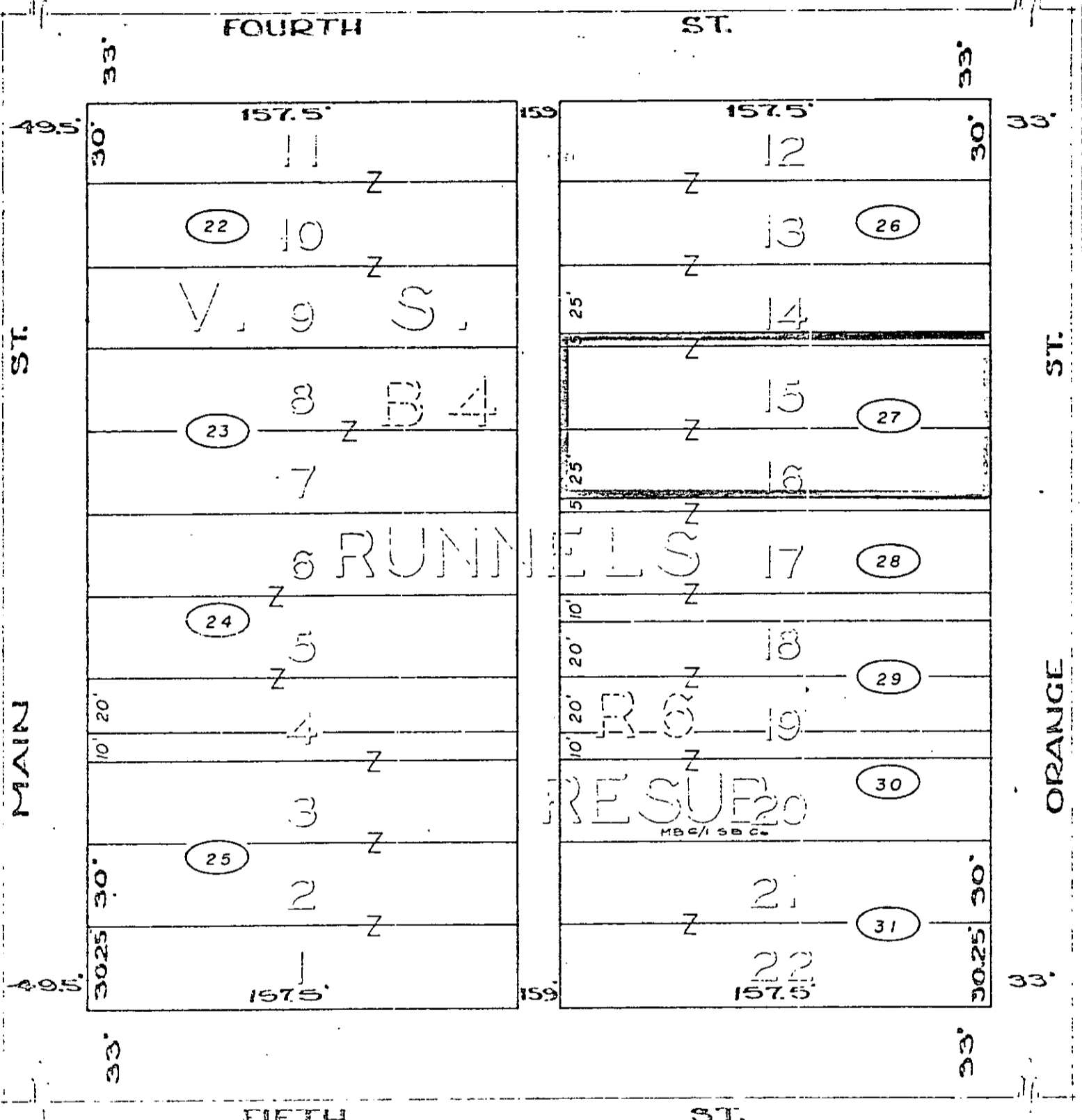
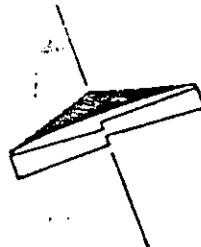

City Parcel Numbers 

CITY OF RIVERSIDE, CALIFORNIA

1-2

PLAT OF PARCEL(S) DESCRIBED IN THE ATTACHED DOCUMENT

This plat is solely an aid in locating the parcel(s) described in the attached document. It is not a part of the written description therein

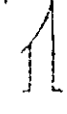
SHEET

OF 1 SHEET.

SCALE: 1" = 50'

DRAWN BY ME

SUBJECT CIVIC CENTER