

No Fee - 6103 Government Code

17946

When recorded mail to:
City Clerk's Office
City of Riverside
City Hall, 3711 Orange St.
Riverside, California 92501
R-16-689
CITY DEED NO. _____

DOCUMENTARY TRANSFER TAX \$ _____	<input checked="" type="checkbox"/> None
Signature _____	
CITY OF RIVERSIDE	

RECEIVED FOR RECORD
FEB 9 1973
17946
Recorded in Official Records
of Riverside County, California
W. W. Dwyer, Recorder
FEB 9 1973, P. 408
INDEXED

FOR RECORDER'S OFFICE USE ONLY

7869

GRANT DEED

ANNETTE W. SHOCKLEY, also known as ANN SHOCKLEY

Grantor

FOR A VALUABLE CONSIDERATION, receipt of which is hereby acknowledged, do es
hereby grant to the CITY OF RIVERSIDE, a Municipal Corporation, the real property
in the City of Riverside, County of Riverside, State of California, described as
follows:

That portion of Lot 2 of THE LANDS OF S.C.C. ASSOCIATION,
as shown by map recorded in Book 7 of Maps, at page 3
thereof, records of San Bernardino County, California,
described as follows:

The southeasterly 8.00 feet of Lot 2 of ASSESSOR'S
MAP NO. 19 on file in Book 1 of Assessor's Maps, at page
23 thereof, records of Riverside County, California.

DESCRIPTION APPROVAL

by Charles K. Hutchins 7/2/73 by [Signature]
Surveyor

Dated 1-30-73

Annette W. Shockley
ANNETTE W. SHOCKLEY
Ann Shockley
ANN SHOCKLEY

CONSENT TO RECORDATION

THIS IS TO CERTIFY that the interest
in real property conveyed by the Deed or
Grant dated January 30, 1973
From Annette W. Shockley, also known as
Ann Shockley
for That por. Lot 2 of Lands of SCC Assn.
Bk. 7, P. 3, SB
to the City of Riverside, a Municipal
Corporation, is hereby accepted for and
on behalf of said City pursuant to Reso-
lution of the City Council thereof re-
corded on 12-29-66 by Inst. No. 123460,
Riverside County Records, and the Grantee
hereby consents to recordation of this
instrument through the undersigned

Dated 2-9-73
CL 304-418 [Signature]
Property Services Mgr.

APPROVED AS TO FORM
[Signature]
DEPUTY CITY ATTORNEY

7869

17946

S.C.C. ASSOCIATION
MB 7/3 S.B. Co.

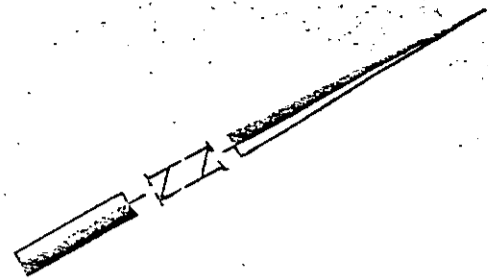

ASSESSOR'S MAP N° 19

AMB 1/23

2

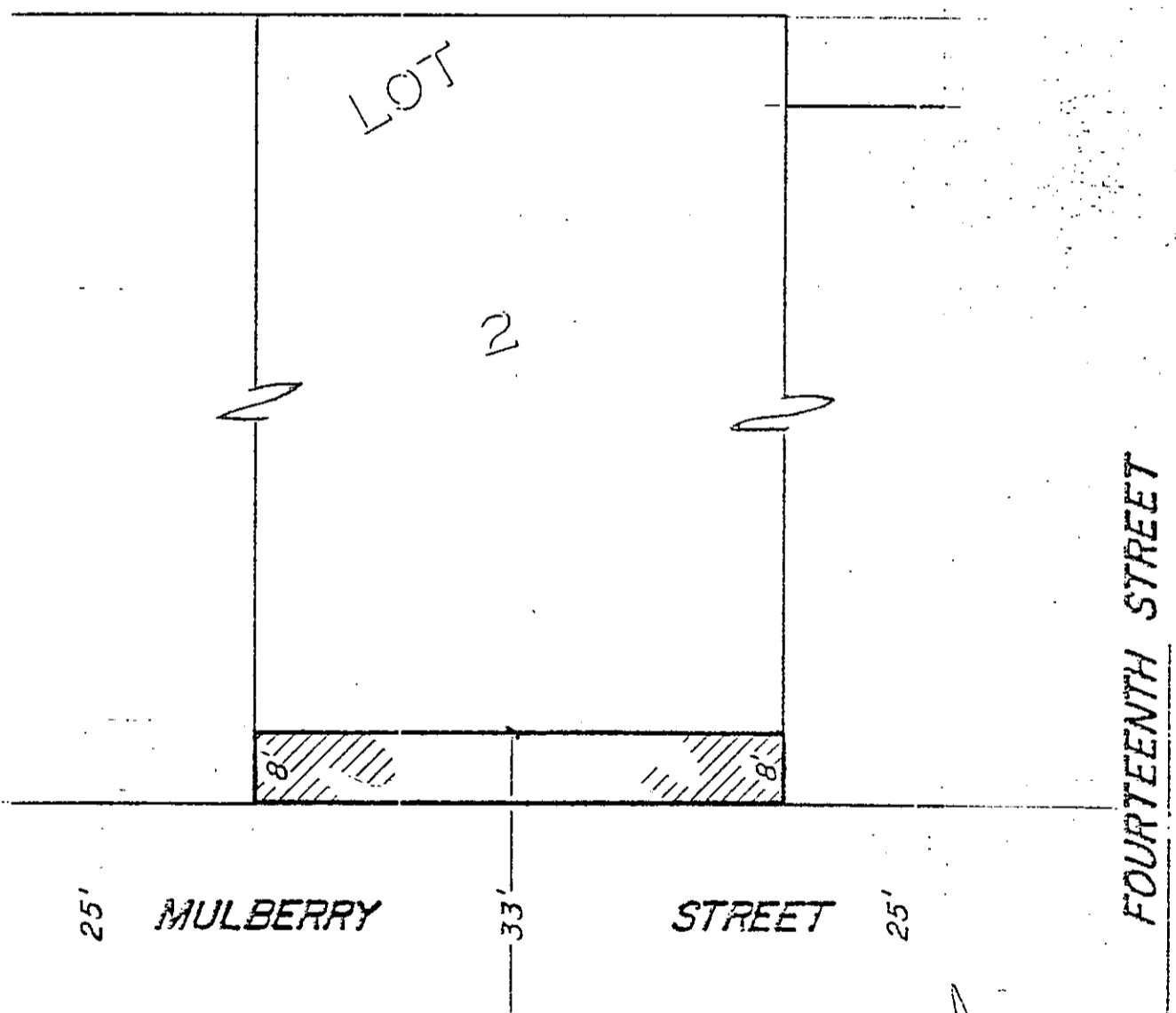

CITY OF RIVERSIDE, CALIFORNIA

THIS PLAT IS SOLELY AN AID IN LOCATING THE PARCEL(S) DESCRIBED IN THE ATTACHED DOCUMENT. IT IS NOT A PART OF THE WRITTEN DESCRIPTION THEREIN.

SHEET 1 OF 1

1/0

SCALE: 1" = 20'

DRAWN BY ME DATE 1/4/73

SUBJECT R 15-589

7869