

ORDINANCE NO. 3961

1233929

AN ORDINANCE OF THE CITY COUNCIL OF THE CITY OF RIVERSIDE, CALIFORNIA, MAKING ITS FINDINGS AND DETERMINATIONS IN THE MATTER OF RESOLUTION OF INTENTION NO. 11956; RESERVING PUBLIC UTILITY EASEMENTS AND DETERMINING THAT THE PUBLIC CONVENIENCE AND NECESSITY REQUIRE RESERVATION OF SUCH EASEMENTS; AND MAKING ITS ORDER VACATING THE WALKWAY BETWEEN REES AND PADEN STREETS.

8008

WHEREAS on September 12, 1972, the City Council of the City of Riverside adopted Resolution No. 11956 declaring its intention to order vacation of a walkway between Rees and Paden Streets and fixing the time and place of hearing all persons interested in the proposed vacation, pursuant to the provisions of the Street Vacation Act of 1941, being Sections 8300 et seq. of Part 3, Division 9 of the Streets and Highways Code of the State of California; and

WHEREAS said proposed vacation was submitted to and acted upon by the Planning Commission of the City of Riverside and notice of hearing said resolution was given as provided by said Street Vacation Act of 1941; and

WHEREAS on the day fixed for the hearing the City Council heard and considered the evidence offered by persons interested and found and hereby finds from all of the evidence submitted that the walkway ordered vacated is unnecessary for present or prospective public use;

NOW, THEREFORE, the City Council of the City of Riverside does ordain that the walkway between Rees Street and Paden Street in the City of Riverside, County of Riverside, State of California, described as follows:

Parcel 1

Lot D of CALIFORNIA MANOR, as shown by map on file in Book 27 of Maps, at page 14 thereof, records of Riverside County, California.

EXCEPTING and RESERVING therefrom an easement

CITY ATTORNEY
RIVERSIDE
CALIFORNIA

REQUEST FOR RECORDATION

Request of City Clerk for recordation of this
Instrument, and return to,
City Clerk, Room 10, City Hall,
Riverside, California

123929

1
2
3
4
5
6
7
8
9
10
11
12
13
14
15
16
17
18
19
20
21
22
23
24
25
26
27
28
29
30
31
32

over the southwest 10.00 feet of said lot D for telephone lines, drainage and public utilities facilities.

Parcel 2

Lot D of CALIFORNIA MANOR UNIT NO. 2, as shown by map on file in Book 30 of Maps, at page 67 thereof, records of Riverside County, California.

EXCEPTING and RESERVING therefrom an easement over the northeast 5.00 feet of said Lot D for telephone lines and public utilities facilities,

(be and the same is hereby vacated.)

BE IT FURTHER ORDAINED that the City Council does hereby determine that the public convenience and necessity require the reservation of a permanent public utility easement and right of way for the transportation or distribution of electric energy, and a permanent easement and right of way to construct, place, operate, inspect, maintain, repair, replace and remove such aerial and underground telephone, telegraph and communication structures as the Pacific Telephone and Telegraph Company may from time to time require consisting of poles, anchors, wires, cables, conduits, manholes, markers and necessary fixtures and appurtenances; including access and the right to keep the property free from inflammable materials and wood growth that would interfere with the use of said permanent easements and rights of way.

IT IS FURTHER ORDAINED that the City Clerk of said City of Riverside shall cause a certified copy of this order, attested by the City Clerk under the seal of said City to be recorded in the office of the County Recorder of Riverside County, California.

IT IS FURTHER ORDAINED that the City Clerk shall certify to the adoption of this ordinance and cause it to be published once in The Press . This ordinance shall become effective on the 30th day after the date of its adoption.

ADOPTED by the City Council and signed by the Mayor and attested by the City Clerk this 24th day of October, 1972.

Attest:

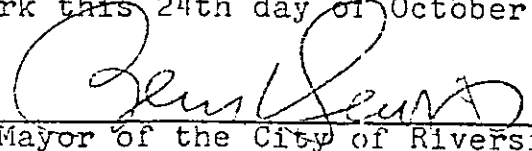
Mayor of the City of Riverside

City Clerk of the City of Riverside

CITY ATTORNEY
RIVERSIDE
CALIFORNIA

123929

1
2
3
4
5
6
7
8
9
10
11
12
13
14
15
16
17
18
19
20
21
22
23
24
25
26
27
28
29
30
31
32

I, Virginia J. Strohecker, City Clerk of the City of Riverside, California, hereby certify that the foregoing ordinance was duly and regularly introduced at a meeting of the City Council on the 10th day of October, 1972, and that thereafter the said ordinance was duly and regularly adopted at a meeting of the City Council on the 24th day of October, 1972, by the following vote, to wit:

Ayes: Councilmen Holcomb, Sotelo, Pick, Scott, Wanamaker, Digati and Macomber.

Noes: None.

Absent: None.

IN WITNESS WHEREOF I have hereunto set my hand and affixed the official seal of the City of Riverside, California, this 24th day of October, 1972.

Virginia J. Strohecker
City Clerk of the City of Riverside

123929

PADEN

STREET

TO CALIFORNIA AVE.

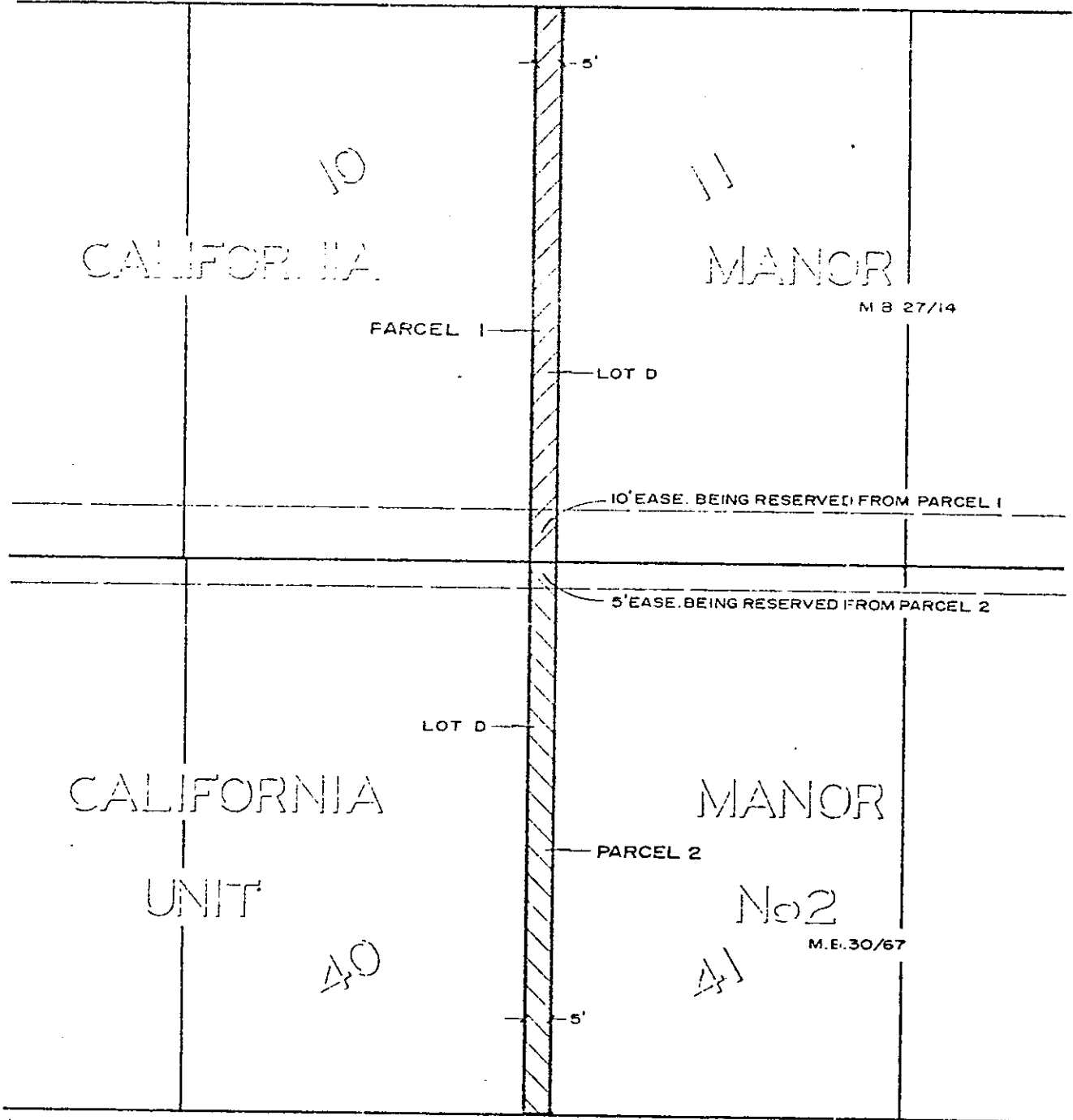

TO GARFIELD ST.

REES

STREET

CITY OF RIVERSIDE, CALIFORNIA

THIS PLAT IS SOLELY AN AID IN LOCATING THE PARCEL(S) DESCRIBED IN THE ATTACHED DOCUMENT. IT IS NOT A PART OF THE WRITTEN DESCRIPTION THEREIN.

SHEET 1 OF 1

5/9

SCALE 1" = 30'

DRAWN BY ME DATE 8/25/72

SUBJECT WALKWAY VACATION, BET REES & PADEN STREETS