

No Fee - 6103 Government Code
56578

When recorded mail to:
City Clerk's Office
City of Riverside
City Hall, 3711 Orange Street
Riverside, California 92501

RECEIVED FOR RECORD
MAY 10 1974
10 Min. Past 3 o'clock P.M.
At Request of
CITY CLERK
Book 1974, Page 56578
Recorded in Official Records
of Riverside County, California
W.H. DeLoach Recorder
FEES & INDEXED

DOCUMENTARY TRANSFER TAX
\$ _____ None
Signature [Signature]
CITY OF RIVERSIDE

FOR RECORDER'S OFFICE USE ONLY

GRANT DEED

0473

MARK C. BLOOME CO., INC., A California Corporation

_____, Grantor_____,
FOR A VALUABLE CONSIDERATION, receipt of which is hereby acknowledged,
does hereby grant to the CITY OF RIVERSIDE, a Municipal Corporation,
the real property in the City of Riverside, County of Riverside, State
of California, described as follows:

All that portion of Lot 1 in Block 16 of the Lands of
THE RIVERSIDE LAND & IRRIGATING COMPANY, on file in
Book 1 of Maps, at page 70 thereof, records of San
Bernardino County, California, described as follows:

BEGINNING at the northwest corner of that certain parcel
of land conveyed to the City of Riverside, a municipal
corporation, by a deed recorded December 1, 1966, as
Instrument No. 115472 of Official Records of Riverside
County, California; said corner also being in a line
which is parallel with and distant 47.00 feet south,
as measured at right angles, from the centerline of
ARLINGTON AVENUE;

Thence South 0° 18' 00" East, along the west line of said
parcel and along the south prolongation of said west line, 8.00
feet to a line which is parallel with and distant 55.00
feet south, as measured at right angle, from said centerline
of ARLINGTON AVENUE;

Thence South 89° 42' 00" West, along said parallel line,
132.32 feet to the east line of that certain parcel of
land conveyed to Ira Fallon Jr., et ux, by a deed recorded
July 29, 1966, as Instrument No. 77539 of Official Records
of Riverside County, California;

Thence North 0° 18' 00" West, along said east line to said
parallel line which is parallel with and distant 47.00
feet south, as measured at right angle, from said center-
line of ARLINGTON AVENUE;

Thence North 89° 42' 00" East, along said parallel line,
132.32 feet to the point of beginning.

Area: 1058.67 square feet.

DESCRIPTION APPROVAL
by George P. Hutchinson 4/29/74 by [Signature]
Surveyor

8173

56578

MARK C. BLOOME CO., Inc. a
California Corporation

Dated 4/30/74

By Jerry Fields Pres

By _____

APPROVED AS TO FORM

Edward Reed
ASSISTANT ATTORNEY

CONSENT TO RECORDATION

STATE OF CALIFORNIA,

COUNTY OF LOS ANGELES

ss.

ON APRIL 30, 19 74,

before me, the undersigned, a Notary Public in and for said State, personally appeared
JERRY FIELDS

_____, known to me to be the
PRESIDENT

of the MARK C. BLOOME CO., INC.

the Corporation that executed the within Instrument, known to me to be the person who
executed the within Instrument, on behalf of the Corporation, therein named, and acknowledged
to me that such Corporation executed the same.

WITNESS my hand and official seal.

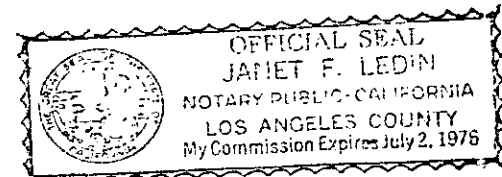

JANET F. LEDIN

My Commission Expires July 2, 1976

Janet F. Ledin
Notary Public in and for said State.

8173

56578

56578

Parcel conveyed to
Ira Fallon by deed
recorded 7/29/66
as inst. no. 77539
O.R. Riv. Co.

N 0° 18' W

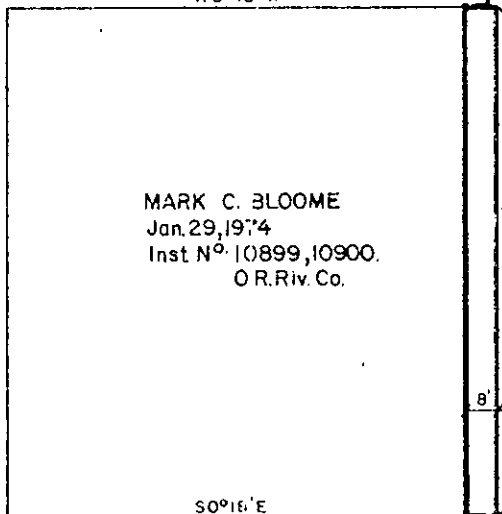

MARK C. BLOOME
Jan. 29, 1974
Inst N° 10899, 10900.
O.R. Riv. Co.

94.02'

132.32'

Avenue

S 89° 42' W

8'

47'

Conveyed to the City
of Riverside by a
deed rec. 12/1/66
as inst. no. 115472.
O.R. Riv. Co.

Arlington

50'

R.L. & I. Co.
M.B. 1/70 S.B.C.O.

Block 16

Lot 1

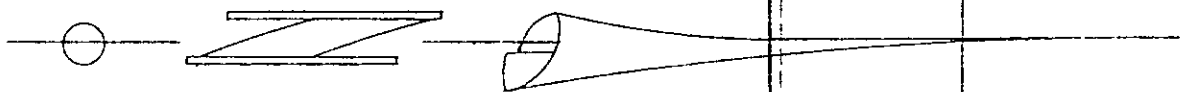

Madison St.

N 34° 00' W

° CITY OF RIVERSIDE, CALIFORNIA °

THIS PLAT IS SOLELY AN AID IN LOCATING THE PARCEL(S) DESCRIBED IN THE
ATTACHED DOCUMENT. IT IS NOT A PART OF THE WRITTEN DESCRIPTION THEREIN.

SHEET 1 OF 1

5/10

SCALE: 1" = 50'

DRAWN BY J.V. DATE 4 / 25 / 74

SUBJECT R-27-734

8173