

109354

After recordation, return to:

City Clerk's Office
City of Riverside, City Hall
3711 Orange Street
Riverside, California 92501
GP Amendment-Indiana Ave.

APPROVED AS TO FORM

[Signature]
CITY ATTORNEY

OFFER OF DEDICATION

On this 12 day of August 1974, STEVE P. DE GENNARO and IRENE V. DE GENNARO, husband and wife as joint tenants, and STEVE J. DE GENNARO and NORMA JEAN DE GENNARO, husband and wife as joint tenants, irrevocably offer for dedication to the CITY OF RIVERSIDE, a municipal corporation, pursuant to the provisions of California Government Code Section 7050, for public alley purposes, together with all rights to construct and maintain utilities, sewers, drains and other improvements consistent with the use as a public street and highway, that real property located in the City of Riverside, County of Riverside, State of California, and more particularly described as follows:

The southeasterly 20 feet of Lot 13 in Block 6 of ORANGE ACRES, on file in Book 13 of Maps, at page 7 thereof, records of Riverside County, California; said southeasterly 20 feet being measured at right angle 20 feet northwesterly from the southeasterly line of said Lot 13.

DESCRIPTION APPROVAL

by *[Signature]* 6/10/74 by *[Signature]*
Surveyor

DATED August 12, 1974

Irene V. DeGennaro
IRENE V. DE GENNARO
Steve P. DeGennaro
STEVE P. DE GENNARO
Steve J. DeGennaro
STEVE J. DE GENNARO
Norma Jean DeGennaro
NORMA JEAN DE GENNARO

109354

STATE OF CALIFORNIA,

COUNTY OF RIVERSIDE

ss.

ON August 12
before me, the undersigned, a Notary Public in and to:
Steve P. DeGennaro, Irene V. DeGennaro,
Steve J. DeGennaro and Norma Jean DeGennaro

to be the person s whose name s are _____ subscribed to the within Instrument, and acknowledged to me that t he y executed the same.

WITNESS my hand and official seal

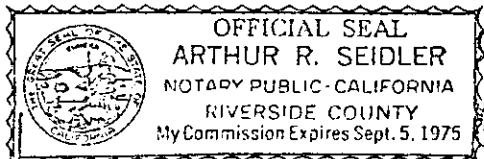

[Signature]
Notary Public in and for said State.

Read or

260

109354

MARY STREET

N33°56'W

CONVEYED TO THE CITY OF RIVERSIDE, 5/23/74 AS INST. NO. 51259

AVENUE

N49°34'E

INDIANA

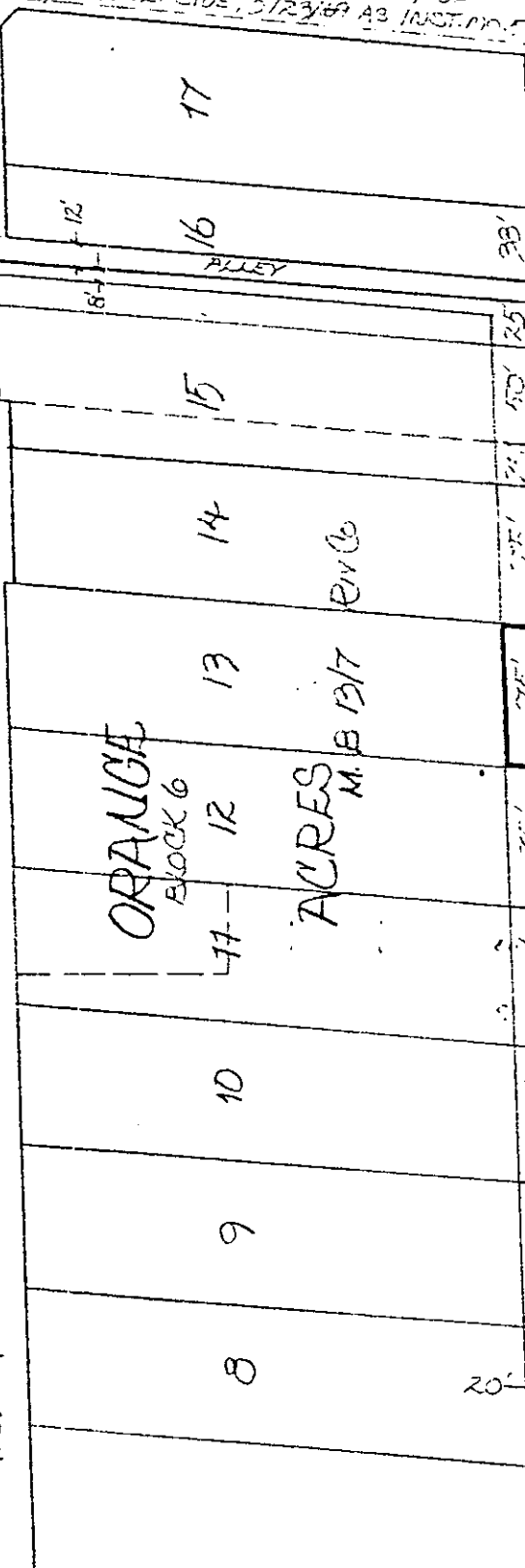

Atchison Topeka & Santa Fe R.R. N49°34'E

CITY OF RIVERSIDE, CALIFORNIA

8760

THIS PLAT IS SOLELY AN AID IN LOCATING THE PARCEL(S) DESCRIBED IN THE ATTACHED DOCUMENT. IT IS NOT A PART OF THE WRITTEN DESCRIPTION THEREIN.

SHEET 2 OF 2

5/32

SCALE: 1" = 100'

DRAWN BY J.V. DATE 5/23/74

SUBJECT C.P. Amendment - Indiana Ave.