

115778

GRANT DEED

RECEIVED FOR RECORD  
SEP 10 1974

AT 9:00 O'CLOCK A.M.  
At Request of  
FIRST AMERICAN TITLE COMPANY  
OF RIVERSIDE

Book 1974, Page 115778  
Recorded in Official Records  
of Riverside County, California

Wyo. Doherty Recorder

INDEXED

*NO TAX*

FOR A VALUABLE CONSIDERATION, receipt of which is hereby acknowledged, the CITY OF RIVERSIDE, a municipal corporation, hereby GRANTS to THE PARKING AUTHORITY OF THE CITY OF RIVERSIDE, A public body corporate and politic,

the real property in the City of Riverside, County of Riverside, State of California, described as follows:

8310 P

Parcel 1

That portion of Block 7, Range 7 of the TOWN OF RIVERSIDE, as shown by Map on file of the subdivision of said Block 7, Range 7, recorded in Book 1, page 54 of Maps, Records of San Bernardino County, California, described as follows:

BEGINNING at a point on the easterly line of Market Street, 100 feet southerly from the northwesterly corner of said Block; THENCE easterly parallel with the southerly line of Seventh Street, 90 feet; THENCE southerly parallel with the easterly line of Market Street 30 feet, more or less, to the northerly line of Lot 10, as shown on said Map; THENCE westerly on the northerly line of said Lot 10, a distance of 10 feet; THENCE southerly, parallel with the easterly line of Market Street, 40 feet, more or less, to the southerly line of said Lot 10; THENCE westerly on the southerly line of said Lot 10, a distance of 80 feet to the easterly line of Market Street; THENCE northerly on the easterly line of Market Street, 70 feet, more or less, to the point of beginning.

Parcel 2

That portion of Block 7, Range 7 of the TOWN OF RIVERSIDE, as shown by Map recorded in Book 7, page 17 of Maps, Records of San Bernardino County, California, described as follows:

BEGINNING at the northwest corner of said Block; THENCE southerly on the westerly line of said Block, 100 feet to the true point of beginning; THENCE easterly, parallel with the southerly line of Seventh Street, 90 feet; THENCE northerly, parallel with the westerly line of said Lot, a distance of 50 feet to the most southerly corner of the land conveyed to S. G. Stalder, a widower, by Deed recorded June 28, 1962 as Instrument No. 60242 of Official Records of Riverside County, California; THENCE northwesterly along the southwesterly line of said land conveyed to S. G. Stalder, 90 feet to said easterly line of Market Street; THENCE southerly along said easterly line of Market Street, 50 feet to the point of beginning.

Parcel 3

That portion of Block 7, Range 7, of the TOWN OF RIVERSIDE, as shown by Map recorded in Book 7, page 17 of Maps, Records of San Bernardino County, California, described as follows:

8310 P

1985546 DRL

115778

Beginning at a point on the southerly line of Seventh Street, 90 feet easterly from the northwesterly corner of Block 7, Range 7;  
 THENCE easterly along the southerly line of Seventh Street, 70 feet to the westerly line of an alley;  
 THENCE southerly along the westerly line of said alley and parallel with the easterly line of Market Street, 170 feet to the southeast corner of Lot 10, as shown on said map;  
 THENCE westerly along the southerly line of said Lot 10, a distance of 80 feet;  
 THENCE northerly and parallel with the easterly line of Market Street, 40 feet to the northerly line of said Lot 10;  
 THENCE easterly along the northerly line of said Lot 10, a distance of 10 feet;  
 THENCE northerly and parallel with the easterly line of Market Street, 130 feet to the point of beginning;

EXCEPTING therefrom that portion described as follows:

BEGINNING at a point on the southerly line of Seventh Street, 90 feet easterly from the northwesterly corner of Block 7, Range 7;  
 THENCE easterly along the southerly line of Seventh Street, 70 feet to the westerly line of an alley;  
 THENCE southerly along the westerly line of said alley and parallel with the easterly line of Market Street, 50 feet;  
 THENCE westerly and parallel with the southerly line of Seventh Street, 70 feet;  
 THENCE northerly and parallel with the easterly line of Market Street, 50 feet to the point of beginning.

DESCRIPTION APPROVAL  
 By Wendy F. Adams by W.F.A.  
 for Surveyor

APPROVED AS TO FORM

Daniel Dwyer  
 ASST. CITY ATTORNEY

115778

STATE OF CALIFORNIA )  
 COUNTY OF RIVERSIDE ) ss

On this 10th day of September 19 74, before me, Wendy F Adams, a Notary Public in and for said County and State, personally appeared BERNARD H. LEWIS, Mayor, and ALICE A. HARE, Assistant City Clerk of the City of Riverside, California, the municipal corporation described in and which executed the within instrument, and acknowledged to me that such municipal corporation executed the same.

IN WITNESS WHEREOF I have hereunto set my hand and affixed my official seal the day and year in this certificate first above written.

Wendy F Adams  
 Notary Public in and for the County of  
 Riverside, State of California

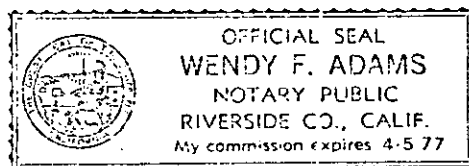

8310P

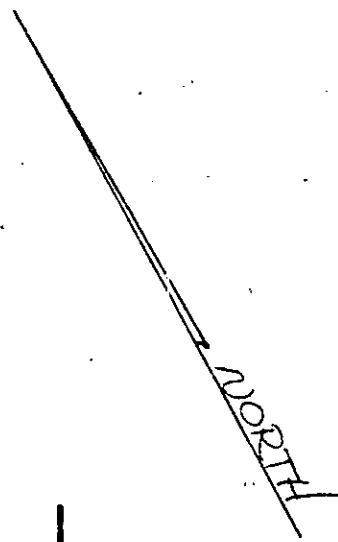

SEVENTH STREET

MARKET STREET

MAIN STREET

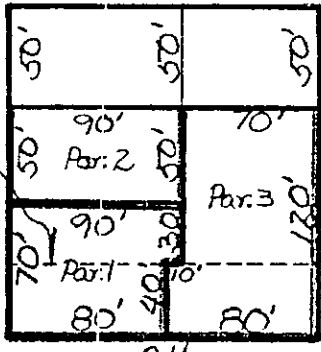

Map of  
THE  
SUBDIVISION  
OF  
BLOCK 7  
RANGE 7  
OF  
RIVERSIDE  
San Bernardino Co.  
California  
MB 1/54  
SB Co.

UNIVERSITY AVE.

CITY OF RIVERSIDE, CALIFORNIA

THIS PLAT IS SOLELY AN AID IN LOCATING THE PARCEL(S) DESCRIBED IN THE ATTACHED DOCUMENT. IT IS NOT A PART OF THE WRITTEN DESCRIPTION THEREIN.

SHEET 1 OF 1

1/5

SCALE: 1" = 100'

DRAWN BY SV DATE 7/25/74

SUBJECT Parking Lot 21 Parcel 16

115778

CERTIFICATE OF ACCEPTANCE

This is to certify that the interest in real property conveyed by the Grant Deed, dated September 10, 1974, from the City of Riverside to the Parking Authority of the City of Riverside, a public body, corporate and politic of the State of California, Grantee is hereby accepted by order of such Authority, and the Grantee consents to recordation thereof by its duly authorized officer.

Dated: September 10, 1974.

Parking Authority of the City  
of Riverside

By *[Signature]*  
Chairman

Subscribed and sworn to before me this 10th day of  
September, A.D. 1974.

*[Signature]*  
Notary Public

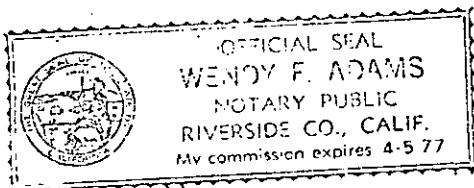

8310P