

148798

When recorded mail to

City Clerk's Office
City of Riverside
City Hall, 3711 Orange Street
Riverside, California 92501
R-76-656

DOCUMENTARY TRANSFER TAX
\$ None

Signature _____
CITY OF RIVERSIDE

RECEIVED FOR RECORD

DEC 1 1975

30 Min. Post Office of Clerk
ALLEGANT of
CITY CLERK

Book 1975, Page 148798

Recorded in Official Records of Riverside County, California

W. B. Dobbins Recorder

FEES \$ 12.75

INDEXED

FOR RECORDER'S OFFICE USE ONLY

GRANT DEED

8534

CROCKER NATIONAL BANK Successor to
UNITED STATES NATIONAL BANK, as Trustee under the Riverside Medical

Clinic Retirement Plan and Trust, Grantor

FOR A VALUABLE CONSIDERATION, receipt of which is hereby acknowledged,
does hereby grant to the CITY OF RIVERSIDE, a Municipal Corporation,
the real property in the City of Riverside, County of Riverside, State
of California, described as follows:

The Southwesterly 4.00 feet of Lots 9 and 10 in
Block 4 of ORANGE ACRES, on file in Book 13 of Maps,
at Page 7 thereof, Records of Riverside County,
California; said southwesterly 4.00 feet being
measured at right angles 4.00 feet Northeasterly from
the Southwesterly line of said Lots 9 and 10.

DESCRIPTION APPROVAL
George Pittel 10/27/75 by [Signature]

CROCKER NATIONAL BANK Successor to
UNITED STATES NATIONAL BANK,
as Trustee under the Riverside
Medical Clinic Retirement Plan
and Trust

Dated November 14, 1975

BY W. B. Richards, Trust Officer
BY Michael Dobbins

APPROVED AS TO FORM
John Woodhree
CITY ATTORNEY

ON November 14, 19 75,

before me, the undersigned, a Notary Public in and for said State, personally appeared
W. B. Richards and Michael Dobbins

Trust Officer and Vice President

of the Crocker National Bank
the Corporation that executed the within Instrument, known to me to be the person who
executed the within Instrument, on behalf of the Corporation, therein named, and acknowledged
to me that such Corporation executed the same.

WITNESS my hand and official seal.

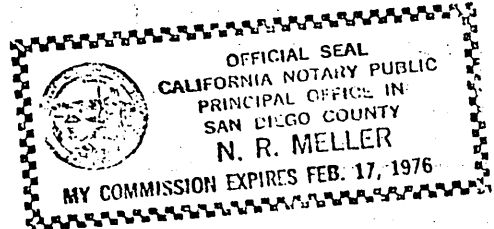

N. R. Meller
Notary Public in and for said State.

8534

1487

148798

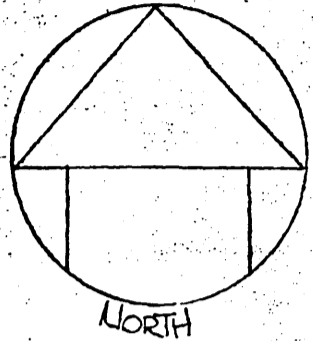

• CITY OF RIVERSIDE, CALIFORNIA •

THIS PLAT IS SOLELY AN AID IN LOCATING THE PARCEL(S) DESCRIBED IN THE ATTACHED DOCUMENT. IT IS NOT A PART OF THE WRITTEN DESCRIPTION THEREIN.

SHEET 1 OF 1

5/32

SCALE: 1" = 100'

DRAWN BY J.O. DATE 10/21/75

SUBJECT R-76-656

8534