

171274

RESOLUTION NO. 12936

A RESOLUTION OF THE CITY COUNCIL OF THE CITY OF RIVERSIDE, CALIFORNIA, ACCEPTING A ONE-FOOT BARRIER STRIP WITHIN TRACT 5486-1 (WHICH BARRIER STRIP ADJOINS TRACT 5486-2) FOR STREET PURPOSES TO BE KNOWN AS A PORTION OF JOSHUA TREE DRIVE.

8791

BE IT RESOLVED by the City Council of the City of Riverside, California, that the following one-foot barrier strip is hereby accepted to public use for street purposes to be known as a portion of Joshua Tree Drive:

Lot F (1' barrier strip) of Tract No. 5486-1, as shown by map on file in Book 85 of Maps, at pages 32 through 34 inclusive thereof, Records of Riverside County, California.

ADOPTED by the City Council and signed by the Mayor and attested by the City Clerk this 2nd day of November, 1976.

Gene Lawton
Mayor of the City of Riverside

Attest:

Alice A. Hare
City Clerk of the City of Riverside

171274

RECEIVED FOR RECORD

NOV 8 1976

30 Min. Past 9 o'Clock A.M.
Request of City Clerk

CITY OF RIVERSIDE
Book 1976, Page 171274
Recorded in Official Records
of Riverside County, California

W. H. Douglas
Recorder
FEES \$

REQUEST FOR INSTRUMENT

Request of City Clerk for recording of this instrument, and return to, City Clerk, Room 10, City Hall, Riverside, California

CITY ATTORNEY
RIVERSIDE
CALIFORNIA

8791

171274

1
2
3
4
5
6
7
8
9
10
11
12
13
14
15
16
17
18
19
20
21
22
23
24
25
26
27
28
29
30
31
32

I, Alice A. Hare, City Clerk of the City of Riverside, California, hereby certify that the foregoing resolution was duly and regularly introduced and adopted by the City Council of said City at its meeting held on the 2nd day of November, 1976, by the following vote, to wit:

Ayes: Councilmen Pintor, Anderson, Scott, Lorenzi and Abraham.

Noes: None.

Absent: Councilman Haley.

IN WITNESS WHEREOF I have hereunto set my hand and affixed the official seal of the City of Riverside, California, this 2nd day of November, 1976.

Alice A. Hare
City Clerk of the City of Riverside

JW/lfc

CITY ATTORNEY
RIVERSIDE
CALIFORNIA

8791

171274

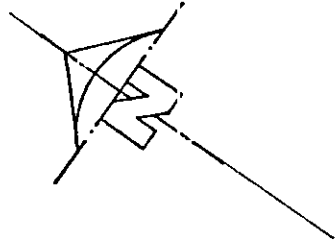

LOT "F"
(L. PARCEL STRIP)

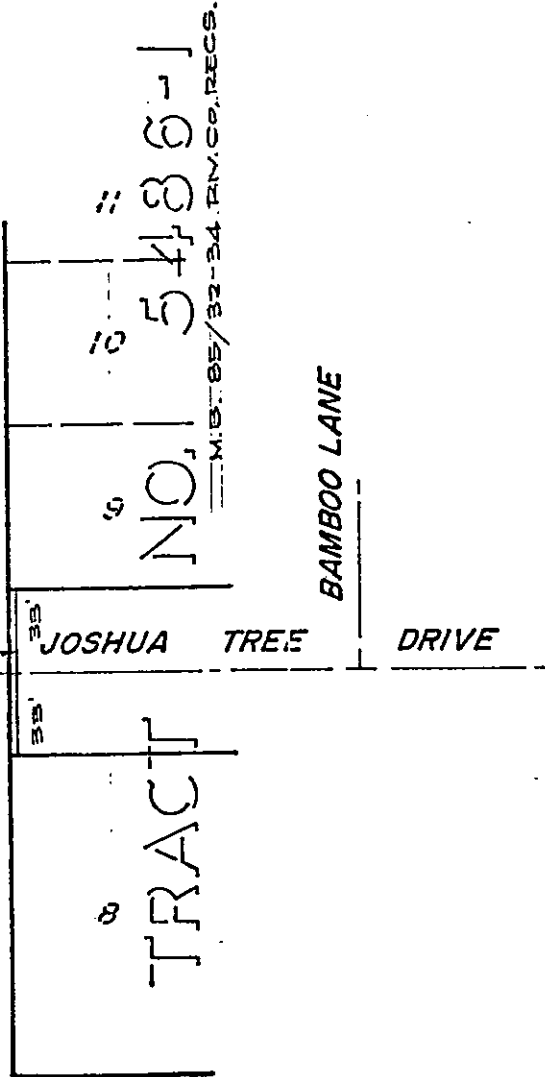

• CITY OF RIVERSIDE, CALIFORNIA •

THIS PLAT IS SOLELY AN AID IN LOCATING THE PARCEL(S) DESCRIBED IN THE ATTACHED DOCUMENT. IT IS NOT A PART OF THE WRITTEN DESCRIPTION THEREIN.

SHEET 1 OF 1

1680

SCALE: 1" = 60'

DRAWN BY V.S. DATE 5/24/76

SUBJECT TRACT NO. 5486-2

8791