

City Clerk  
3900 Main St  
Riv, Ca 92522

RECEIVED FOR RECORD  
JAN 28 1977  
10 Min. Past 3 o'clock  
At Request of  
CITY CLERK  
Book 1977, Page 16003  
Recorded in Official Records  
of Riverside County, California  
W.H. DeLoach Recorder  
FEES \$

16003

1  
2  
3  
4  
5  
6  
7  
8  
9  
10  
11  
12  
13  
14  
15  
16  
17  
18  
19  
20  
21  
22  
23  
24  
25  
26  
27  
28  
29  
30  
31  
32

RESOLUTION NO. 13000

A RESOLUTION OF THE CITY COUNCIL OF THE CITY OF RIVERSIDE, CALIFORNIA, ACCEPTING A ONE-FOOT BARRIER STRIP WITHIN TRACT NO. 3674 (WHICH BARRIER STRIP ADJOINS TRACT NO. 7264) FOR STREET PURPOSES TO BE KNOWN AS A PORTION OF MOLLY STREET.

BE IT RESOLVED by the City Council of the City of Riverside, California, that the following one-foot barrier strip is hereby accepted to public use for street purposes to be known as a portion of Molly Street:

Lot "B" (1-foot barrier strip) of Tract No. 3674 as shown by map on file in Book 66 of Maps, at Pages 24 and 25 thereof, Records of Riverside County, California.

ADOPTED by the City Council and signed by the Mayor and attested by the City Clerk this 25th day of January, 1977.

Attest:

  
Mayor of the City of Riverside

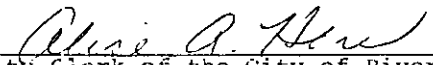
  
City Clerk of the City of Riverside

I, Alice A. Hare, City Clerk of the City of Riverside, California, hereby certify that the foregoing resolution was duly and regularly introduced and adopted by the City Council of said City at its meeting held on the 25th day of January, 1977, by the following vote, to wit:

Ayes: Councilmen Pintor, Haley, Anderson, Scott, Lorenzi, Digati and Manning.

Noes: None.

Absent: None.

IN WITNESS WHEREOF I have hereunto set my hand and affixed the official seal of the City of Riverside, California, this 25th day of January, 1977.

2-20-76  
W/s

REQUEST FOR RECORDATION

Request of City Clerk for recordation of this instrument, and return to,  
City Clerk, City Hall, 3900 Main Street  
Riverside, CA 92522

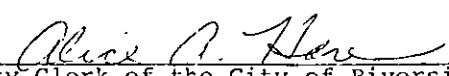
  
City Clerk of the City of Riverside

CITY ATTORNEY  
RIVERSIDE  
CALIFORNIA

16003

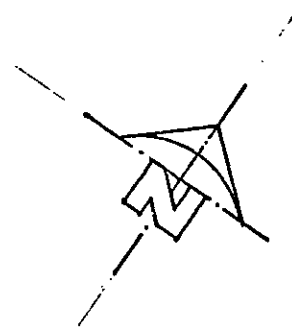

TR. NO. 3674

M.B. 22/24-25  
RIV. CO. REC.

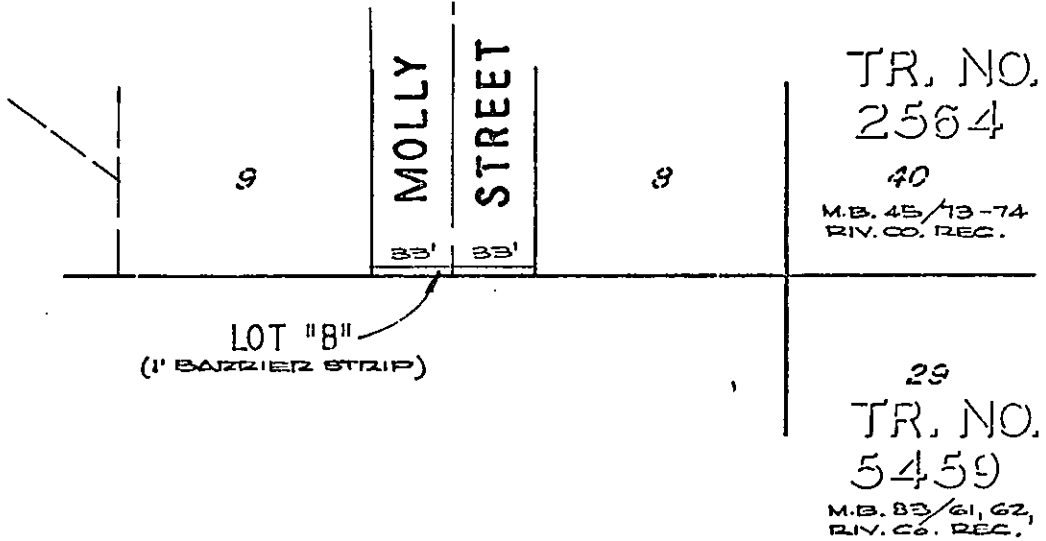

◦ CITY OF RIVERSIDE, CALIFORNIA ◦

THIS PLAT IS SOLELY AN AID IN LOCATING THE PARCEL(S) DESCRIBED IN THE ATTACHED DOCUMENT. IT IS NOT A PART OF THE WRITTEN DESCRIPTION THEREIN.

SHEET 1 OF 1

N.O. 75-302

SCALE: 1" = 60'

DRAWN BY V.S. DATE 12/3/76

SUBJECT TR. NO. 7254

8844