

When recorded mail to:

City Clerk's Office
City of Riverside
City Hall, 3900 Main Street
Riverside, California 92522

151549

FREE RECORDING

This instrument is for the benefit of the City of Riverside and is entitled to be recorded without fee. (Government Code 6103)

RECEIVED FOR RECORD

AUG 5 1977
15 Min. Post At 3 o'clock P.M.
City Clerk
Book 1977 Page 151549
Recorded in Official Records of Riverside County, California
W.H. Dwyer Recorder
FEE \$

FOR RECORDER'S OFFICE USE ONLY

Project: 3554 Bandini Avenue Building Permit 9023

GRANT DEED

F. K. SHEPARD, a married man as his sole and separate property,

Grantor

FOR A VALUABLE CONSIDERATION, receipt of which is hereby acknowledged, do hereby grant to the CITY OF RIVERSIDE, a Municipal Corporation, the real property in the City of Riverside, County of Riverside, State of California, described as follows:

That portion of Lot 12 of LINWOOD PLACE ADDITION NO. 3, as shown by map on file in Book 8 of Maps, at Page 77 thereof, records of Riverside County, California, more particularly described as follows:

The Northeasterly 3.00 feet of said Lot 12, said 3.00 feet being measured at a right angle to the southwesterly line of Bandini Avenue as shown on said map of LINWOOD PLACE ADDITION NO. 3.

Area - 150 square feet.

DESCRIPTION APPROVAL
by George R. Hutchinson 6/21/77 by W.H. Dwyer

Dated July 8 - 1977

F. K. SHEPARD

APPROVED AS TO FORM
Balala Cruz
ASST. CITY ATTORNEY

CONSENT TO RECORDATION

THIS IS TO CERTIFY that the interest in real property conveyed by this instrument to the City of Riverside, a Municipal Corporation, is hereby accepted for and on behalf of said City pursuant to Resolution of the City Council thereof recorded on 12-29-66 as Inst. No. 123460, Riverside County Records, and the Grantee hereby consents to recordation of this instrument through the undersigned.

Dated 8/5/77

Property Services Manager

151549



Riverside Ave.

Bandini Avenue

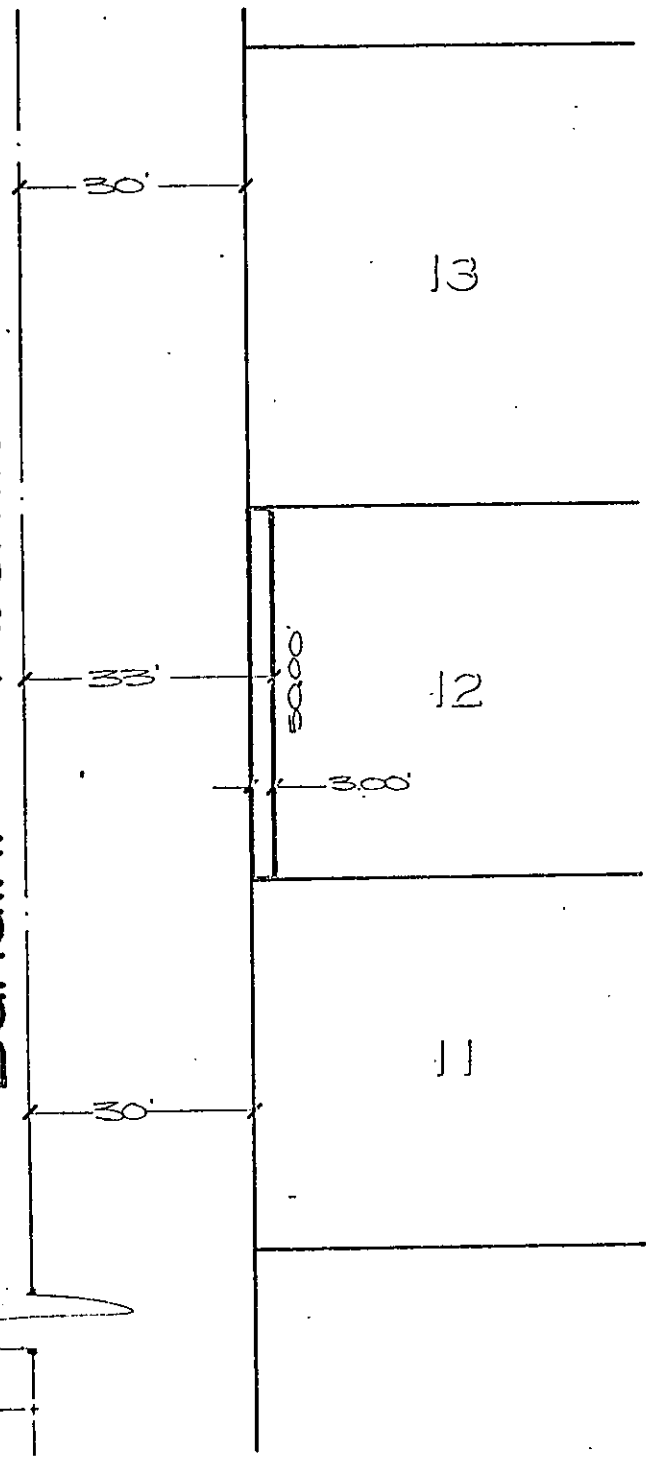

LINWOOD PLACE ADDITION No 3
H.B. S/TT R.V. CO.

CITY OF RIVERSIDE, CALIFORNIA

THIS PLAT IS SOLELY AN AID IN LOCATING THE PARCEL(S) DESCRIBED IN THE ATTACHED DOCUMENT. IT IS NOT A PART OF THE WRITTEN DESCRIPTION THEREIN.	SHEET 1 OF 1	2-22
SCALE: 1"=50'	DRAWN BY H.E. DATE 6/11/77	SUBJECT 300' BANDINI AVE. EJECT PLAT

9023