

215660

When recorded mail to:  
City Clerk's Office  
City of Riverside  
City Hall, 3900 Main Street  
Riverside, California 92522

FREE RECORDING  
This instrument is for the benefit  
of the City of Riverside and is  
entitled to be recorded without  
fee. (Government Code 6103)

RECEIVED FOR RECORD

OCT 28 1977

42 Min. Past 3 o'clock  
At Request of  
City Clerk

Book 1977 Page 215660

Recorded in Official Records  
of Riverside County, California

W.H. Dwyer Recorder

FEE \$

FOR RECORDER'S OFFICE USE ONLY

Project: 6291 Stearns Street  
Building Permit

9110

GRANT DEED

JAMES H. DIDION, a married man, and DENNIS D. McKEE, an unmarried man, as joint tenants,

Grantors,

FOR A VALUABLE CONSIDERATION, receipt of which is hereby acknowledged,  
do hereby grant to the CITY OF RIVERSIDE, a Municipal Corporation,  
the real property in the City of Riverside, County of Riverside, State of  
California, described as follows:

THE EASTERLY 5.00 FEET OF LOT 22 OF MOUNTAIN VIEW FARMS, AS SHOWN  
BY MAP ON FILE IN BOOK 14 OF MAPS, AT PAGE 24 THEREOF, RECORDS OF  
SAID RIVERSIDE COUNTY.

Area - 300 square feet.

DESCRIPTION APPROVAL  
by George Hutchinson 10/18/77 by OS

Dated Oct 20, 1977

James H. Didion  
JAMES H. DIDION

Dennis D. McKee  
DENNIS D. McKEE

APPROVED AS TO FORM

Clarice Jurney 10-21-77  
DEPUTY CITY ATTORNEY

CONSENT TO RECORDATION

THIS IS TO CERTIFY that the interest in real property conveyed by this  
instrument to the City of Riverside, a Municipal Corporation, is hereby  
accepted for and on behalf of said City pursuant to Resolution of the  
City Council thereof recorded on 12-29-66 as Inst. No. 123460, Riverside  
County Records, and the Grantee hereby consents to recordation of this  
instrument through the undersigned.

10/28/77

Ann Rice  
Property Services Manager

215660

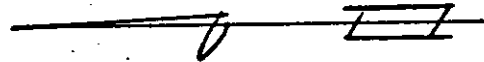

STEARNS ST.

TO JURUPA AVE.

50°07'E

IR DEWEY AVE.

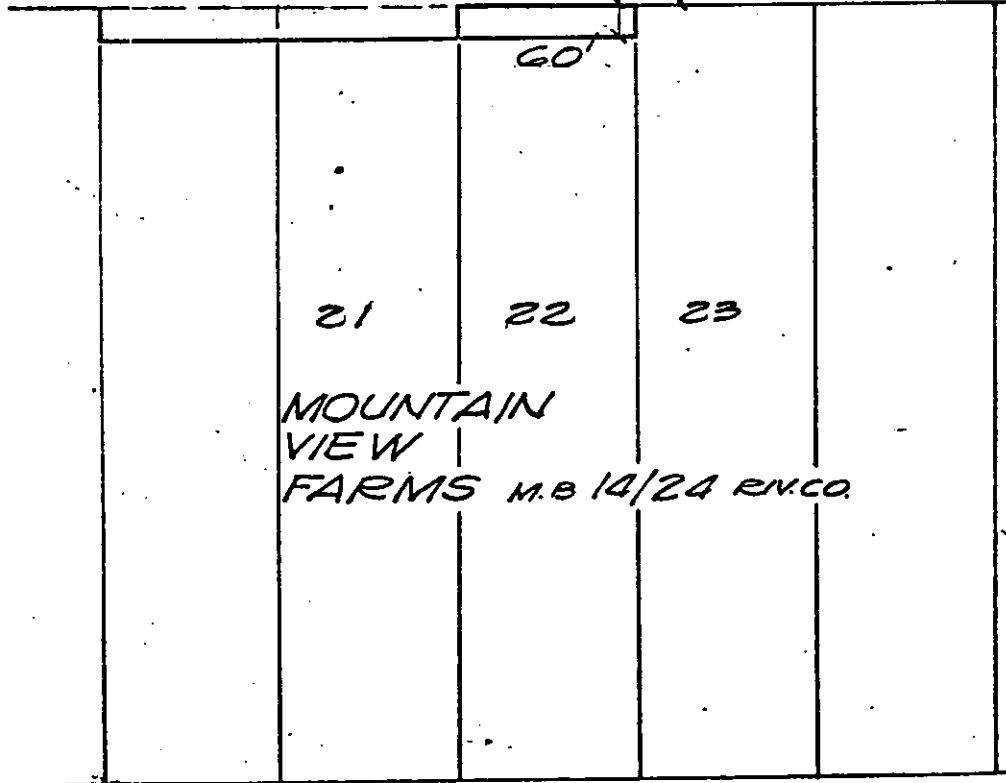

• CITY OF RIVERSIDE, CALIFORNIA •

THIS PLAN IS SOLELY AN AID IN LOCATING THE PARCEL(S) DESCRIBED IN THE ATTACHED DOCUMENT. IT IS NOT A PART OF THE WRITTEN DESCRIPTION THEREIN.

SHEET 1 OF 1

4/12

SCALE: 1" = 50'

DRAWN BY G.S. DATE 4/11/71

SUBJECT BLDG. PERMIT - 6291 STEARNS

9110