

204505

REQUEST FOR RECORDATION

Request of City Clerk for recordation of this instrument, and return to:  
1 City Clerk, City Hall, 3300 Main Street  
Riverside, CA 92522

ORDINANCE NO. 4606

RECEIVED FOR RECORD

SEP 27 1978

AT 11:00 O'CLOCK A.M.

At Request of

CITY CLERK

Book 1978, Page 201505

Recorded in Official Records  
of Riverside County, California

*D. D. S. Recorder*

FEES \$

9448

VAC-22-778

2 AN ORDINANCE OF THE CITY COUNCIL OF THE CITY OF  
3 RIVERSIDE, CALIFORNIA, MAKING ITS FINDINGS AND  
4 DETERMINATIONS IN THE MATTER OF RESOLUTION OF  
5 INTENTION NO. 13468; RESERVING PERMANENT EASEMENTS  
6 AND RIGHTS OF WAY FOR ELECTRICAL DISTRIBUTION AND  
7 TELEPHONE, TELEGRAPH, AND COMMUNICATIONS FACILITIES  
8 AND DETERMINING THAT THE PUBLIC CONVENIENCE AND  
9 NECESSITY REQUIRE RESERVATION OF SUCH EASEMENTS;  
10 REPEALING ORDINANCE NO. 4581; MAKING ITS ORDER  
11 VACATING A WALKWAY BETWEEN SIERRA MIDDLE SCHOOL  
12 EASTERLY TO CATALINA DRIVE, NORTHERLY OF SIERRA WAY;  
13 AND DECLARING THIS ORDINANCE TO BE AN EMERGENCY  
14 ORDINANCE.

15 WHEREAS on June 27, 1978, the City Council of the City  
16 of Riverside adopted Resolution No. 13468 declaring its intention  
17 to order the vacation of a walkway between Sierra Middle School  
18 easterly to Catalina Drive, northerly of Sierra Way, and  
19 fixing the time and place of hearing all persons interested  
20 in the proposed vacation, pursuant to the provisions of the  
21 Street Vacation Act of 1941, being Sections 8300 et seq. of  
22 Part 3, Division 9 of the Streets and Highways Code of the  
23 State of California; and

24 WHEREAS said proposed vacation was submitted to and  
25 acted upon by the Planning Commission of the City of Riverside  
26 and notice of hearing said resolution was given as provided by  
27 the Street Vacation Act of 1941; and

28 WHEREAS on the day fixed for the hearing the City Council  
29 heard and considered the evidence offered by persons interested  
30 and found and hereby finds from all of the evidence submitted  
31 that the walkway ordered vacated is unnecessary for present or  
32 prospective public use; and

WHEREAS on August 22, 1978, the City Council adopted  
Ordinance No. 4581 vacating the walkway in question; and

WHEREAS said ordinance reserved permanent easements and  
rights of way for electrical distribution facilities, but due  
to a late request from the Pacific Telephone Company did not  
reserve an easement for existing telephone lines crossing the

9-14-78  
JW/h

CITY ATTORNEY  
RIVERSIDE  
CALIFORNIA

9448

204505

1 walkway; and

2 WHEREAS in order to correct this situation, it is  
3 necessary to repeal Ordinance No. 4581 prior to its effective  
4 date of September 21, 1978 and to adopt an emergency ordinance  
5 which will become effective prior to said date;

6 NOW, THEREFORE, BE IT ORDAINED by the City Council of  
7 the City of Riverside, California, that the walkway between  
8 Sierra Middle School easterly to Catalina Drive, northerly of  
9 Sierra Way, in the City of Riverside, County of Riverside,  
10 State of California, described in the document attached hereto,  
11 marked Exhibit "A", and by this reference made a part hereof,  
12 be and the same is hereby vacated.

13 BE IT FURTHER ORDAINED that the City Council does hereby  
14 determine that the public convenience and necessity require the  
15 reservation of permanent easements and rights of way for  
16 electrical distribution facilities and reserving the right to  
17 construct, maintain, operate, replace, remove, renew and enlarge  
18 lines of pipe, conduits, cables, wires, poles and other convenient  
19 structures, equipment and fixtures for the transportation or  
20 distribution of electric energy; and permanent easements and  
21 rights of way to construct, place, operate, inspect, maintain,  
22 repair, replace and remove such aerial and underground telephone,  
23 telegraph and communication structures as the Pacific Telephone  
24 and Telegraph Company may from time to time require consisting  
25 of poles, anchors, wires, cables, conduits, manholes, markers  
26 and necessary fixtures and appurtenances; including access and  
27 the right to keep the property free from inflammable materials  
28 and wood growth that would interfere with the use of said permanent  
29 easements and rights of way.

30 BE IT FURTHER ORDAINED that Ordinance No. 4581 is hereby  
31 repealed.

32 BE IT FURTHER ORDAINED that this ordinance is an emergency

204505

1 ordinance necessary for the preservation of the public peace,  
2 health or safety within the meaning of Section 412 of the Charter  
3 of the City of Riverside and shall go into effect immediately  
4 upon its adoption and become operative on September 21, 1978,  
5 the same date that Ordinance No. 4581 would have become effective.  
6 The facts constituting such necessity are that if said Ordinance  
7 No. 4581 should become effective without the reservation of  
8 permanent easement and rights of way for telephone, telegraph  
9 and communication facilities, then existing telephone lines  
10 crossing the walkway would be jeopardized.

11 IT IS FURTHER ORDAINED that the City Clerk of said  
12 City of Riverside shall cause a certified copy of this order  
13 attested by the City Clerk under the seal of said City to be  
14 recorded in the office of the County Recorder of Riverside County,  
15 California.

16 IT IS FURTHER ORDAINED that the City Clerk shall certify  
17 to the adoption of this ordinance and cause it to be published  
18 once in The Press.

19 ADOPTED by the City Council and signed by the Mayor and  
20 attested by the City Clerk this 19th day of September, 1978.

21  
22  
23  
24 *Ch Brown*  
Mayor of the City of Riverside

25  
26 Attest:

27  
28  
29 *Alicia P. New*  
30 City Clerk of the City of Riverside

9448

204505

1  
2  
3  
4  
5  
6  
7  
8  
9  
10  
11  
12  
13  
14  
15  
16  
17  
18  
19  
20  
21  
22  
23  
24  
25  
26  
27  
28  
29  
30  
31  
32

I, Alice A. Hare, City Clerk of the City of Riverside, California, hereby certify that the foregoing ordinance was duly and regularly introduced at a meeting of the City Council on the 19th day of September, 1978, and was duly adopted on the said date and at the same meeting by the following vote, to wit:

Ayes: Councilmen Pintor, Shepard, Anderson, Bowers, Lorenzi, Digati and Manning.

Noes: None.

Absent: None.

IN WITNESS WHEREOF I have hereunto set my hand and affixed the official seal of the City of Riverside, California, this 19th day of September, 1978.

Alice A. Hare  
City Clerk of the City of Riverside

9948

VACATION VAC-22-778  
Walkway between Sierra Middle School  
to Catalina Drive

PARCEL 1

Lot D of Central Park Tract as shown by map on file in Book 25 of Maps, at Page 50 thereof, records of Riverside County, California;

RESERVING therefrom permanent easements and rights-of-way for aerial and underground telephone, telegraph, communication and electric energy distribution facilities over the west 10.00 feet of said Lot.

PARCEL 2

Lot E of Central Park Tract as shown by map on file in Book 25 of Maps, at Page 50 thereof, records of Riverside County, California;

RESERVING therefrom permanent easements and rights-of-way for aerial and underground telephone, telegraph, communication and electric energy distribution facilities over the east 10.00 feet of said Lot.

PARCEL 3

Lot C of Eugene Terrace as shown by map on file in Book 28 of Maps, at Page 72 thereof, records of Riverside County, California;

RESERVING therefrom permanent easements and rights-of-way for aerial and underground telephone, telegraph, communication and electric energy distribution facilities over the west 10.00 feet of said Lot.

PARCEL 4

Lot D of Eugene Terrace as shown by map on file in Book 28 of Maps, at Page 72 thereof, records of Riverside County, California;

RESERVING therefrom permanent easements and rights-of-way for aerial and underground telephone, telegraph, communication and electric energy distribution facilities over the east 10.00 feet of said Lot.

PARCEL 5

Lot C of Central Park Tract No. 2 as shown by map on file in Book 27 of Maps, at Page 49 thereof, records of Riverside County, California;

RESERVING therefrom permanent easements and rights-of-way for aerial and underground telephone, telegraph, communication and electric energy distribution facilities over the west 5.00 feet of said Lot.

PARCEL 6

Lot D of Central Park Tract No. 2 as shown by map on file in Book 27 of Maps, at Page 49 thereof, records of Riverside County, California;

RESERVING therefrom permanent easements and rights-of-way for aerial and underground telephone, telegraph, communication and electric energy distribution facilities over the east 10.00 feet of said Lot.

EXHIBIT "A"

9448

204505

PARCEL 7

Lot D of Flory Tract as shown by map on file in Book 30 of Maps, at Page 87 thereof, records of Riverside County, California;

RESERVING therefrom permanent easements and rights-of-way for aerial and underground telephone, telegraph, communication and electric energy distribution facilities over the west 5.00 feet of said Lot.

PARCEL 8

Lot E of Flory Tract as shown by map on file in Book 30 of Maps, at Page 87 thereof, records of Riverside County, California;

RESERVING therefrom permanent easements and rights-of-way for aerial and underground telephone, telegraph, communication and electric energy distribution facilities over the west 10.00 feet of the east 115 feet of said Lot.

PARCEL 9

Lot C of Flory Tract No. 2 as shown by map on file in Book 32 of Maps, at Page 85 thereof, records of Riverside County, California;

RESERVING therefrom permanent easements and rights-of-way for aerial and underground telephone, telegraph, communication and electric energy distribution facilities over the west 5.00 feet of said Lot.

y3/4

DESCRIPTION APPROVAL  
By \_\_\_\_\_  
Surveyor

204505

CENTRAL PARK TRACT

M.B. 25/50 RIV. CO.

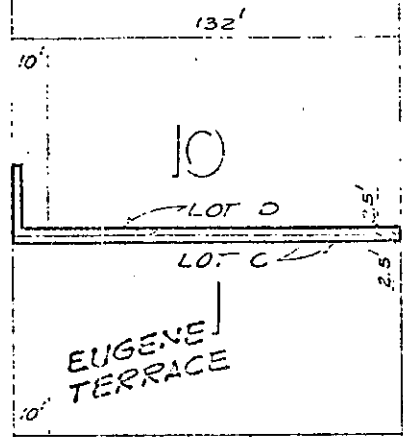

NICOLETT ST.  
NO 06 07 1/4  
33' 33'  
BELINDA DR.  
33' 33'  
CATALINA DR.  
33' 33'

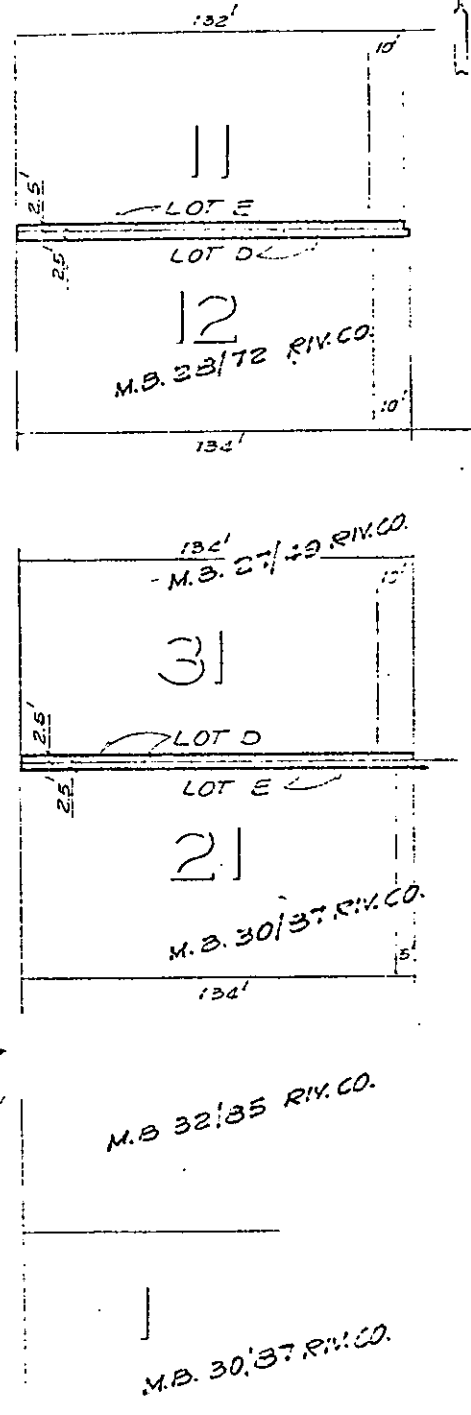

CITY OF RIVERSIDE, CALIFORNIA

THIS PLAT IS SOLELY AN AID IN LOCATING THE PARCEL(S) DESCRIBED IN THE ATTACHED DOCUMENT. IT IS NOT A PART OF THE WRITTEN DESCRIPTION THEREIN.

SHEET 1 OF 1

SCALE: 1" = 40'

DRAWN BY GS DATE 6/8/78

SUBJECT VAC-22-778

9448