

REQUEST FOR RECORDATION

Request of City Clerk for recordation of this instrument, and return to:

1 City Clerk, City Hall, 3900 Main Street
Riverside, CA 92522

2 AN ORDINANCE OF THE CITY COUNCIL OF THE CITY OF
3 RIVERSIDE, CALIFORNIA, MAKING ITS FINDINGS AND
4 DETERMINATIONS IN THE MATTER OF RESOLUTION OF
5 INTENTION NO. 13626, AND MAKING ITS ORDER VACATING
6 AN UNIMPROVED ALLEY BEHIND 3282 MARY STREET,
7 SITUATED ON THE SOUTHERLY CORNER OF THE INTER-
8 SECTION OF MARY STREET AND THE ATCHISON, TOPEKA &
9 SANTA FE RAILROAD RIGHT OF WAY.

160837

VAC-10-789

160837

7 WHEREAS on March 6, 1979, the City Council of the City
8 of Riverside adopted Resolution No. 13626 declaring its intention
9 to order the vacation of an unimproved alley approximately 80
10 feet long and 10 feet wide and located behind 3282 Mary Street,
11 which alley is situated on the southerly corner of the inter-
12 section of Mary Street and the Atchison, Topeka & Santa Fe
13 Railroad right of way, and fixing the time and place of hearing
14 all persons interested in the proposed vacation, pursuant to the
15 provisions of the Street Vacation Act of 1941, being Sections
16 8300 et seq. of Part 3, Division 9 of the Streets and Highways
17 Code of the State of California; and

18 WHEREAS said proposed vacation was submitted to and
19 acted upon by the Planning Commission of the City of Riverside
20 and notice of hearing said resolution was given as provided by
21 said Street Vacation Act of 1941; and

22 WHEREAS on the day fixed for the hearing the City Council
23 heard and considered the evidence offered by persons interested
24 and found and hereby finds from all of the evidence submitted
25 that the alley ordered vacated is unnecessary for present or
26 prospective public use;

27 NOW, THEREFORE, BE IT ORDAINED by the City Council of
28 the City of Riverside, California, that the alley in the City
29 of Riverside, County of Riverside, State of California, described
30 as follows:

31 The Southwest 10.00 feet of Lot 18 in Block 7 of
32 Orange Acres No. 2, as shown by map on file in Book 14
of Maps, at page 2 thereof, records of Riverside County,
California;

3-30-79
JW/h

RECEIVED FOR RECORD
AT 11:00 O'CLOCK A.M.
As Request of

City Clerk
Book 1979, Page 160837

JUL 3 11979

Recorded in Official Records
of Riverside County, California

David S. [Signature]
Recorder

160937

1 be and the same is hereby vacated.

2 IT IS FURTHER ORDAINED that the City Clerk of said City
3 of Riverside shall cause a certified copy of this order attested
4 by the City Clerk under the seal of said City to be recorded in
5 the office of the County Recorder of Riverside County, California.

6 IT IS FURTHER ORDAINED that the City Clerk shall certify
7 to the adoption of this ordinance and cause it to be published
8 once in The Press . This ordinance shall become
9 effective on the 30th day after the date of its adoption.

10 ADOPTED by the City Council and signed by the Mayor and
11 attested by the City Clerk this 24th day of July, 1979.

12

13

14



Mayor of the City of Riverside

15

16

17

18 Attest:

19

20

21



City Clerk of the City of Riverside

22

23

24

25

26

27

28

29

30

31

32

160837

1
2
3
4
5
6
7
8
9
10
11
12
13
14
15
16
17
18
19
20
21
22
23
24
25
26
27
28
29
30
31
32

I, Alice A. Hare, City Clerk of the City of Riverside, California, hereby certify that the foregoing ordinance was duly and regularly introduced at a meeting of the City Council on the 3rd day of April, 1979, and that thereafter the said ordinance was duly and regularly adopted at a meeting of the City Council on the 24th day of July, 1979, by the following vote, to wit:

Ayes: Councilmen Pintor, Shepard, Anderson, Bowers, Lorenzi, Digati and Manning.

Noes: None.

Absent: None.

IN WITNESS WHEREOF I have hereunto set my hand and affixed the official seal of the City of Riverside, California, this 24th day of July, 1979.

Alice A. Hare
City Clerk of the City of Riverside

9636

160837

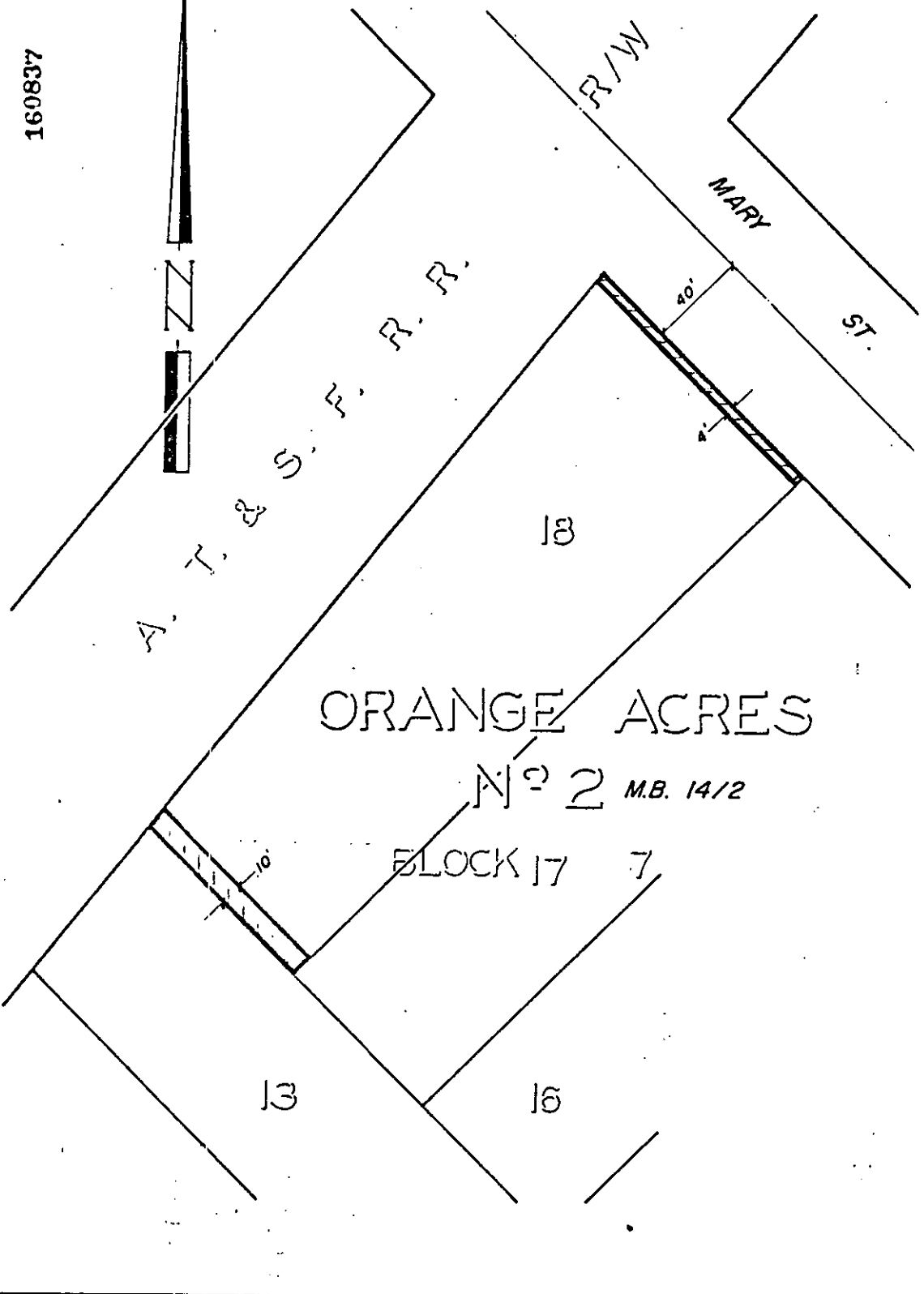

ORANGE ACRES

No 2 M.B. 14/2

BLOCK 17 7

• CITY OF RIVERSIDE, CALIFORNIA •

THIS PLAT IS SOLELY AN AID IN LOCATING THE PARCEL(S) DESCRIBED IN THE ATTACHED DOCUMENT. IT IS NOT A PART OF THE WRITTEN DESCRIPTION THEREIN.

SHEET 1 OF 1

SCALE: 1" = 50'

DRAWN BY GS DATE 2/9/79

SUBJECT VAC-10-789

9636