

132674

**REQUEST FOR RECORDATION**

Request of City Clerk for recordation of this Instrument, and return to, City Clerk, City Hall, 3900 Main Street Riverside, CA 92522

ORDINANCE NO. 4808

RECEIVED FOR RECORD  
AT 11:00 O'CLOCK A.M.  
An Ordinance of  
City of Riverside

Book 1980, Page 132674

JUL 23 1980

Recorded in Official Records  
of Riverside County, California

*David S. ...*  
REC'D

1 AN ORDINANCE OF THE CITY COUNCIL OF THE CITY OF  
2 RIVERSIDE, CALIFORNIA, MAKING ITS FINDINGS AND  
3 DETERMINATIONS IN THE MATTER OF RESOLUTION OF  
4 INTENTION NO. 13392; RESERVING PERMANENT EASEMENTS  
5 AND RIGHTS OF WAY FOR TELEPHONE, GAS, SANITARY  
6 SEWER, STORM DRAIN AND AERIAL ELECTRIC DISTRIBUTION  
7 FACILITIES AND DETERMINING THAT THE PUBLIC CONVENIENCE  
8 AND NECESSITY REQUIRE THE RESERVATION OF SUCH  
9 EASEMENTS AND RIGHTS OF WAY; AND MAKING ITS ORDER  
10 VACATING A PORTION OF ARROYO DRIVE RIGHT-OF-WAY  
11 LOCATED AT THE SOUTHEASTERLY TERMINUS OF ARROYO  
12 DRIVE NORTHERLY OF BRONSON WAY.

VAC-14-778

9 WHEREAS on February 28, 1978, the City Council of the  
10 City of Riverside adopted Resolution No. 13392 declaring its  
11 intention to order the vacation of a portion of Arroyo Drive  
12 right-of-way located at the southeasterly terminus of Arroyo  
13 Drive northerly of Bronson Way, and fixing the time and place  
14 of hearing all persons interested in the proposed vacation,  
15 pursuant to the provisions of the Street Vacation Act of 1941,  
16 being Sections 8300 et seq. of Part 3, Division 9 of the Streets  
17 and Highways Code of the State of California; and

18 WHEREAS said proposed vacation was submitted to and  
19 acted upon by the Planning Commission of the City of Riverside  
20 and notice of hearing said resolution was given as provided by  
21 said Street Vacation Act of 1941; and

22 WHEREAS on the day fixed for the hearing the City  
23 Council heard and considered the evidence offered by persons  
24 interested and found and hereby finds from all of the evidence  
25 submitted that the portion of Arroyo Drive right-of-way ordered  
26 vacated is unnecessary for present or prospective public use;

27 NOW, THEREFORE, BE IT ORDAINED by the City Council of  
28 the City of Riverside, California, that the portion of Arroyo  
29 Drive right-of-way in the City of Riverside, County of Riverside,  
30 State of California, described as follows:

31 All that portion of Arroyo Drive (formerly  
32 Norton Avenue) as shown by the map of VICTORIA PARK  
ADDITION, on file in Book 7, Page 18 of Maps, records

CITY ATTORNEY  
RIVERSIDE  
CALIFORNIA

9898

132674

1  
2  
3  
4  
5  
6  
7  
8  
9  
10  
11  
12  
13  
14  
15  
16  
17  
18  
19  
20  
21  
22  
23  
24  
25  
26  
27  
28  
29  
30  
31  
32

of Riverside County, California, described as follows:  
Commencing at the northeast corner of Lot 139 of  
said VICTORIA PARK ADDITION; said corner being in the  
west line of said Arroyo Drive;

THENCE South 4° 24' 00" West, along said west  
line 49.96 feet to the true point of beginning;

THENCE continuing South 4° 24' 00" West, along  
said west line 55.41 feet to the south boundary of  
said VICTORIA PARK ADDITION;

THENCE North 88° 51' 00" East, along said south  
boundary 50.24 feet to the east line of said Arroyo  
Drive;

THENCE North 4° 24' 00" East, along said east  
line 64.40 feet to the beginning of a non-tangent  
curve, concaving northerly and having a radius of  
32.00 feet; the initial radial line at said beginning  
of said curve bears South 65° 13' 56" East;

THENCE Southwesterly, westerly and northwesterly,  
along said curve, an arc length of 60.49 feet, thru  
a central angle of 108° 18' 50" to said true point of  
beginning.

RESERVING therefrom an easement for telephone,  
telegraph and communication distribution facilities  
over the east 5.00 feet, as measured at right angle  
5.00 feet westerly from said east line of Arroyo  
Drive, and the southerly 5.00 feet, as measured at  
right angle 5.00 feet northerly from said south  
boundary;

ALSO RESERVING therefrom an easement for a gas  
line facilities over the west 10.00 feet of the east  
18.00 feet; said east 18.00 feet being measured at  
right angle 18.00 feet westerly from said east line of  
Arroyo Drive;

ALSO RESERVING therefrom an easement for an  
aerial electric distribution facilities over the south  
5.00 feet, as measured at right angle 5.00 feet north-  
erly from said south boundary;

ALSO RESERVING therefrom an easement for a sanitary  
sewer facilities over the west half of said Arroyo  
Drive;

ALSO RESERVING therefrom an easement, 10.00 feet  
in width, for a storm drain facilities; the centerline  
of said easement more particularly described as follows:

Beginning at a point in said east line of Arroyo  
Drive North 4° 24' 00" East 35.04 feet from the  
southwest corner of Lot 142 of said VICTORIA PARK  
ADDITION;

THENCE North 38° 15' 39" West 18.56 feet to a  
point in said non-tangent curve from which the radial  
line of said curve bears South 28° 35' 10" East;  
said point being the end of this centerline description;

be and the same is hereby vacated.

BE IT FURTHER ORDAINED that the City Council does hereby  
determine that the public convenience and necessity require  
the reservation of permanent easements and rights of way for  
gas, sanitary sewer, storm drain and aerial electric distribution  
facilities, and reserving the right to construct, maintain,

3898

132674

1 operate, replace, remove, renew and enlarge lines of pipe,  
2 conduits, cables, wires, poles and other convenient structures,  
3 equipment and fixtures for the operation of gas pipe lines,  
4 sanitary sewers and storm drains and for the transportation or  
5 distribution of electric energy; and a permanent easement and  
6 right of way to construct, place, operate, inspect, maintain,  
7 repair, replace and remove such aerial and underground telephone,  
8 telegraph and communication structures as the Pacific Telephone  
9 and Telegraph Company may from time to time require consisting  
10 of poles, anchors, wires, cables, conduits, manholes, markers  
11 and necessary fixtures and appurtenances; including access and  
12 the right to keep the property free from inflammable materials  
13 and wood growth that would interfere with the use of said  
14 permanent easements and rights of way.

15 IT IS FURTHER ORDAINED that the City Clerk of said City  
16 of Riverside shall cause a certified copy of this order attested  
17 by the City Clerk under the seal of said City to be recorded in  
18 the office of the County Recorder of Riverside County, California.

19 IT IS FURTHER ORDAINED that the City Clerk shall certify  
20 to the adoption of this ordinance and cause it to be published  
21 once in The Press . . . This ordinance shall become  
22 effective on the 30th day after the date of its adoption.

23 ADOPTED by the City Council and signed by the Mayor and  
24 attested by the City Clerk this 15th day of July, 1980.

25  
26   
27 Mayor of the City of Riverside

28 Attest:

29  
30   
31 City Clerk of the City of Riverside  
32

132674

1 I, Alice A. Hare, City Clerk of the City of Riverside,  
2 California, hereby certify that the foregoing ordinance was  
3 duly and regularly introduced at a meeting of the City Council  
4 on the 28th day of March, 1978, and that thereafter the  
5 said ordinance was duly and regularly adopted at a meeting  
6 of the City Council on the 15th day of July, 1980, by  
7 the following vote, to wit:

8 Ayes: Councilmen Loveridge, Shepard, Mansfield, Bowers,  
9 Buster, Digati and Frizzel.

10 Noes: None.

11 Absent: None.

12 IN WITNESS WHEREOF I have hereunto set my hand and  
13 affixed the official seal of the City of Riverside, California,  
14 this 15th day of July, 1980.

15  
16  
17  
18  
19  
20  
21  
22  
23  
24  
25  
26  
27  
28  
29  
30  
31  
32

Alice A. Hare  
City Clerk of the City of Riverside

3/14/78  
JW/jm

132674

Arroyo Drive  
(Formerly Norton Ave.)  
Fd. concrete point  
Per F.B. 564/43

141

140

Victoria Park Addition  
M.B. T/10 R.V.C.O.

139

R=28.00'  
A=134.44°  
L=6.69'

R=32.00'  
A=88.11°  
L=49.25'

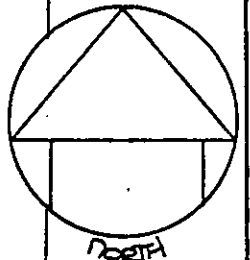

142

Portion to be vacated

138

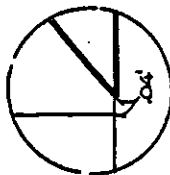

Detail  
No. 504

REV. 6-16-76

• CITY OF RIVERSIDE, CALIFORNIA •

THIS PLAT IS SOLELY AN AID IN LOCATING THE PARCEL(S) DESCRIBED IN THE ATTACHED DOCUMENT. IT IS NOT A PART OF THE WRITTEN DESCRIPTION THEREIN.

SHEET 1 OF 1

4/3T

SCALE: 1" = 20'

DRAWN BY J.V. DATE 2/19/76

SUBJECT: ARROYO DR.-ST. VACATION

9898