

176891

When recorded mail to:
City Clerk's Office
City of Riverside
City Hall, 3900 Main Street
Riverside, California 92522

RECEIVED FOR RECORD
\$5 Min. Past 5 o'clock
At Request of
City Clerk

Book 1980, Page 176891
SEP 26 1980

Recorded in Official Records
of Riverside County, California
D. D. S. Recorder
FEES \$ 8

FREE RECORDING
This instrument is for the benefit
of the City of Riverside and is
entitled to be recorded without
fee. (Government Code 6103)

FOR RECORDER'S OFFICE USE ONLY

Project: 1862 10th Street
Building Permit

GRANT DEED

MICHAEL MONTROSS and DEBRA MONTROSS, husband and wife as joint tenants,
Grantors,

FOR A VALUABLE CONSIDERATION, receipt of which is hereby acknowledged,
do hereby grant to the CITY OF RIVERSIDE, a Municipal Corporation,
the real property in the City of Riverside, County of Riverside, State of
California, described as follows:

THE NORTHERLY 3.00 FEET OF LOT 5 IN BLOCK B OF FRANKLIN
SQUARE, AS SHOWN BY MAP ON FILE IN BOOK 6 OF MAPS AT
PAGE 31 THEREOF RECORDS OF SAN BERNARDINO COUNTY,
CALIFORNIA.

AREA - 150 square feet.

EXEMPTION APPROVAL
by George M. Thompson, 8/29/80, by *alt*
SURVEYOR

APPROVED AS TO FORM

Ray Wilson
SENIOR DEPUTY CITY ATTORNEY

Dated Sept. 23, 1980

Michael Montross
MICHAEL MONTROSS
Debra Montross
DEBRA MONTROSS

STATE OF CALIFORNIA

CONSENT TO RECORDATION

THIS IS TO CERTIFY that the interest in real property conveyed by the Deed or
Grant dated 9/23/80 from Michael Montross and Debra
Montross
for 3 ft Lot 5 Blk B Franklin Square Blk 6 of Maps Pg
31 Dec of SB/C
to the City of Riverside, a Municipal Corporation, is hereby accepted for and on
behalf of said City pursuant to Resolution of the City Council thereof recorded on
12-29-66 by Inst. No. 123460, Riverside County Records, and the Grantee hereby
consents to recordation of this instrument through the undersigned.

Dated 9/26/80
Pat Rice
Property Services Manager

176891

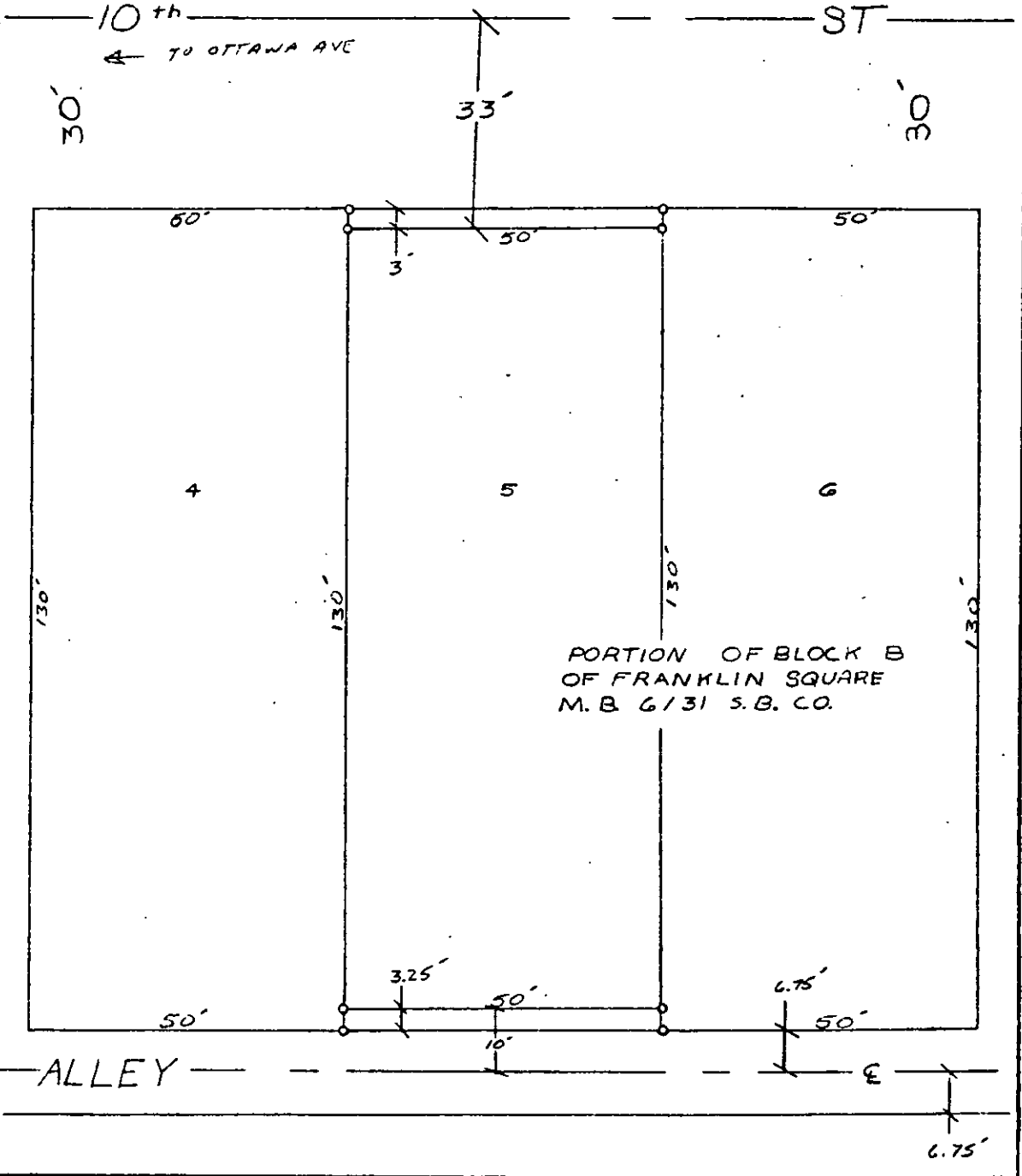
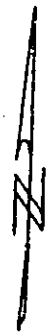

• CITY OF RIVERSIDE, CALIFORNIA •

THIS PLAT IS SOLELY AN AID IN LOCATING THE PARCEL(S) DESCRIBED IN THE ATTACHED DOCUMENT IT IS NOT A PART OF THE WRITTEN DESCRIPTION THEREIN.

SHEET 1 OF 1

CB 3/62

SCALE: 1" = 20'

DRAWN BY DRF DATE 5/19/80

SUBJECT 1242 10th ST BUILDING PERMIT

9927