

ENCROACHMENT PERMIT

Pursuant to Resolution No. 11065 of the City of Riverside, permission is hereby granted to THE COUNTY OF RIVERSIDE
4080 Lemon Street
Riverside, CA 92501

its heirs and assigns, hereinafter referred to as "Permittee" to use and occupy the following described property.

That portion of the public street right of way of Eleventh Street 66' in width, located between Main Street and Orange Street as shown by the attached Exhibit "A",

in accordance with the terms hereof.

1. Permittee shall use and occupy the described property only in the manner and for the purposes as follows: Construction and maintenance of an underground tunnel encroaching into said public right of way as shown by the attached Exhibit "A".

1a. The existing electric underground facilities in Eleventh Street shall be protected in place to the satisfaction of the Riverside Public Utilities Department. The Contractor shall notify Utilities at Phone No. 782-5381, 48 hours prior to construction.

2. Permittee, by acceptance of the benefits hereunder, acknowledges title to the property to be in the City of Riverside and waives any right to contest the validity of the dedication or grant.

3. Permittee acknowledges that the described property is the site of a proposed or planned public improvement and that, accordingly, all rights and privileges of use permitted shall cease and expire upon notice of revocation by the City. Upon the expiration or revocation, Permittee shall, within the time prescribed by the City, remove all improvements or obstructions placed, constructed or maintained by the Permittee. If the Permittee fails to abide by the removal order of the City within the time prescribed, the City shall have the right to remove and destroy the improvements without reimbursement to the Permittee and the cost of such removal shall be paid by the Permittee to the City of Riverside and shall constitute a debt owed to the City of Riverside.

4. Permittee, by acceptance hereof, waives the right of claim, loss, damage or action against the City of Riverside arising out of or resulting from revocation, termination, removal of the improvements or any action of the City of Riverside, its officers, agents or employees taken in accordance with the terms hereof.

5. Finding and determination by the City Council of the City of Riverside that the Permittee, or his heirs and assigns or successors in interest, are in default of the terms hereunder shall be cause for revocation.

6. Permittee herewith agrees to hold the City of Riverside harmless from and against all claims, demands, costs, losses, damages, injuries, action for damages and/or injuries, and liability growing or arising out of or in connection with the construction, encroachment, and/or maintenance to be done by Permittee or his agents, employees or contractors within the described property.

DATED: June 22, 1988

CITY OF RIVERSIDE, a municipal corporation

By [Signature] Mayor

Attest [Signature] City Clerk

The foregoing is accepted by:

[Signature]
(Signature(s) of Permittee)
WALT ABRAHAM, Chairman of the Board of
Supervisors

APPROVED AS TO CONTENT
[Signature]
Department Head (Public Works)

APPROVED AS TO FORM
[Signature]
City Attorney

CITY MANAGER APPROVAL
[Signature]
City Manager

FORM APPROVED
COUNTY COUNSEL

MAY 17 1988

BY [Signature]

[Signature]
Department Head (Public Utilities)

NOT TO SCALE

ORIGINAL COURTHOUSE

COURTHOUSE

ELEV

NOTE: TUNNEL TO BE CENTERED BETWEEN FTGS. OF ADJACENT BUILDINGS

JAIL/PROBATION BUILDING

MAIN STREET

ORANGE STREET

ELEVENTH STREET

PERMIT AREA

PROPOSED TUNNEL

MANHOLE - SEE P. 2

EXTENT OF TUNNEL THIS CONTRACT

EXHIBIT 'A'
SHEET 1 OF 2
E-1073

SCALE 1" = 20'

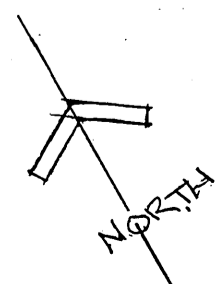
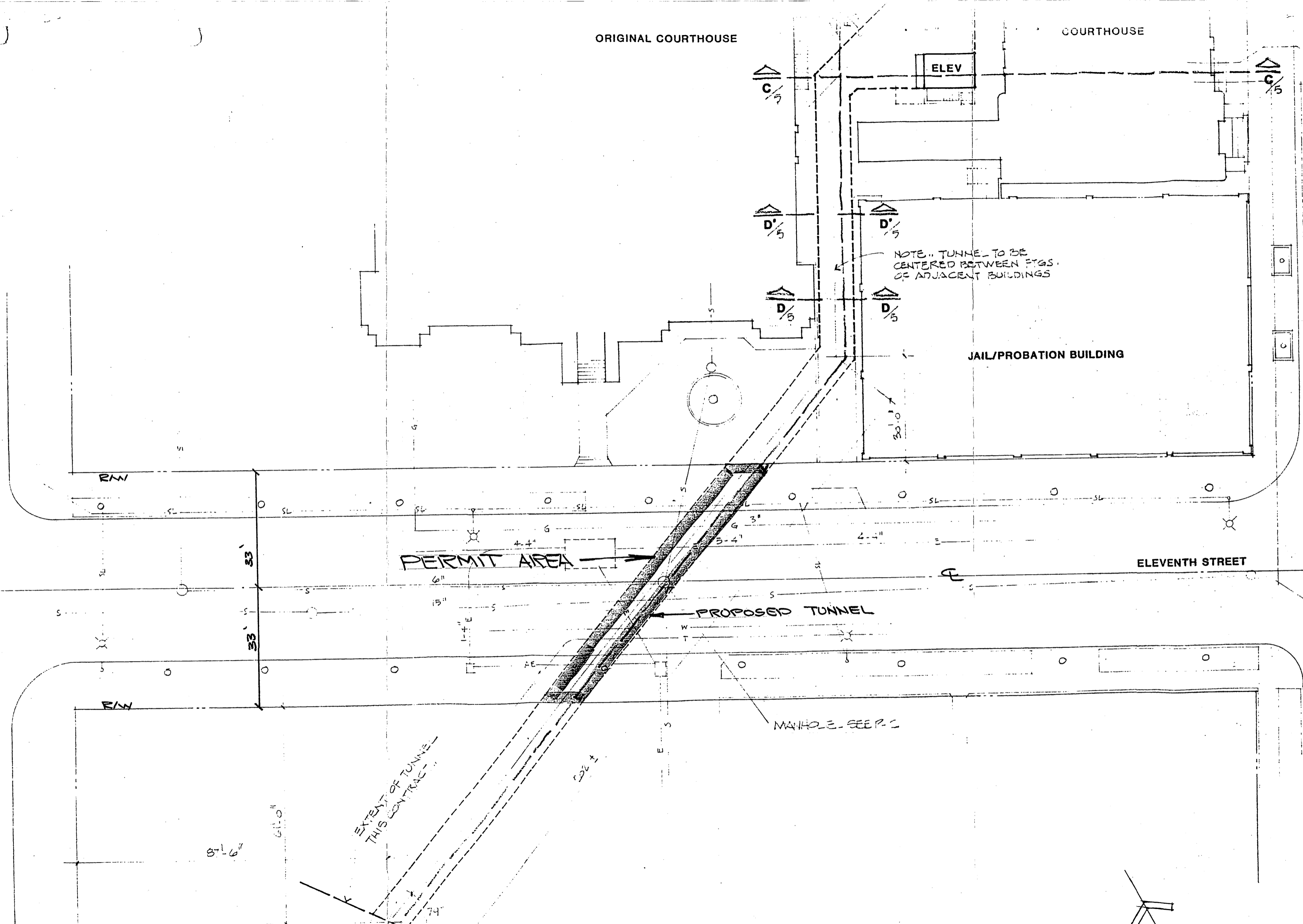
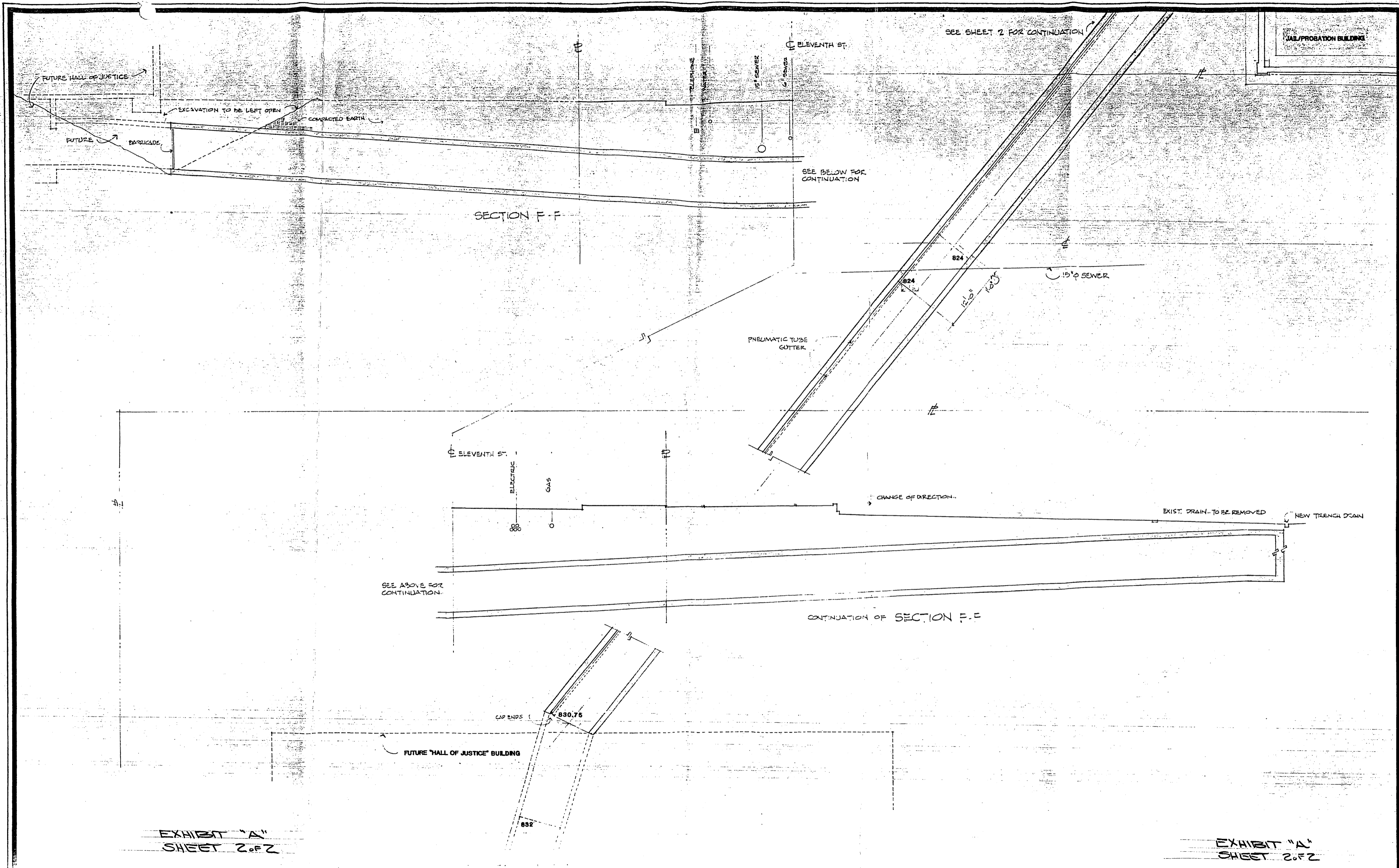

EXHIBIT 'A'
SHEET 1 OF 2
E-1073





FUTURE HALL OF JUSTICE

EXCAVATION TO BE LEFT OPEN

COMPACTED EARTH

FUTURE BARRICADE

ELEVENTH ST.

SEE SHEET 2 FOR CONTINUATION

JAIL/PROBATION BUILDING

SEE BELOW FOR CONTINUATION

SECTION F-F

15" S.W.

PNEUMATIC TUBE GUTTER

ELEVENTH ST.

ELECTRIC

GAS

CHANGE OF DIRECTION

EXIST. DRAIN TO BE REMOVED

NEW TRENCH DRAIN

SEE ABOVE FOR CONTINUATION

CONTINUATION OF SECTION F-F

CAP ENDS

830.75

FUTURE "HALL OF JUSTICE" BUILDING

832

EXHIBIT "A"
SHEET 2 OF 2

EXHIBIT "A"
SHEET 2 OF 2