



ENCROACHMENT PERMIT
Ground Water Monitoring Well
City of Riverside - Public Works Dept.
951-826-5341

Issuance of this permit shall not be construed as a waiver of any other applicable permit or requirement, and is only revocable permission to use the land for the purpose described.

Owner: RESTRUCTURE PETROLEUM MARKETING SERVICES
Location: 6160 ARLINGTON AV RIVE
A.P.N.: 191-190-005

Encroachment: INSTALL THREE GROUND WATER MONITORING WELLS (EZ-12, 13, &14) IN THE PUBLIC RIGHT OF WAY PER THE ATTACHED EXHIBITS

The above-described encroachment being shown on Exhibit A attached hereto.

Upon issuance of this permit, I agree to comply with the attached terms and conditions.

Date: 9/6/2011

By: *[Signature]*

Date: _____

By: _____

Applicant
 RESTRUCTURE PETROLEUM MARKETING SERVICES

Contractor/Developer
 GEOENVIRO SERVICES INC

1101 MARBELLA PLAZA DRIVE
 TAMPA FL

5529 KAILAS ST
 VENTURA CA

33619

93003

813-636-8111 x100

805/642-1668

ENCROACHMENT PERMIT APPROVAL

This permit has been reviewed and approved by the Departments listed below provided the attached terms and conditions are adhered to:

P/W ENGINEERING
 P/W TRAFFIC
 P/U WATER

FINAL APPROVAL

Date: 8/31/11

[Signature]
 City Engineer

THIS PERMIT IS NOT VALID UNTIL ISSUED AND POSTED IN CITY RECORDS

Issued by: *[Signature]*

Dated by: 9/7/11



City of Riverside

The following are requirements that need to be met for your permit #PW11-0457 .

- 1: Permittee acknowledges that the area of encroachment is owned or controlled by the City of Riverside.
- 2: Permittee acknowledges that the described property could be needed for a proposed or planned public improvement and the City may revoke this permit. Upon written notice of revocation, the permittee shall, within the time prescribed by the City, remove all improvements placed, constructed or maintained. If the permittee fails to abide by the removal order of the City, the City shall have the right to remove and destroy the improvements without reimbursement to the permittee. The cost of such removal shall be paid by the permittee to the City and shall constitute a debt owed to the City.
- 3: Permittee waives the right of claim, loss, damage or action against the City resulting from revocation, termination, removal of improvements or any action of the City, its officers, agents or employees taken in accordance with the terms herein.
- 4: If the Public Works Director of the City of Riverside finds that the permittee is in default of the terms of this permit, that shall be cause for revocation.
- 5: Permittee herewith agrees to hold the City of Riverside harmless from and against all claims demands, costs, losses, damages, injuries, actions for damages and/or injuries, and liability in connection with the construction, encroachment, and/or maintenance to be done by permittee within the described property.
- 6: Prior to any construction taking place on City controlled property, permittee shall obtain a Construction Permit or Street Opening Permit from the City Public Works Department.
- 7: The permittee agrees to insure that construction of their improvements will not interfere in any way with any existing City or utility facilities.
- 8: Permittee acknowledges that existing city or utility facilities will require future maintenance, reconstruction, and revisions and that facilities may be added, any of which may result in removal or alteration of the permittee's improvements without reimbursement to the permittee.
- 9: Prior to construction, permittee shall contact Underground Service Alert to field locate existing utility lines. Any conflicts discovered will void the permit until acceptable revisions are made. It shall be Permittee's responsibility to determine the location and required clearances from all public and private utility, sewer and drainage facilities prior to drilling and shall only drill in compliance with such clearance requirements.
- 10: Permittee agrees to remove, close and abandon the well or wells in a timely manner, in accordance with the procedures specified under Condition 10m below. This permit may then be revised to apply to a new approved site.
10. Permittee shall obtain a well permit from the County of Riverside, Health Services Agency, Department of Environmental Health. A copy of the County permit shall be incorporated into this permit. County approval is required prior to issuance of this encroachment permit.
- 10a. Permittee shall use and occupy the described encroachment only in the manner and for the purposes as follows: To drill, maintain, monitor, remove and close test well(s) for the purpose of

E11-0457

Ground Water Monitoring.

10b. Permittee agrees to make the results of sampling available to the City.

10c. Permittee shall have the right of reasonable access across the City's adjacent right-of-way to drill, monitor, maintain, remove and close the well(s).

10d. Permittee shall inspect each well site at least once each month to insure that the lock is locked and not broken.

Well Construction

10e. The test well(s) shall be constructed as shown on the attached exhibits.

10f. Permittee's contractor shall obtain a Street Opening Permit from the City Public Works Department prior to doing any work in the public right-of-way.

10g. Permittee's contractor shall review required traffic control and safety measures for each site with the City's Traffic Engineering Division prior to doing any work in the public right-of-way. Permittee's contractor shall be responsible for implementing the required traffic control and safety measures as approved by the City Traffic Engineer.

10h. It shall be Permittee's responsibility to determine the location and required clearances from all public and private utility, sewer and drainage facilities prior to drilling and shall only drill in compliance with such clearance requirements.

10i. Permittee shall notify the City of Riverside, California, Public Works Department of the exact drilling date. In residential neighborhoods drilling will not commence prior to 8:30 am and will continue no later than one hour prior to sunset. In all other areas drilling will not commence prior to : m and continue no later than : m.

10j. During the period of well installation, Permittee's contractor shall keep the site supervised continuously from the beginning of drilling operations until installation of the locked traffic grade "Christy Box" cap marked "Monitor Well". Under no circumstances is the well or borehole to be left unattended when it is unlocked or incapable of being locked. Supervision after dusk includes appropriated lights to make the well visible to the attendants who shall remain awake and observant of the well or borehole.

10k. Upon completion of installation, Permittee shall provide to the City an as-built plan showing the exact location of the well(s).

Well Closure

10l. In the event the City needs the site prior to completion of monitoring, upon receipt of written notice to this effect from the City, the Permittee agrees to remove, close and abandon the well or wells in a timely manner, in accordance with the procedures specified under Condition 10m below. This permit may then be revised to apply to a new approved site.

10m. When the well(s) are no longer needed, the Permittee shall provide written notice to this effect to the City, and the well(s) shall be removed, closed and abandoned to the specifications of the Riverside Public Works Department and the State of California regulations regarding the closure of wells. Upon closure, Permittee shall provide to the City an as-built plan of the closed well(s).

10n. To insure that the removal and closure of the well(s) takes place in a timely manner, the Permittee shall post a cash deposit of \$1,000.00 per well. This cash deposit may be used by the City to remove and close the well(s) when not done by permittee. Any cost of closure in excess of the cash deposit shall be paid by Permittee to the City of Riverside and shall constitute a debt owed to the City of Riverside.

E11-0457

Well Monitoring

10o. Prior to periodic monitoring and ground water sampling Permittee must contact TRAFFIC ENGINEERING for review and approval of traffic control or lane closures. Traffic Engineering (951) 826-5366.

10p. Permittee must notify PUBLIC WORKS INSPECTION 48 hours in advance of the anticipated date and time of all ground water sampling requiring traffic control or lane closures. Refer to Street Opening Permit No. Public Works Inspection (951) 826-5341.

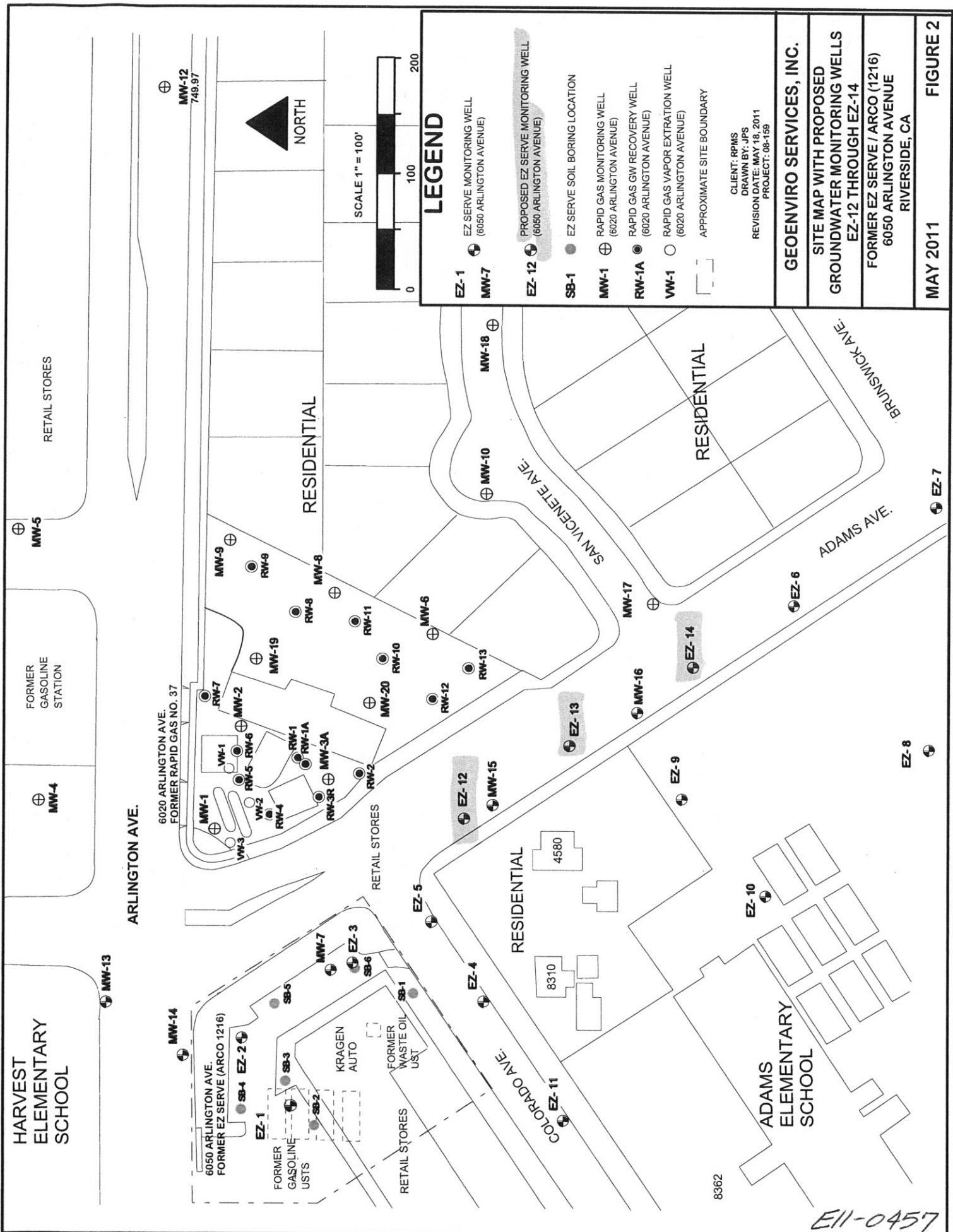

HARVEST
ELEMENTARY
SCHOOL

ADAMS
ELEMENTARY
SCHOOL

RESIDENTIAL

RESIDENTIAL

RETAIL STORES

FORMER
GASOLINE
STATION

FORMER
GASOLINE
USTS

KRAGEN
AUTO

FORMER
WASTE OIL
UST

ARLINGTON AVE.

COLORADO AVE.

SAN VICENTE AVE.

ADAMS AVE.

BRUNSWICK AVE.

6020 ARLINGTON AVE.
FORMER RAPID GAS NO. 37

6050 ARLINGTON AVE.
FORMER EZ SERVE (ARCO 1216)

MW-12
749.97

MW-14

EZ-1

SB-4

SB-3

SB-2

SB-1

MW-7

EZ-3

SB-6

EZ-5

EZ-4

MW-11

EZ-11

MW-10

EZ-12

MW-15

EZ-13

MW-16

EZ-14

MW-17

EZ-9

EZ-10

EZ-8

EZ-7

MW-18

MW-13

MW-9

RW-9

MW-8

RW-8

MW-19

RW-11

MW-20

RW-10

MW-6

RW-12

RW-13

MW-1

RW-7

MW-2

RW-5

RW-6

VW-2

VW-1

RW-1A

RW-1A

MW-3A

RW-3R

RW-2

MW-4

MW-5

MW-13

MW-14

MW-1

MW-2

MW-3

MW-4

MW-5

MW-6

MW-7

MW-8

MW-9

MW-10

MW-11

MW-12

MW-13

MW-14

MW-15

MW-16

MW-17

MW-18

MW-19

MW-20

MW-21

MW-22

MW-23

MW-24

MW-25

MW-26

MW-27

MW-28

MW-29

MW-30

MW-31

MW-32

MW-33

MW-34

MW-35

MW-36

MW-37

MW-38

MW-39

MW-40

MW-41

MW-42

MW-43

MW-44

MW-45

MW-46

MW-47

MW-48

MW-49

MW-50

MW-51

MW-52

MW-53

MW-54

MW-55

MW-56

MW-57

MW-58

MW-59

MW-60

MW-61

MW-62

MW-63

MW-64

MW-65

MW-66

MW-67

MW-68

MW-69

MW-70

MW-71

MW-72

MW-73

MW-74

MW-75

MW-76

MW-77

MW-78

MW-79

MW-80

MW-81

MW-82

MW-83

MW-84

MW-85

MW-86

MW-87

MW-88

MW-89

MW-90

MW-91

MW-92

MW-93

MW-94

MW-95

MW-96

MW-97

MW-98

MW-99

MW-100

MW-101

MW-102

MW-103

MW-104

MW-105

MW-106

MW-107

MW-108

MW-109

MW-110

MW-111

MW-112

MW-113

MW-114

MW-115

MW-116

MW-117

MW-118

MW-119

MW-120

MW-121

MW-122

MW-123

MW-124

MW-125

MW-126

MW-127

MW-128

MW-129

MW-130

MW-131

MW-132

MW-133

MW-134

MW-135

MW-136

MW-137

MW-138

MW-139

MW-140

MW-141

MW-142

MW-143

MW-144

MW-145

MW-146

MW-147

MW-148

MW-149

MW-150

MW-151

MW-152

MW-153

MW-154

MW-155

MW-156

MW-157

MW-158

MW-159

MW-160

MW-161

MW-162

MW-163

MW-164

MW-165

MW-166

MW-167

MW-168

MW-169

MW-170

MW-171

MW-172

MW-173

MW-174

MW-175

MW-176

MW-177

MW-178

MW-179

MW-180

MW-181

MW-182

MW-183

MW-184

MW-185

MW-186

MW-187

MW-188

MW-189

MW-190

MW-191

MW-192

MW-193

MW-194

MW-195

MW-196

MW-197

MW-198

MW-199

MW-200

MW-201

MW-202

MW-203

MW-204

MW-205

MW-206