

ENCROACHMENT PERMIT

Pursuant to Resolution No. 11065 of the City of Riverside, permission is hereby granted to WESTERN MUNICIPAL WATER DISTRICT  
450 Alessandro Boulevard  
Riverside, CA 92506

its heirs and assigns, hereinafter referred to as "Permittee" to use and occupy the following described property.

Those portions of public street right of way and public utility easements lying within Section 10, Township 3 South, Range 4 West, S.B.M., as shown on the attached Exhibit "A",

in accordance with the terms hereof.

1. Permittee shall use and occupy the described property only in the manner and for the purposes as follows: for construction and maintenance of a waterline encroaching into said public street right of way and public utility easements, as shown on the attached Exhibit "A".

1a. Permittee shall obtain a street opening permit from the Public Works Department prior to construction.

2. Permittee, by acceptance of the benefits hereunder, acknowledges title to the property to be in the City of Riverside and waives any right to contest the validity of the dedication or grant.

3. Permittee acknowledges that the described property is the site of a proposed or planned public improvement and that, accordingly, all rights and privileges of use permitted shall cease and expire upon notice of revocation by the City. Upon the expiration or revocation, Permittee shall, within the time prescribed by the City, remove all improvements or obstructions placed, constructed or maintained by the Permittee. If the Permittee fails to abide by the removal order of the City within the time prescribed, the City shall have the right to remove and destroy the improvements without reimbursement to the Permittee and the cost of such removal shall be paid by the Permittee to the City of Riverside and shall constitute a debt owed to the City of Riverside.

4. Permittee, by acceptance hereof, waives the right of claim, loss, damage or action against the City of Riverside arising out of or resulting from revocation, termination, removal of the improvements or any action of the City of Riverside, its officers, agents or employees taken in accordance with the terms hereof.

5. Finding and determination by the City Council of the City of Riverside that the Permittee, or his heirs and assigns or successors in interest, are in default of the terms hereunder shall be cause for revocation.

6. Permittee herewith agrees to hold the City of Riverside harmless from and against all claims, demands, costs, losses, damages, injuries, action for damages and/or injuries, and liability growing or arising out of or in connection with the construction, encroachment, and/or maintenance to be done by Permittee or his agents, employees or contractors within the described property.

DATED: March 19, 1991 CITY OF RIVERSIDE, a municipal corporation

By Terry Frenzel Mayor

Attest Karen E. Lindquist City Clerk

The foregoing is accepted by:

[Signature]  
(Signature(s) of Permittee)

APPROVED AS TO CONTENT

[Signature]  
Department Head - Public Works

[Signature] <sup>BWS</sup>  
Department Head - Public Utilities

APPROVED AS TO FORM

[Signature]  
City Attorney

CITY MANAGER APPROVAL

[Signature]  
City Manager

SHEET 2 OF 5

BOX SPRINGS BLVD.

SHEET 3 OF 5

(EASTRIDGE AVE.)

EUCALYPTUS AVE.

CITY OF RIVERSIDE  
COUNTY OF RIVERSIDE



COTTONWOOD AVENUE

SHEET 4 OF 5

R.R.  
PROPOSED REALIGNED  
I-215 FREEWAY  
A.T. & S.F.

CITY OF RIVERSIDE  
COUNTY OF RIVERSIDE

SYCAMORE CANYON  
BLVD.

SHEET 5 OF 5

CITY OF RIVERSIDE  
COUNTY OF RIVERSIDE

ALESSANDRO BLVD.

WEST  
FRONTAGE RD.

EXHIBIT "A"  
SHEET 1 OF 5

E-1172

10+00

11+00

11+00

12+00

13

9+ VP

10+ 10+

10+8 HPI V

10+ 4" B

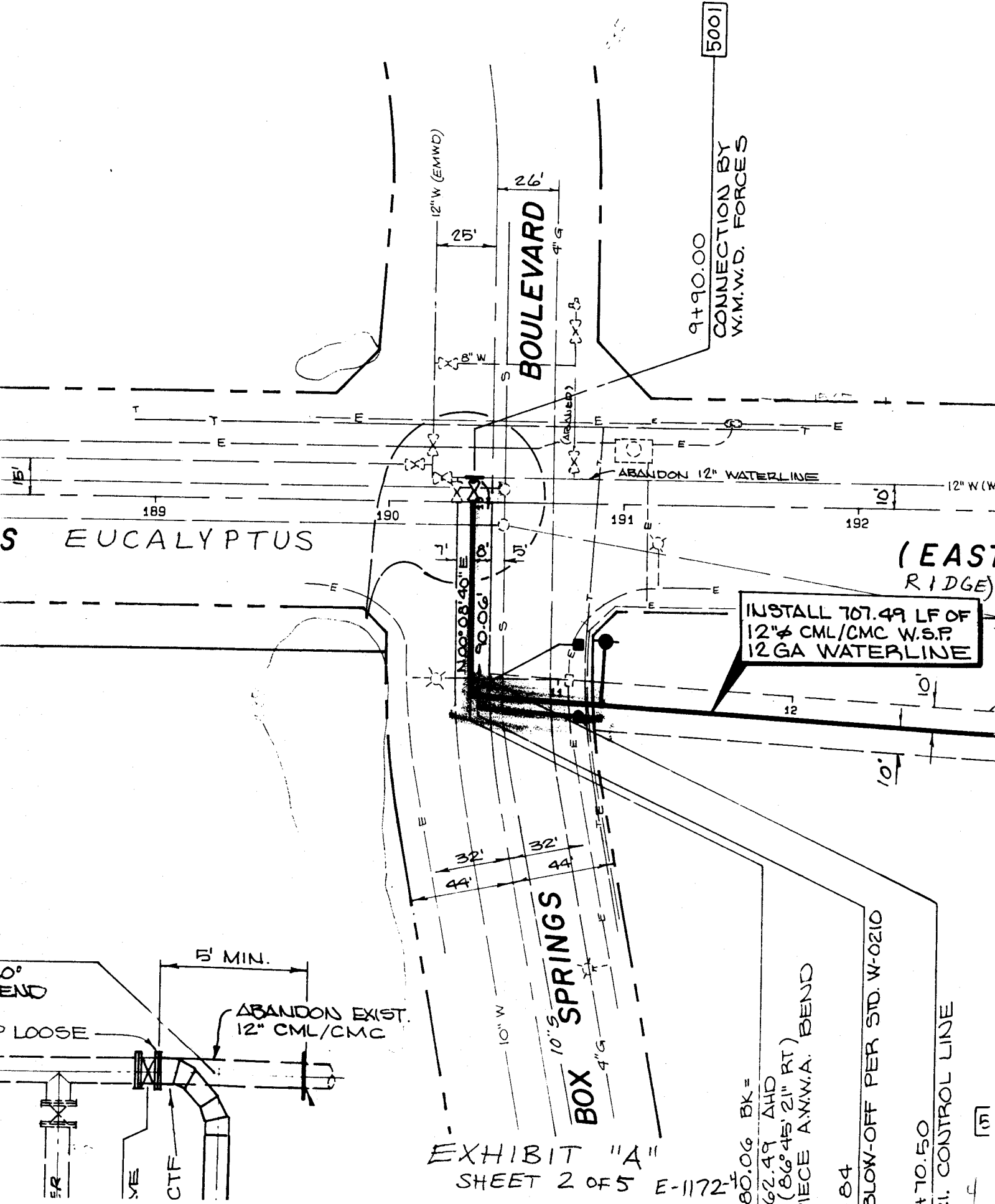

BOULEVARD

CONNECTION BY W.M.W.D. FORCES

S EUCALYPTUS

(EAST RIDGE)

INSTALL 707.49 LF OF 12" CML/CMC W.S.P. 12 GA WATERLINE

BOX 10" S SPRINGS

EXHIBIT "A" SHEET 2 OF 5 E-1172-4

80.06 BK = 62.49 AHD (86°45'21" RT) 1" ECE A.W.W.A. BEND

84 SLOW-OFF PER STD. W-0210 470.50 2% CONTROL LINE

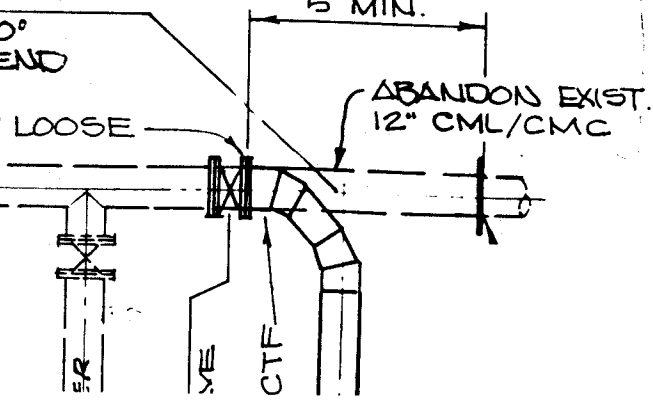

90° BEND

LOOSE

CTF

ABANDON EXIST. 12" CML/CMC

5' MIN.

10" W

10" S

4" G

12" W (EMWD)

26'

25'

4" G

8" W

8" W

ABANDON 12" WATERLINE

9+90.00

5001

189

190

191

192

12" W (W)

100°08'40" E 90.06' 10"

32'

32'

44'

44'

12

10'

10'

10'

107

20 24+00 25+00 26+00 27+00

EXISTING AT & SF RR

PROPOSED I-2

(ABAND) 6" FUEL 12" STEEL WATERLINE TO BE ABANDONE

5°04'57"25" E  
216.33'

EXISTING BLOCK WALL  
TO BE REMOVED IN  
AREA OF EASEMENT

20' P.U.E.

24+14.29 BK =  
24+14.38 AHD.  
BC/HPI  
N81°59'18" E (R)

EXHIBIT "A"  
SHEET 3 OF 5

E-1172-5

CURVE D			
	Δ	R	

45+00

15+00

46+00

47+00

45+48.25 BK<sup>2</sup> (PIPE)  
45+84.53 AND (CONTROL)

HPT (90° RT)  
5 PIECE ANWA BEND  
45" RAD.

9 LF OF  
10 W/12  
PER LINE

PER W0500

5'x20'  
PUE

47+60.81

18" FLGD. TEE W/18" FLGD  
B/FV & 2" AV PER STD W-0470  
12" FLGD. SO. W/12" FLGD. B/FV  
(SEE CONNECTION DETAIL  
AT RIGHT)

N0°33'03"E

CONTROL LINE

45+76.80  
A.B. CONTROL

40' COIL OF  
6 PR PBC

EXISTING 12" WATERLINE  
TO REMAIN IN SERVICE

30" LF GAS

SEC 10

N 89° 52' 03" W

COTTONWOOD

EXIST. RR RW

ION  
PRESSURE  
S LINE  
CAL. GAS CO.  
48HR. PRIOR  
XCAVATING

15'  
7.5'

EXHIBIT "A"

SHEET 4 OF 5

E-1172-6

42+25  
VPI = ( )  
2" AIR VALVE  
STD W

43+98  
H.P.I. = ( )

44+11  
E 12" FL

44+02  
JOIN E

43+00

44+00

45+00

- 12" DIA S.B.S.J. PER STD. W-0440
- 12" DIA CML/CMC WSP 12 GA AWWA TEE
- ADD 12" CTF
- 12" DIA. SLIP ON FLANGE (150#) (SHIP LOOSE) ADD 12" C.T.F.
- 12" FLANGED RS GATE VALVE
- 12" DIA. SLIP ON FLANGE (150#) SHIP LOOSE
- EXIST. 12" CML/CMC TO REMAIN IN SERVICE

DETAIL 4-A

INSTALL 920.93 LF OF 12" DIA CML/CMC W.S.P. 2 GA WATERLINE

ST. STRUCTURES BE REMOVED

42+25  
2" AIR VALVE PER STD. W-0470

44+02.48  
JOIN EXIST 12" WATERLINE (SEE DETAIL 4-A THIS SHEET)

43+89.48  
ALESSANDRO R/W

44+39.48

ALESSANDRO CONTROL LINE = (NO. 63-264)

BOULEVARD

ALESSANDRO

STREET &

SECTION LINE

16" FUEL

16" FUEL

R/W

R/W

EXHIBIT "A"  
SHEET 5 OF 5

E-1172-7

