

APPLICATION FOR ENCROACHMENT PERMIT
(to be completed by applicant)

I, MIKE KUPLAST am the Owner Lessee of the property located at 7167 BRADFORD ST. in the City of Riverside, Assessors Parcel No. 155-464-007. I hereby request permission to CONSTRUCTION AND MAINTENANCE OF A 4' HIGH WROUGHT IRON AND PILASTER FENCE

in the public right of way of BRADFORD STREET /or the _____ easement at the rear/ side/ front of said property. The attached drawing shows the requested encroachment. Upon issuance of this permit, I agree to comply with the terms and conditions on the attached Exhibit A.

Date 6-3-91

M. Kuplast

.....
ENCROACHMENT PERMIT APPROVAL
(to be completed by City)

This permit shall become effective upon the approval of the Departments listed below. Issuance of this permit shall not be construed as a waiver of any other applicable permit or requirement, but is only revocable permission to use the land for the purpose described.

- Public Utilities Water Kenneth G. Anderson
- Public Utilities Electric Wm W. Kuttler
- Planning Kyler Jones
- Parks and Recreation _____
- (other) _____
- (other) _____

Upon obtaining the above signatures, return this permit to the Public Works Department for final approval.

Barry Bell 6/3/91
Public Works Director

Encroachment Permit No. E-1179

TERMS AND CONDITIONS

The following indicated terms and conditions apply to encroachment permit no. E-1179

1. Permittee acknowledges that the area of encroachment is owned or controlled by the City of Riverside.
2. Permittee acknowledges that the described property could be needed for a proposed or planned public improvement and the City may revoke this permit. Upon written notice of revocation, the permittee shall, within the time prescribed by the City, remove all improvements placed, constructed or maintained. If the permittee fails to abide by the removal order of the City, the City shall have the right to remove and destroy the improvements without reimbursement to the permittee. The cost of such removal shall be paid by the permittee to the City and shall constitute a debt owed to the City.
3. Permittee waives the right of claim, loss, damage or action against the City resulting from revocation, termination, removal of improvements or any action of the City, its officers, agents or employees taken in accordance with the terms herein.
4. If the City Council of the City of Riverside finds that the permittee is in default of the terms of this permit, that shall be cause for revocation.
5. Permittee herewith agrees to hold the City of Riverside harmless from and against all claims demands, costs, losses, damages, injuries, actions for damages and/or injuries, and liability in connection with the construction, encroachment, and/or maintenance to be done by permittee within the described property.
6. Prior to any construction taking place on City controlled property, permittee shall obtain a "Construction Permit" from the City Public Works Department.
7. The permittee agrees to insure that construction of their improvements will not interfere in any way with existing City or utility facilities. The existing facilities will require future maintenance, reconstruction and revisions and facilities may be added, any of which may result in removal or alteration of the permittee's improvements without

reimbursement to the permittee. Prior to construction, Permittee shall contact Underground Service Alert to field locate existing utility lines. Any conflicts discovered will void the permit until acceptable revisions are made.

8. X Other FOUNDATIONS SHALL NOT
BE DEEPER THAN TWO FEET
BELOW GRADE!

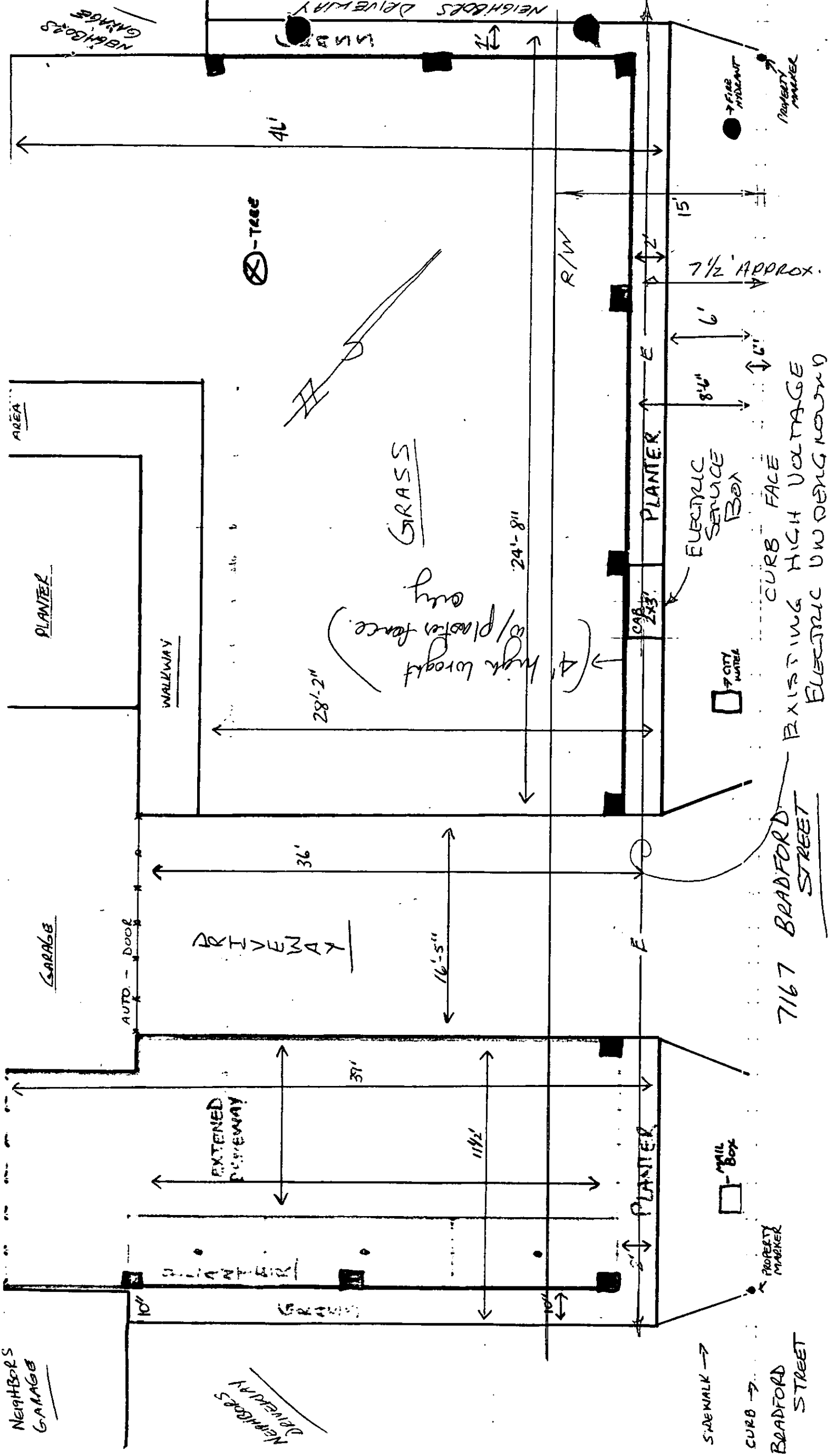

NEIGHBORS GARAGE

AREA

PLANTER

GARAGE

EXTENDED DRIVEWAY

GRASS

NEIGHBORS DRIVEWAY

WALKWAY

DRIVEWAY

T-Tree

GRASS

(4' high wrought iron planter fence)

R/W

PLANTER

E

PLANTER

E

CURB

SIDEWALK →

CURB →

BRADFORD STREET

MAIL BOX

PROPERTY MARKER

ELECTRIC SERVICE BOX

CITY WATER

CURB FACE

EXISTING HIGH VOLTAGE ELECTRIC UNDERGROUND

7 1/2' APPROX.

6'

8 1/2'

15'

2'

2'

6"

6"

2'

2'

2'

2'

2'

2'

2'

2'

2'

2'

2'

2'

2'

2'

2'

2'

2'

2'

2'

2'

2'

2'

2'

2'

FIRE HYDRANT

PROPERTY MARKER

46'

24'-8"

28'-2"

36'

16'-5"

39'

11 1/2'

10'

10'

10'

10'

10'

10'

10'

10'

10'

10'

10'

10'

10'

10'

10'

NEIGHBORS DRIVEWAY

NEIGHBORS DRIVEWAY

NEIGHBORS DRIVEWAY

NEIGHBORS DRIVEWAY

NEIGHBORS DRIVEWAY

NEIGHBORS DRIVEWAY

NEIGHBORS DRIVEWAY

NEIGHBORS DRIVEWAY

NEIGHBORS DRIVEWAY

NEIGHBORS DRIVEWAY

NEIGHBORS DRIVEWAY

NEIGHBORS DRIVEWAY

NEIGHBORS DRIVEWAY

NEIGHBORS DRIVEWAY

NEIGHBORS DRIVEWAY

NEIGHBORS DRIVEWAY

NEIGHBORS DRIVEWAY

NEIGHBORS DRIVEWAY

NEIGHBORS DRIVEWAY

NEIGHBORS DRIVEWAY

NEIGHBORS DRIVEWAY

NEIGHBORS DRIVEWAY

NEIGHBORS DRIVEWAY

NEIGHBORS DRIVEWAY

NEIGHBORS DRIVEWAY

NEIGHBORS DRIVEWAY

NEIGHBORS DRIVEWAY

NEIGHBORS DRIVEWAY

NEIGHBORS DRIVEWAY

NEIGHBORS DRIVEWAY

NEIGHBORS DRIVEWAY

NEIGHBORS DRIVEWAY

NEIGHBORS DRIVEWAY

NEIGHBORS DRIVEWAY

NEIGHBORS DRIVEWAY

NEIGHBORS DRIVEWAY

NEIGHBORS DRIVEWAY

NEIGHBORS DRIVEWAY

NEIGHBORS DRIVEWAY

NEIGHBORS DRIVEWAY

NEIGHBORS DRIVEWAY

NEIGHBORS DRIVEWAY

NEIGHBORS DRIVEWAY

NEIGHBORS DRIVEWAY

NEIGHBORS DRIVEWAY

NEIGHBORS DRIVEWAY

NEIGHBORS DRIVEWAY

NEIGHBORS DRIVEWAY

NEIGHBORS DRIVEWAY

NEIGHBORS DRIVEWAY

7167 BRADFORD STREET